

Contents



Meter Mounting Equipment	01-07
M -100R Series Meter Socket	02
M -100S Series Meter Socket	03
M -125S Series Meter Socket	04
M -200 Series Meter Socket	05
M -20/320 Series Meter Socket	06
Meter Socket Fitting	07



Meter Mounting Equipment

Quality is the kernel concept of enterprise, our company put such concept into each procedure in enterprise administration, execute it as promised.

Meter Mounting Equipment

Quality is the kernel concept of enterprise, our company put such concept into each procedure in enterprise administration, execute it as promised.

M-100R Series Meter Socket



M-100R-D



M-100R-E



Features:

100A, 120/240V AC, Single phase, 2 or 3 wires,
Line and load lugs: 1/0 Max, Cu-Al
Conforms to ANSI 12.7
Mounting: Surface, pole outdoor.
Locking: Sealing ring has lock provision.

Housing:

Die cast Aluminum electrostatically applied epoxy baked gray powder finished.
Round type base.
NEMA 3R Rating for outdoor use.

Specification:

Product Number	Description	Fixed Hubs Size
M-100R-B	1Phase, 100A, 120/240Vac, 4 jaw	1/2"
M-100R-C	1Phase, 100A, 120/240Vac, 4 jaw	3/4"
M-100R-D	1Phase, 100A, 120/240Vac, 4 jaw	1"
M-100R-E	1Phase, 100A, 120/240Vac, 4 jaw	1-1/4"

Dimensions:

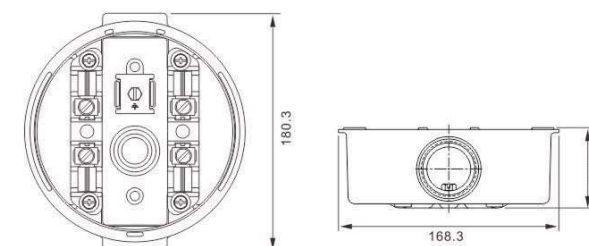

Stainless Steel Sealing Ring

Product Number	Description	Thickness
MR-01	Stainless steel snap type	0.35mm
MR-02	Stainless steel screw type	0.35mm
MR-03	Stainless steel belt type	0.35mm
MR-04	Steel Screw type	1.5mm

Meter Mounting Equipment

Quality is the kernel concept of enterprise, our company put such concept into each procedure in enterprise administration, execute it as promised.

M-100S Series Meter Socket

Features:

100A/125A, 600V max, Single phase, 2 or 3 wires
Conform to ANSI 12.7
Heavy duty tinned copper jaw
NEMA 3R type construction 1.2mm thickness (#18 gauge) galvanized steel sheet.
Ample gutter space for easy wiring
The fixed hub size 1/2" to 2-1/2" for option

Specification:

Product Number	Description	Outline Dimensions		
		H	W	D
M-100S-4J-R-H	1 Phase, 100A, 4jaw, ring type	223	190	86
M-100S-4J-R	1 Phase, 100A, 4jaw, ring type	223	190	86
M-100S-4J-RL	1 Phase, 100A, 4jaw, ring type	223	190	86

Dimensions:

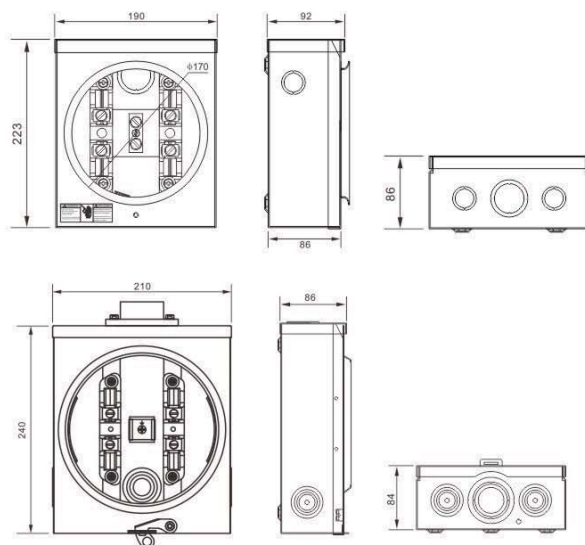

Meter Mounting Equipment

Quality is the kernel concept of enterprise, our company put such concept into each procedure in enterprise administration, execute it as promised.

M-125S Series Meter Socket

Features:

200Amps, 600V AC.
Connectors Line and load size #6-350 Cu-Al.
Heavy duty tinned copper jaw with reinforced clip.
C/W center neutral bar.
NEMA 3R type construction 1.2mm thickness (#18 gauge) or 1.5mm thickness (#16 gauge) galvanized steel sheet, electrostatically applied epoxy baked gray powder finished.
Ample gutter space for easy wiring.
Convenient knockouts in the side back and bottom.
Lay in type terminal with pressure plates for easy connections.
The fixed hub size 1/2" to 2-1/2" for option.

Specification:

Product Number	Description	Outline Dimensions		
		H	W	D
M-125-4J-R	1 Phase, 125A, 4jaw, ring type	396	203	108
M-125-5J-R	1 Phase, 125A, 5jaw, ring type	396	203	108
M-125-7J-R	3 Phase, 125A, 7jaw, ring type	396	203	108
M-125-4J-RL	1 Phase, 125A, 4jaw, ringless type	396	203	108
M-125-5J-RL	1 Phase, 125A, 5jaw, ringless type	396	203	108
M-125-7J-RL	3 Phase, 125A, 7jaw, ringless type	396	203	108
M-125B-4J-RL	1 Phase, 125A, 4jaw, ringless type	396	280	108

Dimensions:

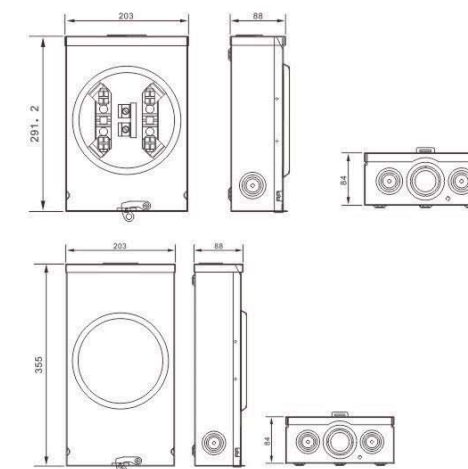

Meter Mounting Equipment

Quality is the kernel concept of enterprise, our company put such concept into each procedure in enterprise administration, execute it as promised.

M-200 Series Meter Socket

Features:

200Amps,600V AC.
Connectors Line and load size #6-350 Cu-Al.
Heavy duty tinned copper jaw with reinforced clip.
C/W center neutral bar.
NEMA 3R type construction 1.2mm thickness (#18 gauge) or 1.5mm thickness (#16 gauge) galvanized steel sheet, electrostatically applied epoxy baked gray powder finished.
Ample gutter space for easy wiring.
Convenient knockouts in the side back and bottom.
Lay in type terminal with pressure plates for easy connections.
The fixed hub size 1/2" to 2-1/2" for option.

Specification:

Product Number	Description	Outline Dimensions		
		H	W	D
M-200-4J-R	1 Phase, 200A, 4jaw, ring type	396	203	108
M-200-5J-R	1 Phase, 200A, 5jaw, ring type	396	203	108
M-200-7J-R	3 Phase, 200A, 7jaw, ring type	396	203	108
M-200-4J-RL	1 Phase, 200A, 4jaw, ringless type	396	203	108
M-200-5J-RL	1 Phase, 200A, 5jaw, ringless type	396	203	108
M-200-7J-RL	3 Phase, 200A, 7jaw, ringless type	396	203	108
M-200B-4J-RL	1 Phase, 200A, 4jaw, ringless type	396	280	108

Dimensions:

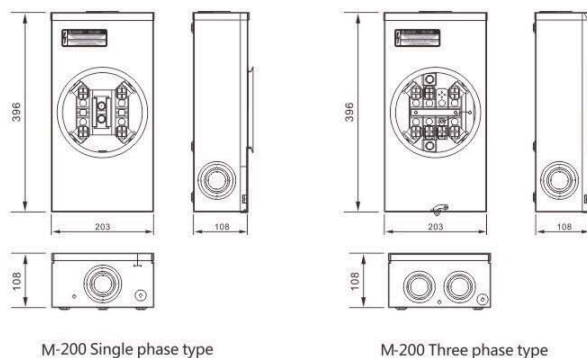

M-200 Single phase type

M-200 Three phase type

Meter Mounting Equipment

Quality is the kernel concept of enterprise, our company put such concept into each procedure in enterprise administration, execute it as promised.

M-20/M-320 Series Meter Socket

M-20 Series Meter Socket

Features:

20 AMP.
CURRENT TRANSFORMER RATED.
By pass: Plunger type bypass automatically closes when meter is removed.
NEMA 3R type construction 1.2mm thickness (#18 gauge) or 1.5mm thickness (#16 gauge) galvanized steel sheet (AISI G90), electrostatically applied epoxy baked gray powder finished.
Ample gutter space for easy wiring.
Convenient knockouts in the side back and bottom.
The fixed hub size 1/2" to 2-1/2" for option.

Specification:

Product Number	Description	Outline Dimensions		
		H	W	D
M-20-13J-RL	1 Phase, 20A, 13 Terminal, ringless type	355	203	84
M-20-6J-RL	1 Phase, 20A, 6 Terminal, ringless type	355	203	84

M-320 Series Meter Socket

Features:

320Amps,600VAC,4Terminals,single phase,3 wire,ringless type.
NEMA 3R type construction 1.5mm thickness (#16 gauge) galvanized steel sheet (AISI G90), electrostatically applied epoxy baked gray powder finished.
Heavy duty lever bypass.
Heavy duty tin plated copper jaw.
OVERHEAD / UNDERGROUND.
Convenient knockouts in the side back and bottom.
The fixed hub size 2" to 2-1/2" for option.

Specification:

Product Number	Description	Outline Dimensions		
		H	W	D
M-320-4J-RL	1 Phase, 320A, 4jaw, ringless type	716	332	132

Dimensions:

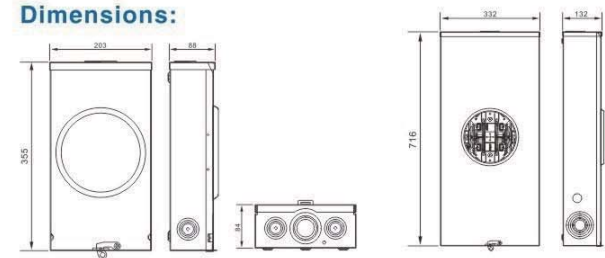

M-20 Series

M-320 Series



M-20-13J-RL



M-20-6J-RL



M-320-4J-RL



M-200-4J-R



M-200-7J-RL



M-200B-4J-RL

Load Centers & Modular Enclosures

Meter Socket Fitting

Quality is the kernel concept of enterprise, our company put such concept into each procedure in enterprise administration, execute it as promised.



100A

Use on
M-100R
M-100S



125A

M-125-4J-RL
M-125-5J-RL



200A

M-200-4J-RL
M-200-4J-R



200A

Use on
M-200-7J
M-200-7J-R



20A

M-20-6J-RL



20A

M-20-13J-RL



320A

Use on
M-320-4J-RL



Hub

1" 1-1/4" 1-1/2"
2" 2-1/2"



Lock

M-200 Series