



www.mebamfg.com

# Miniature Circuit Breaker

## BH Miniature Circuit Breaker

### Features and Applications:

BH series miniature circuit breaker is characteristic of small size, lightweight, novel structure and excellent performance. They are mounted in the illuminating distribution board and used in guest houses, block of flats, high buildings, squares, airports, railway stations, plants and enterprises etc. in AC circuits 240V (single pole) up to 415V (3 pole) 50Hz for protection of overload short circuit and for circuit change-over in lighting system. Breaking capacity is 3KA. The items comply with IEC60898 standard.

### Technical parameter:

Number of Poles	1P, 2P, 3P
Rated Current (A)	6, 10, 15, 20, 25, 30, 40, 50, 63, 70, 80, 90, 100
Rated Voltage(V)	110/220 (1P), 240/415 (2P), 415 (3P)
Breaking Capacity(A)	3000
Electrical Life(Times)	6000
Mechanical Life(Times)	16000

### Dimension(mm):

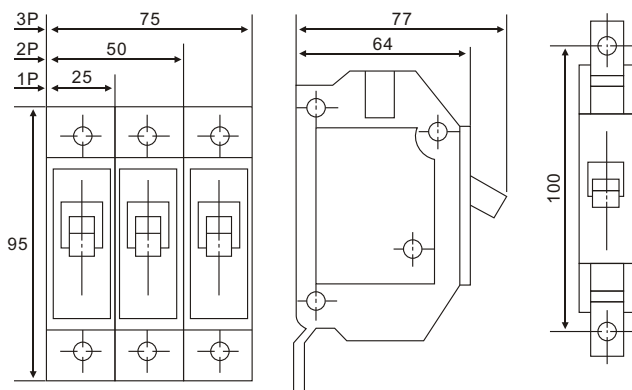

## BH-P Miniature Circuit Breaker

### Applications:

BH-P series miniature circuit breaker applies to industrial, commercial, lighting and electric machine distribution system with AC415V, 50/60Hz, rated working current up to 100A to protect against overload and short circuit. The item is installed into plug-in type mounting base.

### Technical parameter:

Number of Poles	1P, 2P, 3P
Rated Current (A)	6, 10, 15, 20, 25, 30, 40, 50, 63, 70, 80, 90, 100
Rated Voltage(V)	110/220 (1P), 240/415 (2P), 415 (3P)
Breaking Capacity(A)	3000
Electrical Life(Times)	6000
Mechanical Life(Times)	16000

### Dimension(mm):

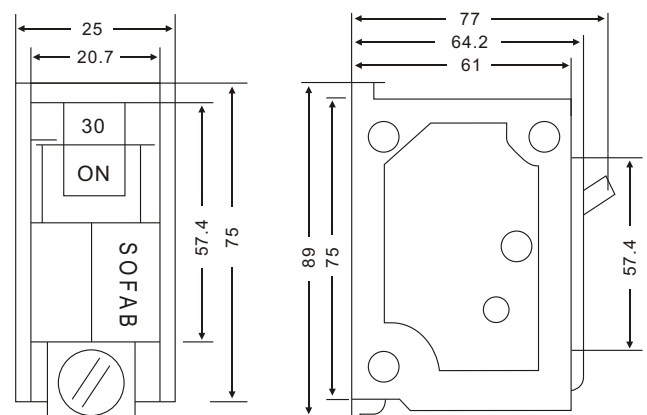

# Miniature Circuit Breaker



MEBA ELECTRIC  
ENTERPRISES.

## MBGLD4/MBGLD4A Miniature Circuit Breaker

### Specification needs:

Product Details	Manufacturer: Meba ElectricEnterprises				
	Country of Origin: China				
	Brand: Meba				
	Model: MBGLD4/ MBGLD4A				
Manufacturing Standards	IEC 60898 IEC60947				
Tropicalization	Relative Humidity	℃	93% RH at25℃	50% RH at40℃	
	Room Temperature	℃	-5℃ a 40℃		
Electrical Properties	Rated at 40℃	A	6/10/16/20/25/32/40/50/63		
	Rated operating voltage at 40℃	Vac	240/415		
	Nominal Frequency	Hz	50/60		
	Interrupting Capacity at 230V	kA	6		
	Operating temperature	℃	-5℃ a 40℃		
	Degree of Protection		IP20		
	Number of poles		1/2/3/4		
	Conductor cross section (minimum allowable)	mm <sup>2</sup>	25		
	Minimum number of power moves		4000		
	Minimum number of mechanical operations		8000		
	Operation curve		B/C/D		
	Current Trip Curve	A	Type B: 3 a 5 In	Type C: 5 a 10 In	Type D: 10 a 14 In
	Characteristic Intervention		attach		
Type of Assembly	FOR RIEL DIN 35 mm				
Features	MAGNETIC COIL: ensures the switching of short-circuit, speaking within the following ranges: 5 to 10 times rated current ( Type C ), 3 to 5 times rated current ( Type B ), 10 to 14 times rated current ( Type D )				
	BIMETAL: ensures the breaker trip when overloaded.				
	ARC CHAMBER: effectively dissipates the electric arc that is generated by the opening contacts of the trigger mechanism in the presence of an overload or short circuit.				
Present Certificates	CE CB				
	ISO 9001-2000 awarded by the competent certification body, Meba is qualified in the manufacturing of the object				
	IEC 60898 standards in the manufacture of the goods				
	Curve compliance issued Shot by an accredited laboratory for effect				
	Life, given by Meba to ensure that the life of the goods offered by at least 15 years.				
Testing For Acceptance	Before receiving the circuit breakers (breakers), customers may perform the tests maybe necessary to ensure compliance with the technical specifications.				
Packing	The packaging is sure that withstand any adverse conditions during transport and handling to the warehouse of customers				
Dial Century, Year, Month and Batch	In one of its sides the breaker is marked with permanent ink, year, month and batch.				
Catalog	Attach catalogs indicating the technical specification				
Shows	Submit sample of the product offered				
Technical Warranty	2 YEARS				
Place of Delivery	FOB & CNF				
Delivery	25 Days				



www.mebamfg.com

## Miniature Circuit Breaker

### MBBH Miniature Circuit Breaker

#### Applications:

MBBH series miniature circuit breaker, major export to South America, Middle East market, has light weight, small size, novel structure and excellent performance. They are mounted in the metal distribution board and used in guesthouses, block of flats, high buildings, squares, airports, railway stations, plants and enterprises etc, in AC circuits 240V(single pole) up to 415V(3pole) 50Hz for protection of overload short circuit and for circuit changeover in lighting system. Breaking capacity is 3KA. The items comply with BS & NEMA STANDARD.

#### Specification needs:

Product Details	Manufacturer: Meba ElectricEnterprises				
	Country of Origin: China				
	Brand: Meba				
	Model: MBBH				
Manufacturing Standards	IEC60947				
Tropicalization	Relative Humidity	℃	93% RH at25℃		
	Room Temperature	℃	10℃ a 60℃		
Electrical Properties	Rated at 40℃	A	6/10/15/20/30/40/50/60		
	Rated operating voltage at 40℃	Vac	120/240/415		
	Nominal Frequency	Hz	50/60		
	Interrupting Capacity at230V	kA	3		
	Operating temperature	℃	-5℃ a +40℃		
	Degree of Protection		IP20		
	Number of poles		1, 2, 3, 4		
	Conductor cross section (minimum allowable)	mm <sup>2</sup>	25		
	Minimum number of power moves		4000		
	Minimum number of mechanical operations		6000		
	Operation curve		B/C/D		
	Current Trip Curve	A	Type B 3 a 5 In	Type C 5 a 10 In	Type D 10 a 14 In
	Characteristic Intervention		attach		
Type of Assembly	NEMA Type				
Features	MAGNETIC COIL: ensures the switching of short-circuit, speaking within the following ranges: 5 to 10 times rated current (Type C), 10 to 14 times rated current (Type D)				
	BIMETAL: ensures the breaker trip when overloaded.				
	ARC CHAMBER: effectively dissipates the electric arc that is generated by the opening contacts of the trigger mechanism in the presence of an overload or short circuit.				
Present Certificates	CE				
	ISO 9001-2000 awarded by the competent certification body, Meba is qualified in the manufacturing of the object				
	IEC 60947 standards in the manufacture of the goods				
	Curve compliance issued Shot by an accredited laboratory for effect				
Testing For Acceptance	Life, given by Meba to ensure that the life of the goods offered by at least 15 years.				
	Before receiving the circuit breakers (breakers), customers may perform the tests maybe necessary to ensure compliance with the technical specifications.				
Packing	The packaging is sure that withstand any adverse conditions during transport and handling to the warehouse of customers				
Dial Century, Year, Month and Batch	In one of its sides the breaker is marked with permanent ink, year, month and batch.				
Catalog	Attach catalogs indicating the technical specification				
Shows	Submit sample of the product offered				
Technical Warranty	2 YEARS				
Place of Delivery	FOB & CNF				
Delivery	25 Days				

# Miniature Circuit Breaker



MEBA ELECTRIC  
ENTERPRISES.

## MABD Miniature Circuit Breaker

### Specification needs:

Product Details	Manufacturer: Meba ElectricEnterprises		
	Country of Origin: china		
	Brand: meba		
	Model: MABD		
Manufacturing Standards	IEC 60898 IEC60947-2		
Tropicalization	Relative Humidity	°C	93% RH at25°C
	Room Temperature	°C	10°C a 60°C
Electrical Properties	Rated at 40°C	A	6110/6/20/25/32/40/50/63
	Rated operating voltage at 40°C	Vac	120/240/415
	Nominal Frequency	Hz	50/60
	Interrupting Capacity at 230 V	kA	6
	Operating temperature	°C	40
	Degree of Protection		IP20
	Number of poles		1/2/3/4
	Conductor cross section (minimum allowable)	mm <sup>2</sup>	25
	Minimum number of power moves		4000
	Minimum number of mechanical operations		8000
	Operation curve		B/C/D
	Current Trip Curve	A	5 a 10 In
	Characteristic Intervention		attach
Type of Assembly	NEMA TYPE		
Features	MAGNETIC COIL: ensures the switching of short-circuit, speaking within the following ranges: 5 to 10 times rated current (Type C).		
	BIMETAL: ensures the breaker trip when overloaded.		
	ARC CHAMBER: effectively dissipates the electric arc that is generated by the opening contacts of the trigger mechanism in the presence of an overload or short circuit.		
Present Certificates	Semko CB		
	ISO9001-2000, awarded by the competent certification body, Meba is qualified in the manufacturing of the object		
	IEC 60898 standards awarded by an international certifying body.		
	Curve compliance issued Shot by an accredited laboratory for effect		
	Life, given by Meba to ensure that the life of the goods offered by at least 15 years.		
Testing For Acceptance	Before receiving the circuit breakers (breakers), customers may perform the tests may be necessary to ensure compliance with the technical specifications.		
Packing	The packaging is sure that withstand any adverse conditions during transport and handling to the warehouse of customers.		
Dial Century, Year, Month and Batch	In one of its sides the breaker is marked with the symbol permanent ink, year, month and batch.		
Catalog	Attach catalogs indicating the technical specifications		
Shows	Submit sample of the product offered		
Technical Warranty	2 YEARS		
Place of Delivery	CNF & FOB		
Delivery	25 DAYS		



www.mebamfg.com

## Miniature Circuit Breaker

### GV2-M10/GV2ME Miniature Circuit Breaker

#### Applications:

GV series motor protection circuit breaker are mainly used for the overload and short circuit protection of motors in AC50/60Hz, up to 660V, 0.1-80A power circuit, as a full-voltage starter to start and cut off the motors, under the AC3 load or for the overload and short circuit protection of the circuit and power equipment in the power in the power distribution network.

#### Technical parameter:

Type	Standard power ratings of 3-phase motors 50/60Hz in category AC-3						Setting range
	220V	380V	415V	440V	500V	660V	
	KW	KW	KW	KW	KW	KW	
GV1-M01	--	--	--	--	--	--	0.1-0.16
GV1-M02	--	--	--	--	--	--	0.16-0.25
GV1-M03	--	--	--	--	--	--	0.25-0.4
GV1-M04	--	--	--	--	--	0.37	0.4-0.63
GV1-M05	--	--	--	0.37	0.37	0.55	0.63-1
GV1-M06	--	0.37	--	0.55	0.75	1.1	1-1.6
GV1-M07	0.37	0.75	1.1	1.1	1.1	1.5	1.6-2.5
GV1-M08	0.75	1.5	1.5	1.5	2.2	3	2.5-4
GV1-M10	1.1	2.2	2.2	3	3.7	4	4-6
GV1-M14	2.2	4	4	4	5.5	7.5	6-10
GV1-M20	4	7.5	7.5	7.5	10	11	10-16
GV1-M21	5.5	10	9	9	11	15	16-20
GV1-M22	5.5	11	11	11	15	18.5	20-25
GV2-M01/RS01	--	--	--	--	--	--	0.1-0.16
GV2-M02/RS02	--	--	--	--	--	--	0.16-0.25
GV2-M03/RS03	--	--	--	--	--	--	0.25-0.4
GV2-M04/RS04	--	--	--	--	--	0.37	0.4-0.63
GV2-M05/RS05	--	--	--	0.37	0.37	0.55	0.63-1
GV2-M06/RS06	--	0.37	--	0.55	0.75	1.1	1-1.6
GV2-M07/RS07	0.37	0.75	0.75	1.1	1.1	1.5	1.6-2.5
GV2-M08/RS08	0.75	1.5	1.5	1.5	2.2	3	2.5-4
GV2-M10/RS10	1.1	2.2	2.2	3	3.7	4	4-6.3
GV2-M14/RS14	2.2	4	4	4	5.5	7.5	6-10
GV2-M16/RS16	3	5.5	5.5	7.5	7.5	9	9-14
GV2-M20/RS20	4	7.5	9	9	9	11	13-18
GV2-M21/RS21	5.5	11	11	11	11	15	17-23
GV2-M22/RS22	5.5	11	11	11	15	18.5	20-25
GV2-M32/RS32	7.5	15	15	15	18.5	26	24-32

# Miniature Circuit Breaker



MEBA ELECTRIC  
ENTERPRISES.

## CPKZM0-1.0 Miniature Circuit Breaker

Motor Protective Circuit Breakers (CPKZM)

### Features and Applications:

- CPKZM0 Motor Protective Circuit Breaker is applicable for the circuit of AC50/60Hz, rated insulation voltage 750V, rated operating voltage up to 660V, rated operating current from 0.1A to 25A. It is used for protecting the motor against overload, short-circuit and phase-failure. It can be also used for starting and breaking the starter of motor and for the circuit protection in the circuit of 25A.
- Screw or DIN rail mounting
- Thermal and electromagnetic trip
- Rated operational current up to 25A
- Switching capacity 150/50KA/415V
- Short-circuit release, fixed setting to 14X $I_n$
- Single-phasing sensitive
- With screws or spring loaded terminals
- Comply with IEC/EN6094

### Technical parameter:

Standard power ratings of 3-phase motors 50/60Hz in category AC-3(kW)	Setting range of overload tripping current $I_r$ (A)	Normal breaking capacity(A)	Rated operating current 400V $I_e$ (A)	Reference
-	0.1-0.16	100	0.16	CPKZM0-01
0.06	0.16-0.25	100	0.25	CPKZM0-02
0.09	0.25-0.4	100	0.4	CPKZM0-03
0.12	0.4-0.63	100	0.63	CPKZM0-04
0.25	0.63-1	100	1	CPKZM0-05
0.55	1-1.6	100	1.6	CPKZM0-06
0.75	1.6-2.5	100	2.5	CPKZM0-07
1.5	2.5-4	100	4	CPKZM0-08
2.2	4-6.3	100	6.3	CPKZM0-10
3	6.3-10	100	6.6	CPKZM0-14
4	6.3-10	100	10	CPKZM0-16
5.5	10-16	50	16	CPKZM0-20
7.5	10-16	50	16	CPKZM0-21
9	16-20	50	20	CPKZM0-22
12.5	20-25	50	25	CPKZM0-32E

## C45D Indicator

Din Rail type LED Indicator, Neon Signal Lamp

### Features and Applications:

- The DIN Rail type Modular Signal Lamp is applicable to circuit with rated voltage 230V AC, 50/60Hz for visual indication and signaling.
- Low service duration, minimum power consumption
- Compact design in modular size, easy installation
- Rated voltage: 230V AC, 50/60Hz
- Colour: Red, green, yellow
- Connection terminal: Pillar terminal with clamp
- Connection capacity: Rigid conductor 10mm<sup>2</sup>
- Installation: - On symmetrical DIN rail  
- Panel mounting
- Illumination type:
  - A. Illumination: LED
    - Max power: 0.6W
    - Service duration: 30, 000 hours
  - B. Illumination: Neon bulb
    - Max power: 1.2W
    - Service duration: 15, 000 hours

### Dimension(mm):

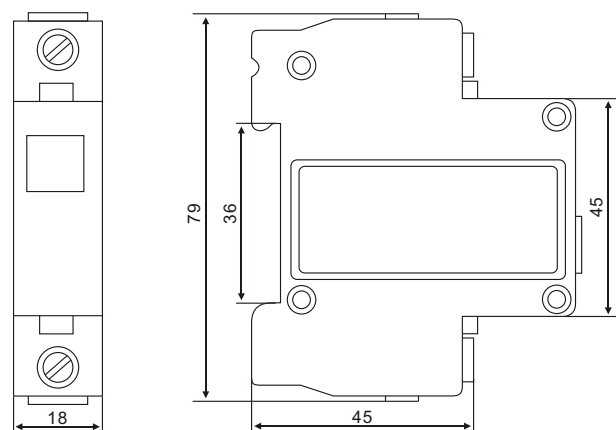



www.mebamfg.com

# Miniature Circuit Breaker

## C45N Miniature Circuit Breaker

### Features and Applications:

C45N series miniature circuit breaker is used in lighting distribution system or motor distribution system for protection overload and short-circuit in the system. The product is neoteric in structure, light in weight, reliable and excellent in performance. It has high breaking capacity, can trip quickly, and its case and items are adopted by high fire-resistant and shockproof plastics. The product, with long life, is mainly used in AC 50Hz/60Hz single-pole 230V or two, three, four pole 400V circuit for overload and short-circuit protection as well as for infrequent on-and-off switching electric equipment and lighting circuit in normal case. The products comply with IEC 60898.

### Technical parameter:

Number of Poles	1P, 1P+N, 2P, 3P, 3P+N, 4P
Rated Current (A)	1, 2, 3, 4, 6, 10, 16, 20, 25, 32, 40, (50, 63)
Breaking Capacity (A)	6000, (4500)
Rated Voltage (V)	230/400
Rated Frequency	50/60Hz
Endurance	4000
Circumstance Temperature	-5+40
Electrical Life	no less than 6000 operations
Mechanical Life	(O-C) no less than 20000 operations

### Characteristic Curve:

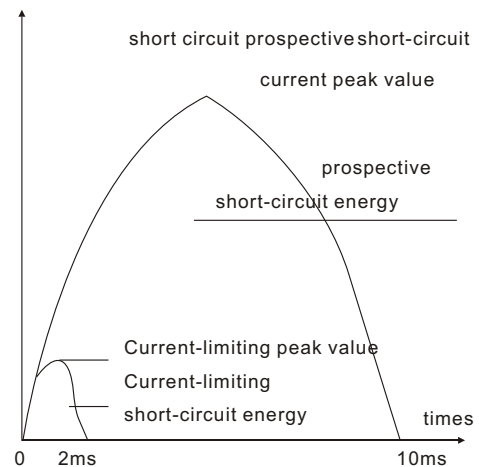
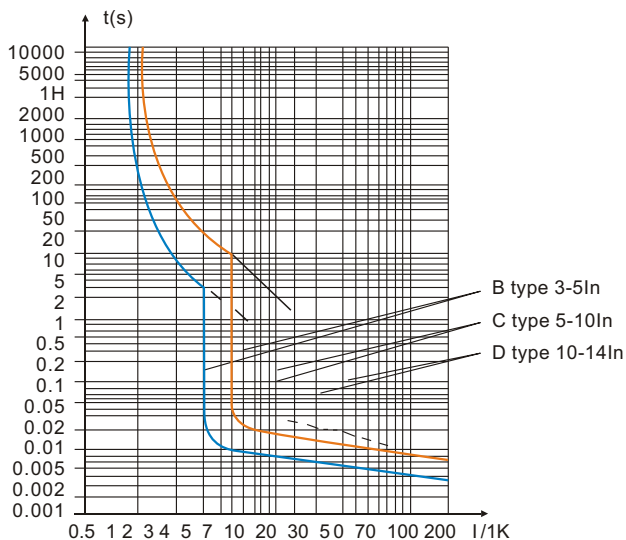

### Dimension(mm):

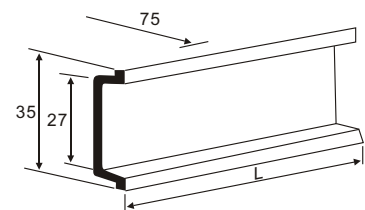
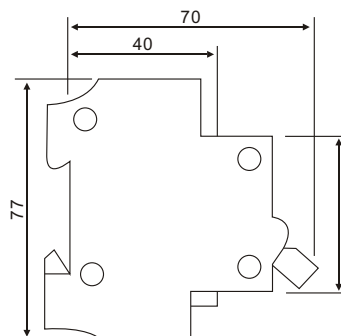
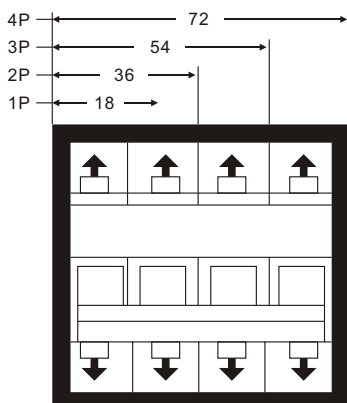

# Miniature Circuit Breaker



MEBA ELECTRIC  
ENTERPRISES.

## C47-3P Miniature Circuit Breaker

AEG E90 E91 E92 E93 S90 S91 S92 S93 Miniature circuit breaker (MCB)

- NEW AEG E90 E91 E92 MCB
- Rated Current: 6-63A
- Quality guarantee: 5 years
- CE CB certificated

### Applications:

The product is mainly used in AC 50/60Hz single pole 230V or two, three, four pole 400V voltage for overload and short-circuit protection as well as for unfrequent on-and-off switching electric equipment and lighting circuit under normal condition. The product is suitable for industry, business, building, residence, etc. It's conformity with GB10963, IEC60898 standards.

### Technical parameter:

- Rated current: 1, 2, 3, 4, 6, 10, 16, 20, 25, 32, 40, 50, 63A
- Tripping characteristics: B(3-5)In, C(5-10)In, D(10-15)In
- No. of pole: 1P, 2P, 3P, 4P
- Breaking capacity: 4.5KA, 6KA

### Characteristic Curve:

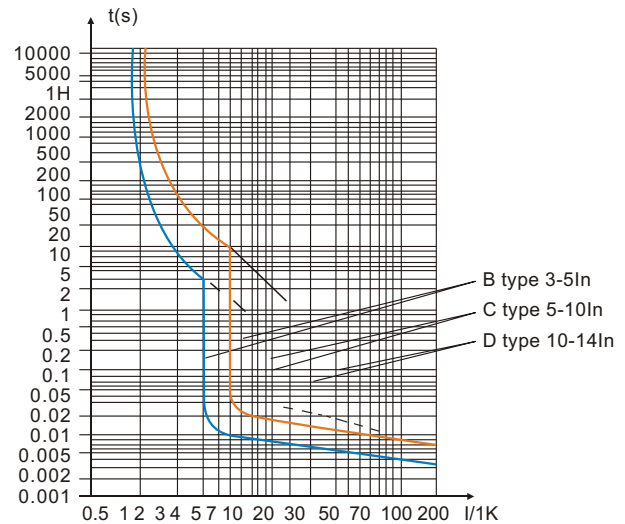

Standard		IEC60898
Number of poles		1P, 2P, 3P, 4P
Rated current(In)		6, 10, 16, 20, 25, 32, 40, 50, 63
Rated voltage(Un)		AC240/415V
Rated frequency		50/60Hz
Tripping curve		B, C, D
Release action characteristics	Time delay	1.13In > 1h Non-trip
		1.45In < 1h trip
		2.55In 1s-60s trip
	Instantaneous(Curve C)	5In > 0.1s Non-trip 10In < 0.1s trip
Magnetic releases operate		B curve: between 3 and 5In
		C curve: between 5 and 10In
		D curve: between 10 and 15In
Rated breaking capacity(Lcn)		3000A
Endurance		>2500
Circumstance temperature		-5 to +40
Electrical life		>6000 times
Mechanical life		20000 times
Tropical ration		Treatment 2(RH95%, at 55)
Protection degree		IP20





www.mebamfg.com

# Miniature Circuit Breaker

## C65N Miniature Circuit Breaker

### Features and Applications:

The products of C65N belong to the advanced level of nineties in the international instead of the older generation of C45N. They have protective function as shortage and overload, and are used in lighting distribution system in industry, commerce and dwelling, and protecting fractional electrical motors. And they also have many merits of high protective grade (up to IP20), high breaking capacity, reliable sensitive action, convenient, multipole assembling long life etc. They are mainly adapted to the circuit of AC 50Hz, 230V in single pole, 400V in double, three, four poles for protecting overload and shortcircuit. Meanwhile, they are also used in turning on or off the electrical apparatus and lighting circuit under the normal conditions.

### Dimension(mm):

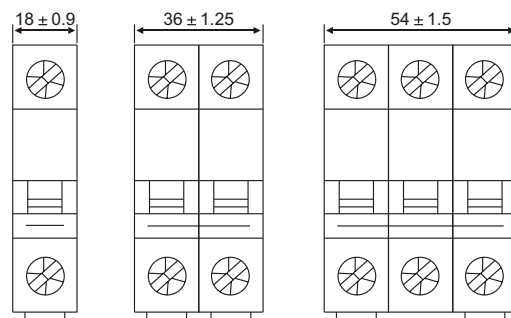

### Characteristic Curve:

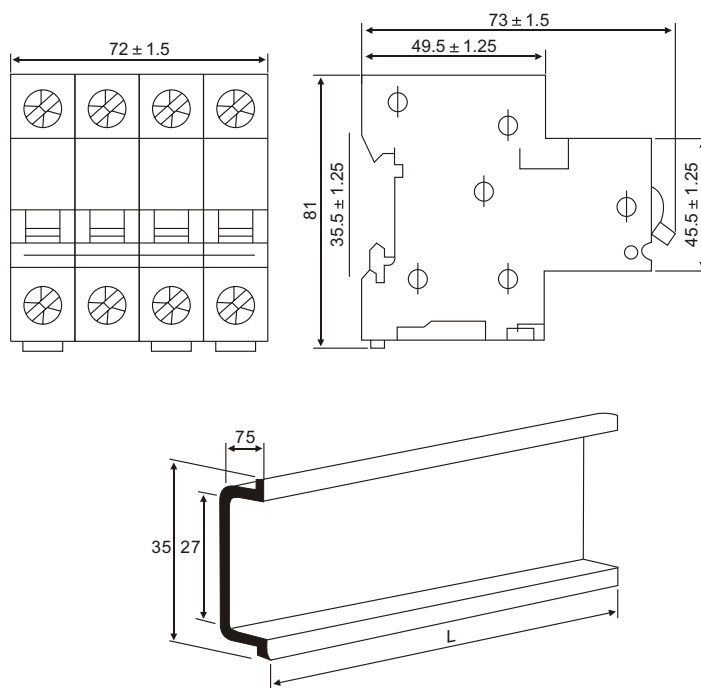
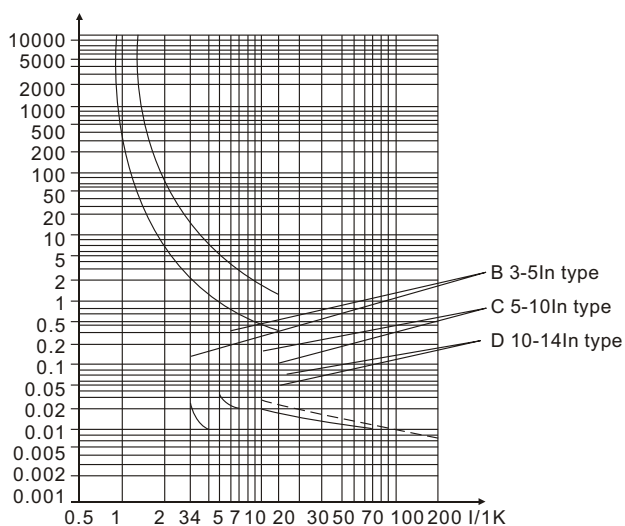

### Technical parameter:

Character	Standard	Rated current (A)	Pole	Voltage (V)	Breaking Capacity (A)
B C D	IEC898	1, 2, 3, 4, 5, 6, 10, 16, 20, 25, 32, 40, 50, 63A	1	230/240	6000
			2, 3, 4	380/415	6000
	IEC847-2	1, 2, 3, 4, 5, 6, 10, 16, 20, 25, 32, 40, 50, 63A	1	130	20000
				230/240	10000
			2, 3, 4	400/415	3000
				230/240	20000
				400/415	10000

# Miniature Circuit Breaker



MEBA ELECTRIC  
ENTERPRISES.

## XYDB7-3P Miniature Circuit Breaker

### Features and Applications:

XYDB7 have protective function as shortage as overload, and used in lighting distribution system, industry, commerce, and protect fractional electric motors. And they also have many merits of high protective grade (upto IP20), high break capacity, reliable sensitive action, convenient, multipole assembling, long life etc. They are mainly adapted to the circuit of AC 50Hz, 230V in single pole, 400V in double, three, four poles for protecting overload and short circuit. Meanwhile, they are also used in turning on or off the electric apparatus and lighting circuit under the normal condition.

### Technical parameter:

Electrical specification	EN60898 (IEC898 GB10963-99)
Conforms to standard of electrical	230V/400V; 50/60Hz
Rated current (Ue)	10KA IEC898 (0.5 ~ 63A)
	15KA IEC947-2 (0.5 ~ 63A)
Short circuit breaking capacity of DC	Max.48V (KL7..., 10KA) single pole
	Max.250v (KI7-DC, 6KA) single pole
Performance	C,D characteristic curve
Max.fuse that can be connected to	100AgL (> 10KA)
Selective grade	3
Working ambient temperature	-5°C to + 40°C
Enclosed protective class	P40 (Under mounting)
Life: Electrical Mechanical	No less than 8000 times
	No less than 20000 times
The length of exposed plane	45mm
Enclosure height	80mm
Enclosure width	17.5mm per pole (single pole)
	35mm: 1P+N (two pole)
Mounting manner	Used for track of 35mm of IEC standard
Terminal manner	Two-function terminal can connect with busbar and conducting wire
Terminal block capacity	Wire 1-25mm <sup>2</sup>
	Conducting wire 0.8-2mm



www.mebamfg.com

# Miniature Circuit Breaker

## MB1-63 Miniature Circuit Breaker

### Specification needs:

Product Details	Manufacturer: Meba ElectricEnterprises		
	Country of Origin: China		
	Brand: Meba		
	Model: MB1-63		
Manufacturing Standards	IEC 60898 IEC60947		
Tropicalization	Relative Humidity	°C	93% RH at 25°C
	Room Temperature	°C	10°C a 60°C
Electrical Properties	Rated at 40°C	A	6/10/16/20/25/32/40/50/63
	Rated operating voltage at 40°C	Vac	240/415
	Nominal Frequency	Hz	50/60
	Interrupting Capacity at 230 V	kA	6
	Operating temperature	°C	40
	Degree of Protection		IP20
	Number of poles		1/2/3/4
	Conductor cross section (minimum allowable)	mm <sup>2</sup>	25
	Minimum number of power moves		4000
	Minimum number of mechanical operations		10000
	Operation curve		B/C/D
	Current Trip Curve C	A	5 a 10 In
	Characteristic Intervention		attach
Type of Assembly	FOR RIEL DIN 35 mm		
Operation Indicator Window	The circuit breaker have an operating window color display that shows the state in which it is ( connected or disconnected ).		
Features	MAGNETIC COIL: ensures the switching of short-circuit, speaking within the following ranges: 5 to 10 times rated current ( Type C ), 3 to 5 times rated current ( Type B ), 10 to 14 times rated current ( Type D )		
	BIMETAL: ensures the breaker trip when overloaded.		
	ARC CHAMBER: effectively dissipates the electric arc that is generated by the opening contacts of the trigger mechanism in the presence of an overload or short circuit.		
Present Certificates	CE CB		
	ISO 9001-2000 awarded by the competent certification body, Meba is qualified in the manufacturing of the object		
	IEC 60898 standards in the manufacture of the goods		
	Curve compliance issued Shot by an accredited laboratory for effect		
Testing For Acceptance	Life, given by Meba to ensure that the life of the goods offered by at least 15 years.		
	Before receiving the circuit breakers (breakers), customers may perform the tests maybe necessary to ensure compliance with the technical specifications.		
Packing	The packaging is sure that withstand any adverse conditions during transport and handling to the warehouse of customers		
Dial Century, Year, Month and Batch	In one of its sides the breaker is marked with permanent ink, year, month and batch.		
Catalog	Attach catalogs indicating the technical specification		
Shows	Submit sample of the product offered		
Technical Warranty	2 YEARS		
Place of Delivery	FOB & CNF		
Delivery	25 Days		

# Miniature Circuit Breaker



MEBA ELECTRIC ENTERPRISES.

## MB1-63 Miniature Circuit Breaker

### Charcteristic Curve:

B type

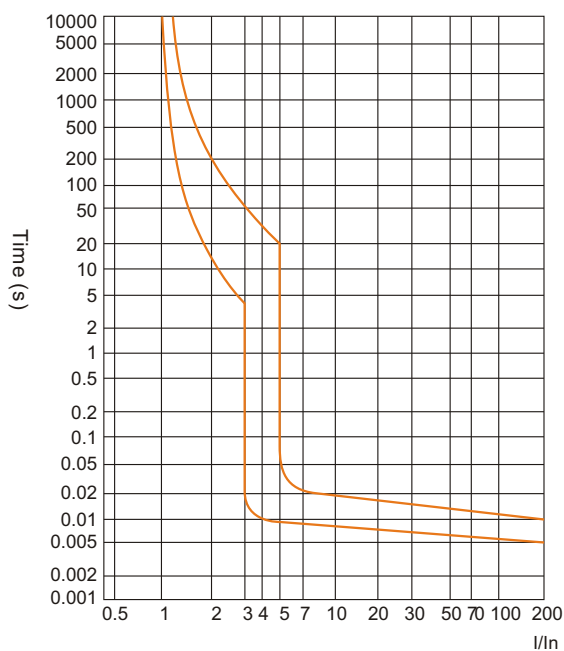

D type

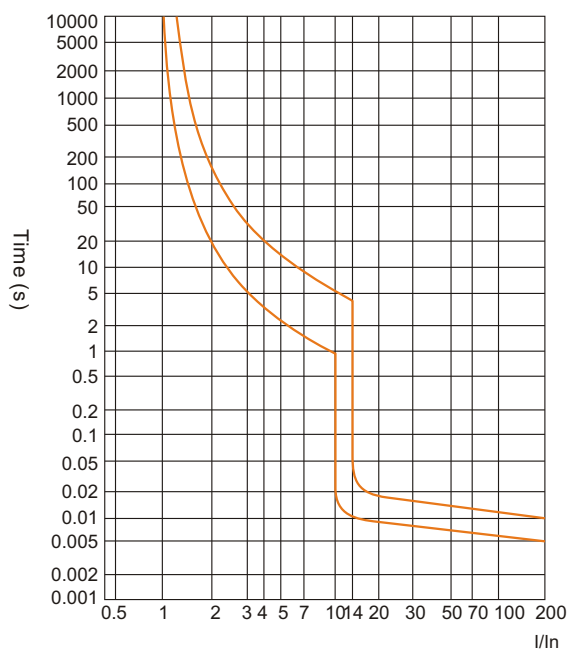

C type

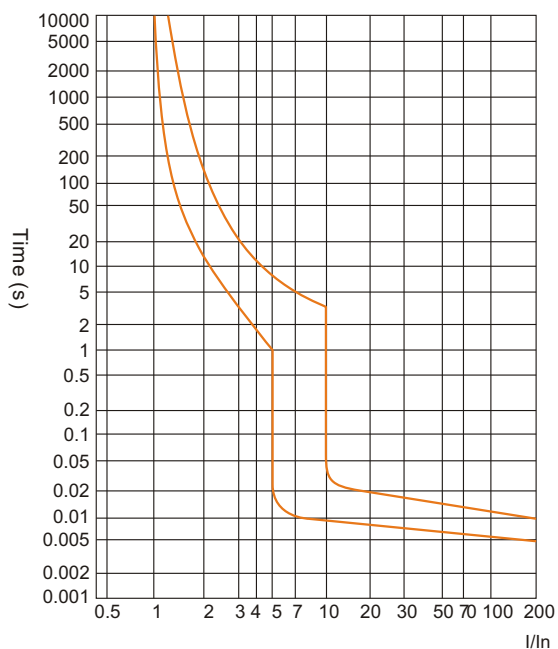

### Dimension(mm):

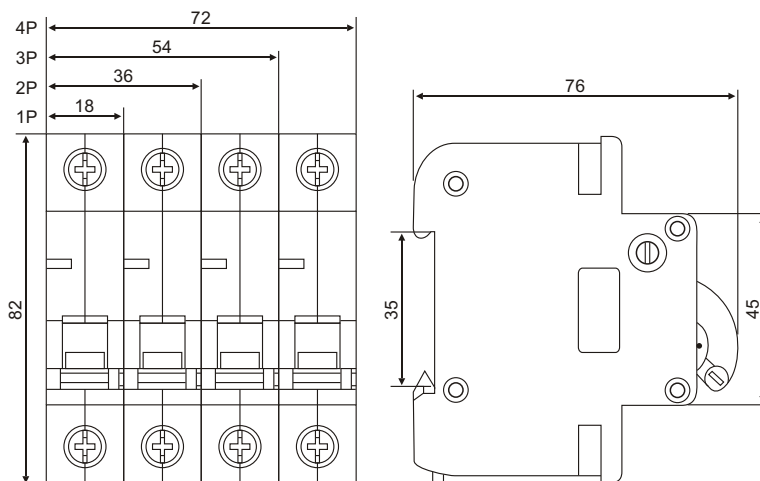



www.mebamfg.com

# Miniature Circuit Breaker

## MB7 Miniature Circuit Breaker

### Specification needs:

Product Details	Manufacturer: Meba ElectricEnterprises				
	Country of Origin: China				
	Brand: Meba				
	Model: MB7				
Manufacturing Standards	IEC 60898 IEC60947				
Tropicalization	Relative Humidity	℃	93% RH at25℃		
	Room Temperature	℃	10℃ a 60℃		
Electrical Properties	Rated at 40℃	A	6/10/16/20/25/32/40/50/63		
	Rated operating voltage at 40℃	Vac	240/415		
	Nominal Frequency	Hz	50/60		
	Interrupting Capacity at230 V	kA	10		
	Operating temperature	℃	40		
	Degree of Protection		IP20		
	Number of poles		1, 1+N, 2, 3, 3+N, 4		
	Conductor cross section (minimum allowable)	mm²	25		
	Minimum number of power moves		4000		
	Minimum number of mechanical operations		8000		
	Operation curve		B/C/D		
	Current Trip Curve	A	Type B 3 a 5 In	Type C 5 a 10 In	Type D 10 a 14 In
	Characteristic Intervention		attach		
Type of Assembly	FOR RIEL DIN 35 mm				
Operation Indicator Window	The circuit breaker have an operating window color display that shows the state in which it is ( connected or disconnected ).				
Features	MAGNETIC COIL: ensures the switching of short-circuit, speaking within the following range s: 5 to 10 times rated current ( Type C ), 3 to 5 times rated current ( Type B ), 10 to 14 times rated current ( Type D )				
	BIMETAL: ensures the breaker trip when overloaded.				
	ARC CHAMBER: effectively dissipates the electric arc that is generated by the opening contacts of the trigger mechanism in the presence of an overload or short circuit.				
Present Certificates	CE CB				
	ISO9001-2000 awarded by the competent certification body, Meba is qualified in the manufacturing of the object				
	IEC 60898 standards in the manufacture of the goods				
	Curve compliance issued Shot by an accredited laboratory for effect				
	Life, given by Meba to ensure that the life of the goods offered by at least 15 years.				
Testing For Acceptance	Before receiving the circuit breakers (breakers), customers may perform the tests maybe necessary to ensure compliance with the technical specifications.				
Packing	The packaging is sure that withstand any adverse conditions during transport and handling to the warehouse of customers				
Dial Century, Year, Month and Batch	In one of its sides the breaker is marked with permanent ink, year, month and batch.				
Catalog	Attach catalogs indicating the technical specification				
Shows	Submit sample of the product offered				
Technical Warranty	2 YEARS				
Place of Delivery	FOB & CNF				
Delivery	25 Days				

# Miniature Circuit Breaker



MEBA ELECTRIC ENTERPRISES.

## MB7 Miniature Circuit Breaker

### Dimension(mm):

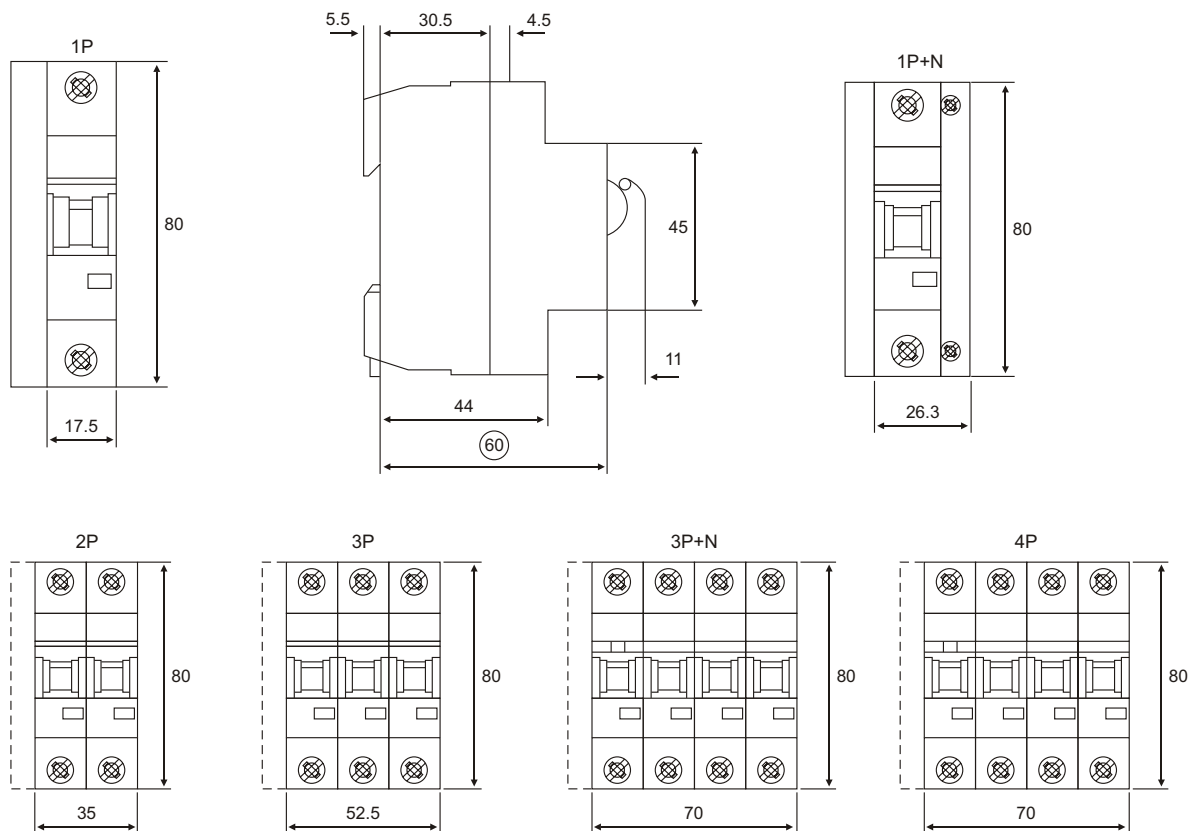

## MB040 Time Relay

### Dimension(mm):

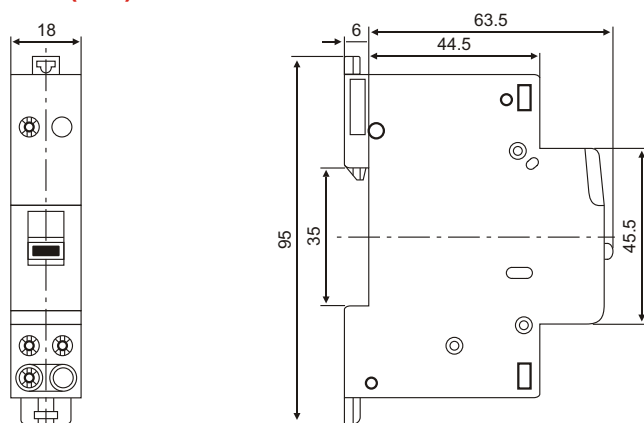



www.mebamfg.com

# Miniature Circuit Breaker

## MB040 Time Relay

### Specification needs:

Product Details	Manufacturer: Meba ElectricEnterprises		
	Country of Origin: China		
	Brand: Meba		
	Model: MB040		
Manufacturing Standards	IEC 60898		
Tropicalization	Relative Humidity	°C	93% RH at25°C
	Room Temperature	°C	10°C a 60°C
Electrical Properties	Rated at 40°C	A	6/16/20/25/32
	Rated operating voltage at 40°C	Vac	120/240/415
	Nominal Frequency	Hz	50/60
	Interrupting Capacity	kA	3/4.5/6
	Operating temperature	°C	40
	Degree of Protection		IP20
	Number of poles		1
	Conductor cross section (minimum allowable)	mm <sup>2</sup>	25
	Minimum number of power moves		4000
	Minimum number of mechanical operations		8000
	Operation curve		C
	Current Trip Curve	A	5 a 10 In
	Characteristic Intervention		attach
Type of Assembly	FOR RIEL DIN 35 mm		
Features	MAGNETIC COIL: ensures the switching of short-circuit, speaking within the following ranges: 5 to 10 times rated current ( Type C ).		
	BIMETAL: ensures the breaker trip when overloaded.		
	ARC CHAMBER: effectively dissipates the electric arc that is generated by the opening contacts of the trigger mechanism in the presence of an overload or short circuit.		
Present Certificates	ISO 9001-2000		
	IEC 60898 standards		
	Curve compliance issued Shot by an accredited laboratory for effect		
	Life, given by us to ensure that the life of the goods offered by at least 5 years.		
Testing For Acceptance	Before receiving the circuit breakers (breakers), customers may perform the tests maybe necessary to ensure compliance with the technical specifications.		
Packing	We are sure the packaging withstand any adverse conditions during transport and handling to the cellars of the Company. Carton or Pallet		
Dial Century, Year, Month and Batch	In one of its sides the breaker is marked with the symbol permanent ink, year, month and batch.		
Catalog	Available		
Shows	Submit sample of the product offered		
Technical Warranty	2 YEARS		
Place of Delivery	CIF CNF FOB		
Delivery	25 Days		

# Miniature Circuit Breaker



MEBA ELECTRIC  
ENTERPRISES.

## MB043 Isolator

### Specification needs:

Product Details	Manufacturer: Meba Electric Enterprises		
	Country of Origin: China		
	Brand: Meba		
	Model: MB043 Isolator		
Manufacturing Standards	IEC 60947-3		
Tropicalization	Relative Humidity	°C	93% RH at 25°C
	Room Temperature	°C	10°C a 60°C
Electrical Properties	Rated at 40°C	A	6/16/20/25/32
	Rated operating voltage at 40°C	Vac	120/240/415
	Nominal Frequency	Hz	50/60
	Interrupting Capacity	kA	0
	Operating temperature	°C	40
	Degree of Protection		IP20
	Number of poles		1/2/3/4
	Conductor cross section (minimum allowable)	mm <sup>2</sup>	25
	Minimum number of power moves		4000
	Minimum number of mechanical operations		8000
	Operation curve		/
	Current Trip Curve	A	/
	Characteristic Intervention		attach
Type of Assembly	FOR RIEL DIN 35 mm		
Present Certificates	ISO 9001-2000		
	IEC 60947-3 standards		
	Life, given by us to ensure that the life of the goods offered by at least 5 years.		
Testing For Acceptance	Before receiving the circuit breakers (breakers), customers may perform the tests maybe necessary to ensure compliance with the technical specifications.		
Packing	We are sure the packaging withstand any adverse conditions during transport and handling to the cellars of the Company. Carton or Pallet		
Dial Century, Year, Month and Batch	In one of its sides the breaker is marked with the symbol permanent ink, year, month and batch.		
Catalog	Available		
Shows	Submit sample of the product offered		
Technical Warranty	2 YEARS		
Place of Delivery	CIF CNF FOB		
Delivery	25 Days		





www.mebamfg.com

# Miniature Circuit Breaker

## MB32 DPN

### Applications:

MB32 series is mainly for protection of circuits with AC220V and 50Hz/60Hz, and for unfrequent conversion under normal conditions as well. Its action can be up to two pole with its only one pole volume and be used as a leakage breaker by assembling with leakage. It is produced per EN60.898, IEC947-2 standards.

### Over-current tripping characteristic:

Tripping	Tripping rated current( $I_n$ A)	Beginning state	Test current	Norminative Time	Test result	Note
C	$\leq 40$	Cold state	$1.13I_n$	$t \geq 1h$	No tripping	The current will rise to normative value in 5s
		Heat state	$1.45I_n$	$t < 1h$	Tripping	
		Cold state	$2.55I_n$	$1s < t < 60s$	Tripping	
		Cold state	$5I_n$	$t \geq 0.1h$	No tripping	Close auxillary switch making the circuit
		Cole state	$10I_n$	$t < 0.1s$	Tripping	

### Main Technical Data:

Rated current A	Pole NO	Rated voltage(V)	Breaking capacity(KA)	Instantaneous Tripping type	Instantaneous Protection current range	Electric life
6、10、16、20、25、32、40	1P+N	240/415	4.5	C	$5I_n < I \leq 10I_n$	5000

### Dimension(mm):

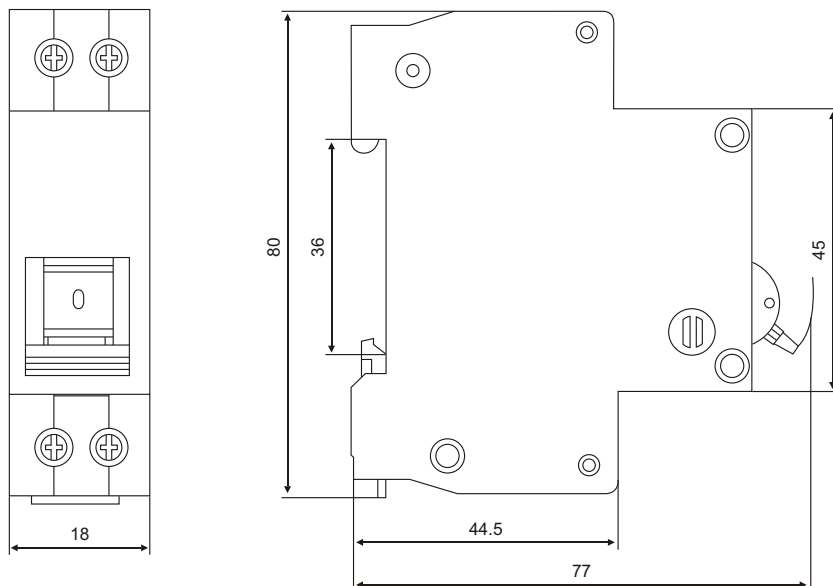

# Miniature Circuit Breaker



MEBA ELECTRIC  
ENTERPRISES.

## MB32 DPN

### Specification needs:

Product Details	Manufacturer: Meba Electric Enterprises		
	Country of Origin: China		
	Brand: Meba		
	Model: MB32		
Manufacturing Standards	IEC 60898 IEC947-2		
Tropicalization	Relative Humidity	°C	93% RH at 25°C
	Room Temperature	°C	10°C a 60°C
Electrical Properties	Rated at 40°C	A	6/10/16/20/25/32/40
	Rated operating voltage at 40°C	Vac	240/415
	Nominal Frequency	Hz	50/60
	Interrupting Capacity at 230 V	kA	4.5
	Operating temperature	°C	40
	Degree of Protection		IP20
	Number of poles		1P+N
	Conductor cross section (minimum allowable)	mm <sup>2</sup>	25
	Minimum number of power moves		5000
	Minimum number of mechanical operations		10000
	Operation curve		C
	Current Trip Curve	A	5 a 10 In
	Characteristic Intervention		attach
Type of Assembly	FOR RIEL DIN 35 mm		
Features	MAGNETIC COIL: ensures the switching of short-circuit, speaking within the following ranges: 5 to 10 times rated current (Type C).		
	BIMETAL: ensures the breaker trip when overloaded.		
	ARC CHAMBER: effectively dissipates the electric arc that is generated by the opening contacts of the trigger mechanism in the presence of an overload or short circuit.		
Present Certificates	CE		
	ISO9001-2000 awarded by the competent certification body, Meba is qualified in the manufacturing of the object		
	IEC 60898 standards in the manufacture of the goods awarded by an international certifying body.		
	Curve compliance issued Shot by an accredited laboratory for effect		
Testing For Acceptance	Life, given by Meba to ensure that the life of the goods offered by at least 15 years.		
	Before receiving the circuit breakers (breakers), customer may perform the tests maybe necessary to ensure compliance with the technical specifications.		
Packing	The packaging is sure that withstand any adverse conditions during transport and handling to the warehouse of customer		
Dial Century, Year, Month and Batch	In one of its sides the breaker should be marked with permanent ink, year, month and batch.		
Catalog	Attach catalogs indicating the technical specifications		
Shows	Submit sample of the product offered		
Technical Warranty	2 YEARS		
Place of Delivery	FOB CIF		
Delivery	25 Days		



www.mebamfg.com

# Miniature Circuit Breaker

## MBL10 Miniature Circuit Breaker

### Specification needs:

Product Details	Manufacturer: Meba ElectricEnterprises		
	Country of Origin: China		
	Brand: Meba		
	Model: MBL10		
Manufacturing Standards	IEC 60898 IEC60947		
Tropicalization	Relative Humidity	°C	93% RH at25°C
	Room Temperature	°C	10°C a 60°C
Electrical Properties	Rated at 40°C	A	6/10/16/20/25/32/40/50/63
	Rated operating voltage at 40°C	Vac	240/415
	Nominal Frequency	Hz	50/60
	Interrupting Capacity at 230V	kA	6
	Operating temperature	°C	40
	Degree of Protection		IP20
	Number of poles		1/2/3/4
	Conductor cross section (minimum allowable)	mm <sup>2</sup>	25
	Minimum number of power moves		4000
	Minimum number of mechanical operations		10000
	Operation curve		B/C/D
	Current Trip Curve C	A	5 a 10 In
	Characteristic Intervention		attach
Type of Assembly	FOR RIEL DIN 35mm		
Operation Indicator Window	The circuit breaker have an operating window color display that shows the state in which it is (connected or disconnected).		
Features	MAGNETIC COIL: ensures the switching of short-circuit, speaking within the following ranges: 5 to 10 times rated current (Type C), 3 to 5 times rated current ( Type B ), 10 to 14 times rated current ( Type D )		
	BIMETAL: ensures the breaker trip when overloaded.		
	ARC CHAMBER: effectively dissipates the electric arc that is generated by the opening contacts of the trigger mechanism in the presence of an overload or short circuit.		
Present Certificates	CE CB		
	ISO 9001-2000 awarded by the competent certification body, Meba is qualified in the manufacturing of the object		
	IEC 60898 standards in the manufacture of the goods		
	Curve compliance issued Shot by an accredited laboratory for effect		
Testing For Acceptance	Life, given by Meba to ensure that the life of the goods offered by at least 15 years.		
	Before receiving the circuit breakers (breakers), customers may perform the tests maybe necessary to ensure compliance with the technical specifications.		
Packing	The packaging is sure that withstand any adverse conditions during transport and handling to the warehouse of customers		
Dial Century, Year, Month and Batch	In one of its sides the breaker is marked with permanent ink, year, month and batch.		
Catalog	Attach catalogs indicating the technical specification		
Shows	Submit sample of the product offered		
Technical Warranty	2 YEARS		
Place of Delivery	FOB & CNF		
Delivery	25 Days		

# Miniature Circuit Breaker



MEBA ELECTRIC  
ENTERPRISES.

## MBL11 Miniature Circuit Breaker

### Specification needs:

Product Details	Manufacturer: Meba Electric Enterprises		
	Country of Origin: China		
	Brand: Meba		
	Model: MBL11		
Manufacturing Standards	IEC 60898 IEC60947		
Tropicalization	Relative Humidity	°C	93% RH at 25°C
	Room Temperature	°C	-5°C a 40°C
Electrical Properties	Rated at 40°C	A	6/10/16/20/25/32/40/50/63
	Rated operating voltage at 40°C	Vac	240/415
	Nominal Frequency	Hz	50/60
	Interrupting Capacity at 230V	kA	6
	Operating temperature	°C	-5°C a 40°C
	Degree of Protection		IP20
	Number of poles		1/2/3/4
	Conductor cross section (minimum allowable)	mm <sup>2</sup>	25
	Minimum number of power moves		6000
	Minimum number of mechanical operations		20000
	Operation curve		B/C/D
	Current Trip Curve C	A	5 a 10 In
	Characteristic Intervention		attach
Type of Assembly	FOR RIEL DIN 35mm		
Operation Indicator Window	The circuit breaker have an operating window color display that shows the state in which it is (connected or disconnected).		
Features	MAGNETIC COIL: ensures the switching of short-circuit, speaking within the following ranges: 5 to 10 times rated current (Type C), 3 to 5 times rated current (Type B), 10 to 14 times rated current (Type D)		
	BIMETAL: ensures the breaker trip when overloaded.		
	ARC CHAMBER: effectively dissipates the electric arc that is generated by the opening contacts of the trigger mechanism in the presence of an overload or short circuit.		
Present Certificates	CE CB		
	ISO 9001-2000 awarded by the competent certification body, Meba is qualified in the manufacturing of the object		
	IEC 60898 standards in the manufacture of the goods		
	Curve compliance issued Shot by an accredited laboratory for effect		
Testing For Acceptance	Life, given by Meba to ensure that the life of the goods offered by at least 15 years.		
	Before receiving the circuit breakers (breakers), customers may perform the tests maybe necessary to ensure compliance with the technical specifications.		
Packing	The packaging issue that withstand any adverse conditions during transport and handling to the warehouse of customers		
Dial Century, Year, Month and Batch	In one of its sides the breaker is marked with permanent ink, year, month and batch.		
Catalog	Attach catalogs indicating the technical specification		
Shows	Submit sample of the product offered		
Technical Warranty	2 YEARS		
Place of Delivery	FOB & CNF		
Delivery	25 Days		



www.mebamfg.com

## Miniature Circuit Breaker

### MBL11 Miniature Circuit Breaker

### MB47-1P/2P Miniature Circuit Breaker

#### Overall & Installation Dimensions:

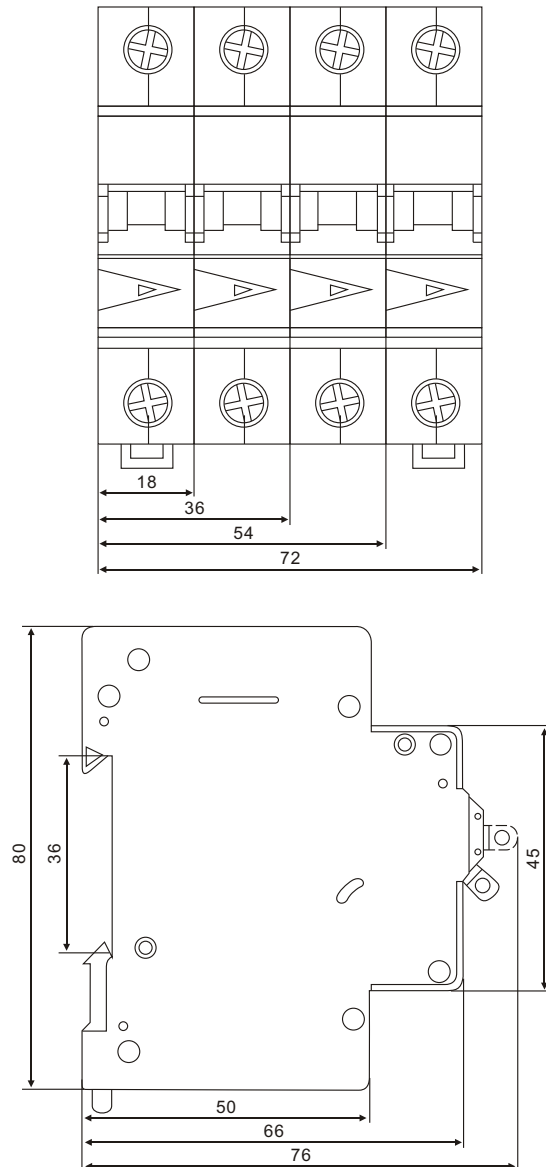

#### Applications:

Protection and control of circuit against overload and short circuit, in building installation-such as houses, offices, commercial complex, motorsystem (D curve) and industrial installation-for switching, control, protection and regulation of electrical circuits. Also in switchgear panels, railway and marine application.

#### Overall and mounting dimensioned chart:

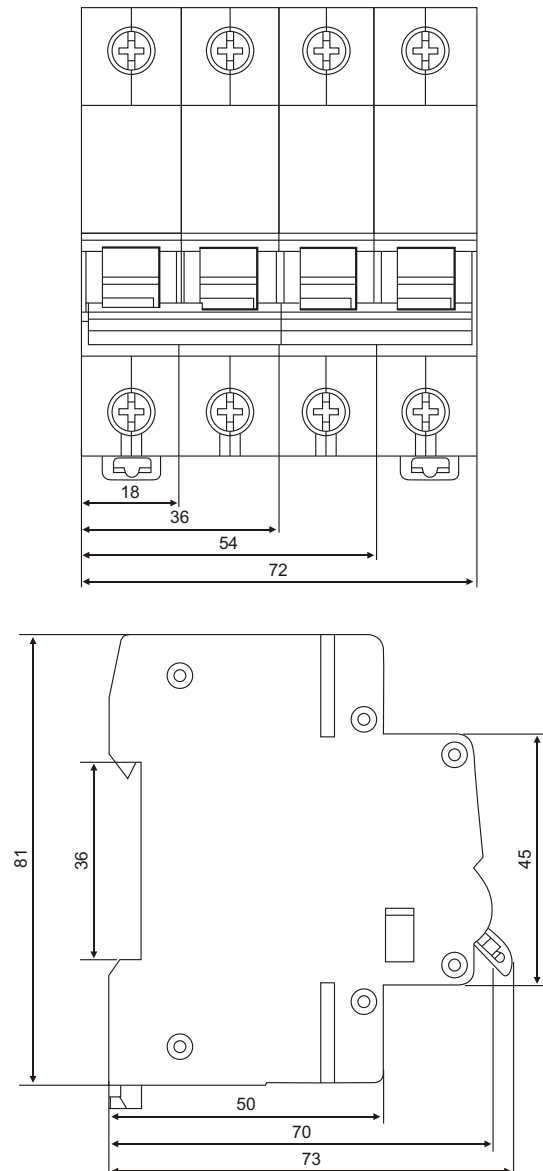

# Miniature Circuit Breaker



**MEBA ELECTRIC  
ENTERPRISES.**

## MB47-1P/2P Miniature Circuit Breaker

### Specification needs:

Product Details	Manufacturer: Meba ElectricEnterprises				
	Country of Origin:China				
	Brand: Meba				
	Model: MB47-1P/ 2P				
Manufacturing Standards	IEC 60898 IEC60947				
Tropicalization	Relative Humidity	℃	93% RH at25℃		50% RH at40℃
	Room Temperature	℃	-5℃ a 40℃		
Electrical Properties	Rated at 40℃	A	6/10/16/20/25/32/40/50/63		
	Rated operating voltage at 40℃	Vac	240/415		
	Nominal Frequency	Hz	50/60		
	Interrupting Capacity at 230V	kA	6		
	Operating temperature	℃	40		
	Degree of Protection		IP20		
	Number of poles		1/2/3/4		
	Conductor cross section (minimum allowable)	mm <sup>2</sup>	25		
	Minimum number of power moves		4000		
	Minimum number of mechanical operations		8000		
	Operation curve		B/C/D		
	Current Trip Curve	A	Type B: 3 a 5 In	Type C: 5 a 10 In	Type D: 10 a 14 In
	Characteristic Intervention		attach		
	Type of Assembly	FOR RIEL DIN 35 mm			
Features	MAGNETIC COIL: ensures the switching of short-circuit, speaking within the following ranges: 5 to 10 times rated current ( Type C ), 3 to 5 times rated current ( Type B ), 10 to 14 times rated current ( Type D )				
	BIMETAL: ensures the breaker trip when overloaded.				
	ARC CHAMBER: effectively dissipates the electric arc that is generated by the opening contacts of the trigger mechanism in the presence of an overload or short circuit.				
Present Certificates	CE CB				
	ISO9001-2000 awarded by the competent certification body, Meba is qualified in the manufacturing of the object				
	IEC 60898 standards in the manufacture of the goods				
	Curve compliance issued Shot by an accredited laboratory for effect				
	Life, given by Meba to ensure that the life of the goods offered by at least 15 years.				
Testing For Acceptance	Before receiving the circuit breakers (breakers), customers may perform the tests maybe necessary to ensure compliance with the technical specifications.				
Packing	The packaging is sure that withstand any adverse conditions during transport and handling to the warehouse				
	of customers				
Dial Century, Year, Month and Batch	In one of its sides the breaker is marked with permanent ink, year, month and batch.				
Catalog	Attach catalogs indicating the technical specification				
Shows	Submit sample of the product offered				
Technical Warranty	2 YEARS				
Place of Delivery	FOB & CNF				
Delivery	25 Days				



www.mebamfg.com

# Miniature Circuit Breaker

## MB48/MB49 Miniature Circuit Breaker

### Specification needs:

Product Details	Manufacturer: Meba ElectricEnterprises		
	Country of Origin: China		
	Brand: Meba		
	Model: MB48/ MB49		
Manufacturing Standards	IEC 60898 IEC60947		
Tropicalization	Relative Humidity	°C	93% RH at 25°C
	Room Temperature	°C	10°C a 60°C
Electrical Properties	Rated at 40°C	A	6/10/16/20/25/32/40/50/63
	Rated operating voltage at 40°C	Vac	240/415
	Nominal Frequency	Hz	50/60
	Interrupting Capacity at 230V	kA	6
	Operating temperature	°C	40
	Degree of Protection		IP20
	Number of poles		1/2/3/4
	Conductor cross section (minimum allowable)	mm <sup>2</sup>	25
	Minimum number of power moves		4000
	Minimum number of mechanical operations		10000
	Operation curve		B/C/D
	Current Trip Curve	A	5 a 10 In
	Characteristic Intervention		attach
Type of Assembly	FOR RIEL DIN 35 mm		
Features	MAGNETIC COIL: ensures the switching of short-circuit, speaking within the following ranges: 5 to 10 times rated current ( Type C ), 3 to 5 times rated current ( Type B ), 10 to 20 times rated current ( Type D )		
	BIMETAL: ensures the breaker trip when overloaded.		
	ARC CHAMBER: effectively dissipates the electric arc that is generated by the opening contacts of the trigger mechanism in the presence of an overload or short circuit.		
Present Certificates	CE CB		
	ISO 9001-2000 awarded by the competent certification body, Meba is qualified in the manufacturing of the object		
	IEC 60898 standards in the manufacture of the goods		
	Curve compliance issued Shot by an accredited laboratory for effect		
Testing For Acceptance	Life, given by Meba to ensure that the life of the goods offered by at least 15 years.		
	Before receiving the circuit breakers (breakers), customers may perform the tests maybe necessary to ensure compliance with the technical specifications.		
Packing	The packaging is sure that withstand any adverse conditions during transport and handling to the warehouse of customers		
Dial Century, Year, Month and Batch	In one of its sides the breaker is marked with permanent ink, year, month and batch.		
Catalog	Attach catalogs indicating the technical specification		
Shows	Submit sample of the product offered		
Technical Warranty	2 YEARS		
Place of Delivery	FOB & CNF		
Delivery	25 Days		

# Miniature Circuit Breaker



**MEBA ELECTRIC  
ENTERPRISES.**

## MB50/MB51 Miniature Circuit Breaker

### Specification needs:

Product Details	Manufacturer: Meba Electric Enterprises		
	Country of Origin: China		
	Brand: Meba		
	Model: MB50/ MB51		
Manufacturing Standards	IEC 60898 IEC60947		
Tropicalization	Relative Humidity	°C	93% RH at 25°C
	Room Temperature	°C	10°C a 60°C
Electrical Properties	Rated at 40°C	A	6/10/16/20/25/32/40/50/63
	Rated operating voltage at 40°C	Vac	240/415
	Nominal Frequency	Hz	50/60
	Interrupting Capacity at 230V	kA	6
	Operating temperature	°C	40
	Degree of Protection		IP20
	Number of poles		1/2/3/4
	Conductor cross section (minimum allowable)	mm <sup>2</sup>	25
	Minimum number of power moves		4000
	Minimum number of mechanical operations		10000
	Operation curve		B/C/D
	Current Trip Curve	A	5 a 10 In
	Characteristic Intervention		attach
Type of Assembly	FOR RIEL DIN 35 mm		
Features	MAGNETIC COIL: ensures the switching of short-circuit, speaking within the following ranges: 5 to 10 times rated current ( Type C ), 3 to 5 times rated current ( Type B ), 10 to 20 times rated current ( Type D )		
	BIMETAL: ensures the breaker trip when overloaded.		
	ARC CHAMBER: effectively dissipates the electric arc that is generated by the opening contacts of the trigger mechanism in the presence of an overload or short circuit.		
Present Certificates	CE CB		
	ISO 9001-2000 awarded by the competent certification body, Meba is qualified in the manufacturing of the object		
	IEC 60898 standards in the manufacture of the goods		
	Curve compliance issued Shot by an accredited laboratory for effect		
Testing For Acceptance	Life, given by Meba to ensure that the life of the goods offered by at least 15 years.		
	Before receiving the circuit breakers (breakers), customers may perform the tests maybe necessary to ensure compliance with the technical specifications.		
Packing	The packaging is sure that withstand any adverse conditions during transport and handling to the warehouse of customers		
Dial Century, Year, Month and Batch	In one of its sides the breaker is marked with permanent ink, year, month and batch.		
Catalog	Attach catalogs indicating the technical specification		
Shows	Submit sample of the product offered		
Technical Warranty	2 YEARS		
Place of Delivery	FOB & CNF		
Delivery	25 Days		





www.mebamfg.com

# Miniature Circuit Breaker

## MB52 Isolator

### Specification needs:

Product Details	Manufacturer: Meba ElectricEnterprises		
	Country of Origin: China		
	Brand: Meba		
	Model: MB52 Isolator		
Manufacturing Standards	IEC 60947-3		
Tropicalization	Relative Humidity	°C	93% RH at25°C
	Room Temperature	°C	10°C a 60°C
Electrical Properties	Rated at 40°C	A	6/16/20/25/32/40/50/63
	Rated operating voltage at 40°C	Vac	240/415
	Nominal Frequency	Hz	50/60
	Interrupting Capacity	kA	0
	Operating temperature	°C	40
	Degree of Protection		IP20
	Number of poles		1/2/3/4
	Conductor cross section (minimum allowable)	mm <sup>2</sup>	25
	Minimum number of power moves		4000
	Minimum number of mechanical operations		8000
	Operation curve		/
	Current Trip Curve	A	/
	Characteristic Intervention		attach
Type of Assembly	FOR RIEL DIN 35 mm		
Operation Indicator Window	The breaker have an operating window color display that shows the state in which it is ( connected or disconnected ).		
Present Certificates	CE		
	ISO 9001-2000		
	IEC 60947-3 standards		
	Life, given by us to ensure that the life of the goods offered by at least 5 years.		
Testing For Acceptance	Before receiving the circuit breakers (breakers), customers may perform the tests maybe necessary to ensure compliance with the technical specifications.		
Packing	We are sure the packaging withstand any adverse conditions during transport and handling to the cellars of the Company. Carton or Pallet		
Dial Century, Year, Month and Batch	In one of its sides the breaker is marked with the symbol permanent ink, year, month and batch.		
Catalog	available		
Shows	Submit sample of the product offered		
Technical Warranty	2 YEARS		
Place of Delivery	CIF CNF FOB		
Delivery	25 Days		

# Miniature Circuit Breaker



MEBA ELECTRIC  
ENTERPRISES.

## MB52 Miniature Circuit Breaker

### Specification needs:

Product Details	Manufacturer: Meba ElectricEnterprises		
	Country of Origin: China		
	Brand: Meba		
	Model: MB52 MCB		
Manufacturing Standards	IEC 60898 IEC60947		
Tropicalization	Relative Humidity	°C	93% RH at 25°C
	Room Temperature	°C	10°C a 60°C
Electrical Properties	Rated at 40°C	A	6/10/16/20/25/32/40/50/63
	Rated operating voltage at 40°C	Vac	240/415
	Nominal Frequency	Hz	50/60
	Interrupting Capacity at 230V	kA	6
	Operating temperature	°C	40
	Degree of Protection		IP20
	Number of poles		1/2/3/4
	Conductor cross section (minimum allowable)	mm <sup>2</sup>	25
	Minimum number of power moves		4000
	Minimum number of mechanical operations		10000
	Operation curve		B/C/D
	Current Trip Curve	A	5 a 10 In
	Characteristic Intervention		attach
Type of Assembly	FOR RIEL DIN 35 mm		
Operation Indicator Window	The circuit breaker have an operating window color display that shows the state in which it is ( connected or disconnected ).		
Features	MAGNETIC COIL: ensures the switching of short-circuit, speaking within the following ranges: 5 to 10 times rated current ( Type C ), 3 to 5 times rated current ( Type B ), 10 to 20 times rated current ( Type D )		
	BIMETAL: ensures the breaker trip when overloaded.		
	ARC CHAMBER: effectively dissipates the electric arc that is generated by the opening contacts of the trigger mechanism in the presence of an overload or short circuit.		
Present Certificates	CE CB		
	ISO 9001-2000 awarded by the competent certification body, Meba is qualified in the manufacturing of the object		
	IEC 60898 standards in the manufacture of the goods		
	Curve compliance issued Shot by an accredited laboratory for effect		
Testing For Acceptance	Life, given by Meba to ensure that the life of the goods offered by at least 15 years.		
	Before receiving the circuit breakers (breakers), customers may perform the tests maybe necessary to ensure compliance with the technical specifications.		
Packing	The packaging is sure that withstand any adverse conditions during trans port and handling to the warehouse of customers		
Dial Century, Year, Month and Batch	In one of its sides the breaker is marked with permanent ink, year, month and batch.		
Catalog	Attach catalogs indicating the technical specification		
Shows	Submit sample of the product offered		
Technical Warranty	2 YEARS		
Place of Delivery	FOB & CNF		
Delivery	25 Days		



www.mebamfg.com

# Miniature Circuit Breaker

## MB52 Miniature Circuit Breaker

### Charcteristic Curve:

B type

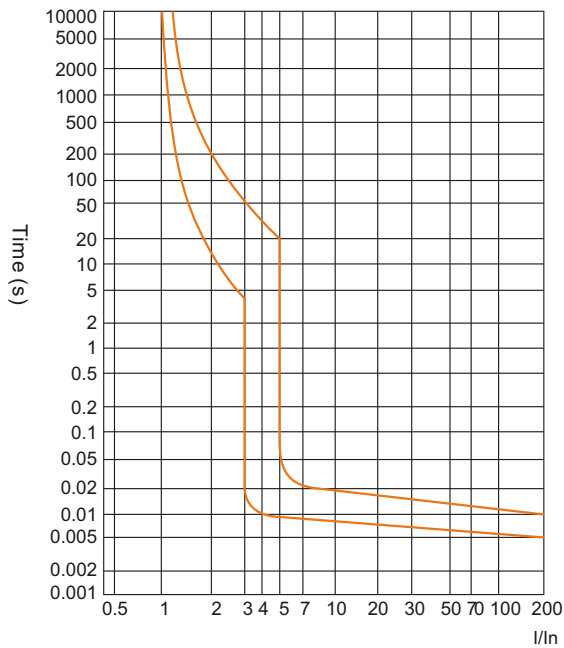

D type

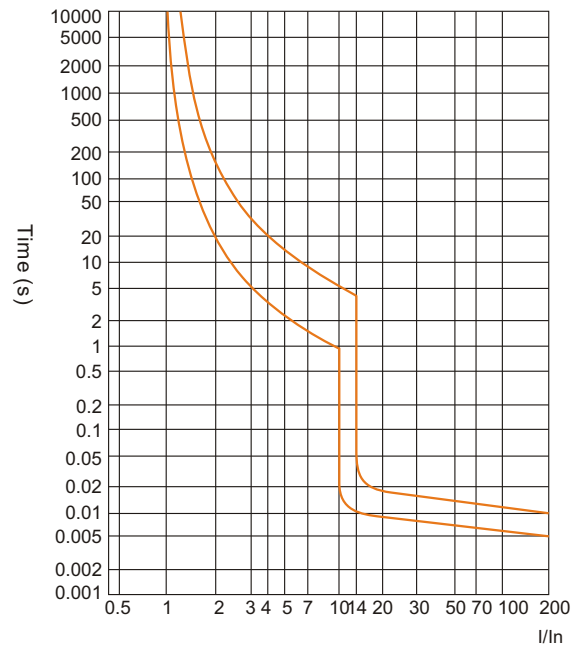

C type

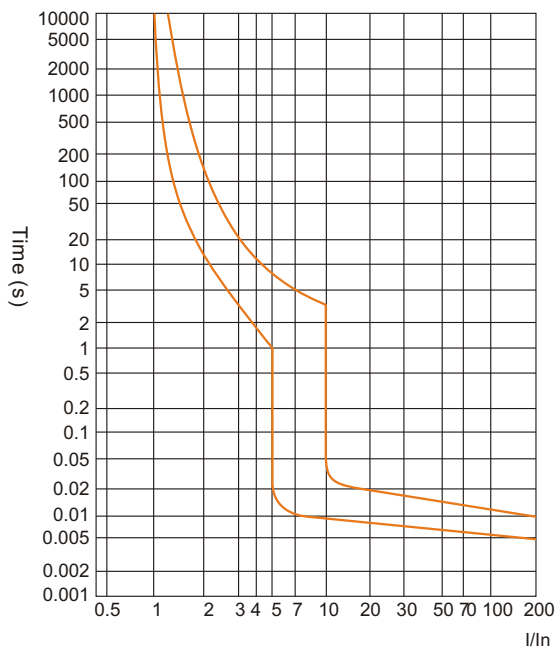

### Dimension(mm):

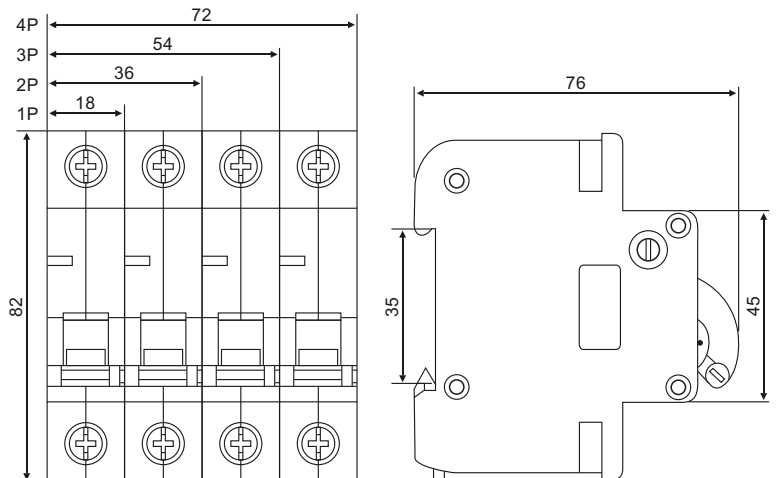

# Miniature Circuit Breaker



MEBA ELECTRIC  
ENTERPRISES.

## MBB8-63-1P/2P Miniature Circuit Breaker

### MBB8-63-1P/2P mini circuit breaker

- Function: overload and short-circuit protection
- Poles: 1P, 2P, 3P, 4P
- Current rate: 1-63A

#### Applications:

The product is mainly used in AC50/60HZ single-pole 230V or two, three, four-pole 400V circuit for overload and short-circuit protection as well as for unfrequent on-and-off switching electric equipment and lighting circuit under normal condition. The product is suitable for industry, business, building, residence, etc. It is conformity with GB10963, IEC60898 standards.

#### Features:

- Much higher short circuit breaking capacity.
- Dual-connection convenient for both standard busbar and conductor connection.
- Improved safety of operators offered by special design of terminals.
- Much longer service life thanks to energy storage operating mechanism.
- A variety of modular auxiliaries allows for easy and quick installation.
- Enclosure and functional parts made of advanced plastics with flame-retardant, heat-resistant and impulse-proof properties.
- Higher current-limiting capacity ensuring a cost-effective range of products.

#### Technical parameter:

- Rated current: 1A, 2A, 3A, 4A, 6A, 10A, 16A, 20A, 25A, 32A, 40A, 50A, 63A.
- Tripping characteristics: B(3-5)In; C(5-10)In; D(10-15)In.
- No. of pole: 1p, 2p, 3p, 4p.
- Breaking capacity (see table 1).

Rated current (A)	Pole	Rated Voltage (V)	Rated short-circuit breaking current (A)	COS
1~63	1	230, 230/400	6000	0.7
	2,3,4	400	6000	0.7

## MBB8-63-3P/4P Miniature Circuit Breaker

### MBB8-63-3P/4P mini circuit breaker

- Function: overload and short-circuit protection
- Poles: 1P, 2P, 3P, 4P
- Current rate: 1-63A

#### Applications:

The product is mainly used in AC50/60HZ single-pole 230V or two, three, four-pole 400V circuit for overload and short-circuit protection as well as for unfrequent on-and-off switching electric equipment and lighting circuit under normal condition. The product is suitable for industry, business, building, residence, etc. It is conformity with GB10963, IEC60898 standards.

#### Features:

- Much higher short circuit breaking capacity.
- Dual-connection convenient for both standard busbar and conductor connection.
- Improved safety of operators offered by special design of terminals.
- Much longer service life thanks to energy storage operating mechanism.
- A variety of modular auxiliaries allows for easy and quick installation.
- Enclosure and functional parts made of advanced plastics with flame-retardant, heat-resistant and impulse-proof properties.
- Higher current-limiting capacity ensuring a cost-effective range of products.

#### Technical parameter:

- Rated current: 1A, 2A, 3A, 4A, 6A, 10A, 16A, 20A, 25A, 32A, 40A, 50A, 63A.
- Tripping characteristics: B(3-5)In; C(5-10)In; D(10-15)In.
- No. of pole: 1p, 2p, 3p, 4p.
- Breaking capacity (see table 1).

Rated current (A)	Pole	Rated Voltage (V)	Rated short-circuit breaking current (A)	COS
1~63	1	230, 230/400	6000	0.7
	2,3,4	400	6000	0.7



www.mebamfg.com

# Miniature Circuit Breaker

## MBB47 Miniature Circuit Breaker

### Features and Applications:

The product is mainly used in AC50/60HZ single-pole 230V or two, three, four-poles 400V circuit for overload and short-circuit protection as well as for unfrequent on-and-off switching electric equipment and lighting circuit under normal condition. It can be used in lighting and electric motor distribution system. It is characterized with novel structure, light weight, reliable and excellent performance, high breaking capacity. It is conformity with GB10963, IEC 60898 standards.

### Specification needs:

Product Details	Manufacturer: Meba ElectricEnterprises				
	Country of Origin: China				
	Brand: Meba				
	Model: MBB47				
Manufacturing Standards	IEC 60898 IEC60947				
Tropicalization	Relative Humidity	℃	93% RH at 25℃		50% RH at 40℃
	Room Temperature	℃	-5℃ a 40℃		
Electrical Properties	Rated at 40℃	A	1/2/3/4/5/6/10/16/20/25/32/40/50/63		
	Rated operating voltage at 40℃	Vac	240/415		
	Nominal Frequency	Hz	50/60		
	Interrupting Capacity at230V	kA	6		
	Operating temperature	℃	40		
	Degree of Protection		IP20		
	Number of poles		1/2/3/4		
	Conductor cross section (minimum allowable)	mm²	25		
	Minimum number of power moves		4000		
	Minimum number of mechanical operations		8000		
	Operation curve		B/C/D		
	Current Trip Curve	A	Type B: 3 a 5 In	Type C: 5 a 10 In	Type D: 10 a 14 In
	Characteristic Intervention		attach		
Type of Assembly	FOR RIEL DIN 35 mm				
Features	MAGNETIC COIL: ensures the switching of short-circuit, speaking within the following ranges: 5 to 10 times rated current ( Type C ), 3 to 5 times rated current ( Type B ), 10 to 14 times rated current ( Type D )				
	BIMETAL: ensures the breaker trip when overloaded.				
	ARC CHAMBER: effectively dissipates the electric arc that is generated by the opening contacts of the trigger mechanism in the presence of an overload or short circuit.				
Present Certificates	CE CB				
	ISO 9001-2000 awarded by the competent certification body, Meba is qualified in the manufacturing of the object				
	IEC 60898 standards in the manufacture of the goods				
	Curve compliance issued Shot by an accredited laboratory for effect				
Testing For Acceptance	Life, given by Meba to ensure that the life of the goods offered by at least 15 years.				
	Before receiving the circuit breakers (breakers), customers may perform the tests maybe necessary to ensure compliance with the technical specifications.				
Packing	The packaging is sure that withstand any adverse conditions during transport and handling to the warehouse of customers				
Dial Century, Year, Month and Batch	In one of its sides the breaker is marked with permanent ink, year, month and batch.				
Catalog	Attach catalogs indicating the technical specification				
Shows	Submit sample of the product offered				
Technical Warranty	2 YEARS				
Place of Delivery	FOB & CNF				
Delivery	25 Days				

# Miniature Circuit Breaker



MEBA ELECTRIC  
ENTERPRISES.

## MBB100 Miniature Circuit Breaker

### Specification needs:

Product Details	Manufacturer: Meba ElectricEnterprises				
	Country of Origin: China				
	Brand: Meba				
	Model: MBB100				
Manufacturing Standards	IEC60947				
Tropicalization	Relative Humidity	℃	93% RH at25℃		
	Room Temperature	℃	10℃ a 60℃		
Electrical Properties	Rated at 40℃	A	63/80/100		
	Rated operating voltage at 40℃	Vac	240/415		
	Nominal Frequency	Hz	50/60		
	Interrupting Capacity at230 V	kA	10		
	Operating temperature	℃	40		
	Degree of Protection		IP20		
	Number of poles		1,2,3,4		
	Conductor cross section (minimum allowable)	mm²	63A/16	80A/25	100A/35
	Minimum number ofpower moves		4000		
	Minimum number ofmechanical operations		8000		
	Operation curve		C/D		
	Current Trip Curve	A	Type C 5 a 10 In	Type D 10 a 14 In	
	Characteristic Intervention		attach		
	Type of Assembly	FOR RIEL DIN 35 mm			
Operation Indicator Window	The circuit breakerhave an operating window color displaythat shows thestate in which it is (connected or disconnected ).				
Features	MAGNETIC COIL: ensures the switching of short-circuit, speaking within the following ranges: 5 to 10 times rated current( TypeC ), 10 to 14 times rated current ( Type D )				
	BIMETAL: ensures the breaker trip when overloaded.				
	ARC CHAMBER: effectivelydissipates the electric arc that is generated by the opening contacts of the trigger mechanism in the presence of an overload or short circuit.				
Present Certificates	CE CB				
	ISO9001-2000 awarded by the competent certification body, Meba is qualified in the manufacturing of the object				
	IEC 60898 standards in the manufacture of the goods				
	Curve compliance issued Shot by an accredited laboratory for effect				
Testing For Acceptance	Life, given by Meba to ensure that the life of the goods offered by at least 15 years.				
	Before receiving the circuit breakers (breakers), customers may perform the tests maybe necessary to ensure compliance with the technical specifications.				
Packing	The packaging is sure that withstand any adverse conditions during transport and handling to the warehouse of customers				
Dial Century, Year, Month and Batch	In one of its sides the breaker is marked with permanent ink, year, month and batch.				
Catalog	Attach catalogs indicating the technical specification				
Shows	Submit sample of the product offered				
Technical Warranty	2 YEARS				
Place of Delivery	FOB & CNF				
Delivery	25 Days				



www.mebamfg.com

## Miniature Circuit Breaker

### MBB100 Miniature Circuit Breaker

#### The over-current protection property:

Ambient Temperature	Initial Status	Test Current	Expected Result	Expected Result	NOte
40 ± 2℃	Cold position	1.05In (In ≤ 63A)	t ≤ 1h	Non-release	-
	Cold position	1.05In (In > 63A)	t ≤ 2h	Non-release	-
	Carried out immediately after previous test	1.30In (In ≤ 63A)	t < 1h	Release	Current smoothly rises to specified value within 5s
		1.30In (In > 63A)	t < 2h	Release	
-5 ~ +40℃	Cold position	8.00In	t ≤ 0.2s	Non-release	-
	Cold position	12.00In	t < 0.2s	Non-release	-

#### Dimension(mm):

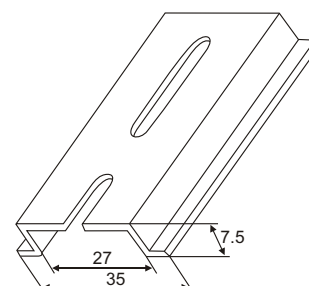
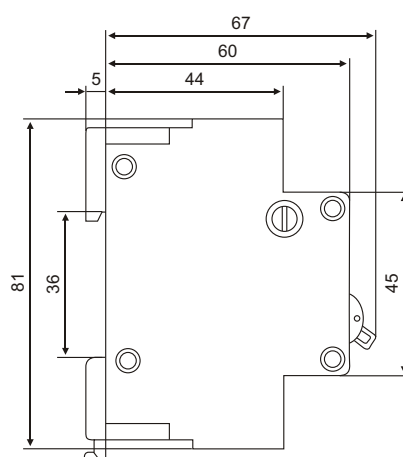
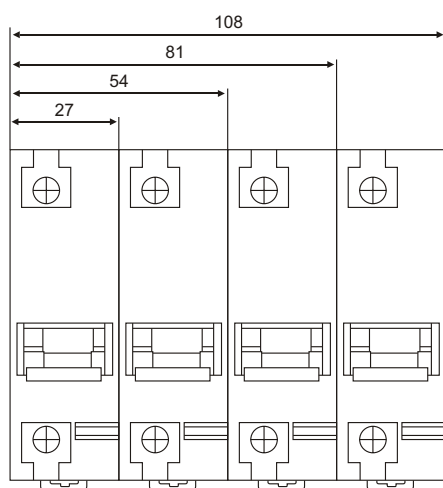

### NC100H-1P Miniature Circuit Breaker

#### Features and Applications:

NC100H mini circuit breaker, mcb

- Character: high breaker capacity up to 10KA
- 40-100A current available
- Poles: 1P, 2P, 3P, 4P.

NC100H high breaking capacity circuit breaker is used for AC 50Hz or 60Hz, single pole 240V, 2, 3, 4 Poles 415, for protecting the circuit that overload and short circuit may take place. It can be used in lighting and electric motor distribution system. Meanwhile it is applicable to an unfrequent switch over the electric apparatus and lighting circuit under normal condition. Breaking capacity is up to standard of IEC 947-7 10KA.

#### Technical parameter:

Rated current (A)	Pole number (P)	Rated voltage (V)	Breaking capacity (A)
40, 50, 63, 80, 100	1	130	20000
		230/240	10000
		400/415	4000
	2, 3, 4	230/240	20000
		400/415	10000
		440	6000

# Miniature Circuit Breaker



MEBA ELECTRIC  
ENTERPRISES.

## NC100H-2P Miniature Circuit Breaker

### Features and Applications:

NC100H mini circuit breaker, mcb

- Character: high breaker capacity up to 10KA
- 40-100A current available
- Poles: 1P, 2P, 3P, 4P.

NC100H high breaking capacity circuit breaker is used for AC 50Hz or 60Hz, single pole 240V, 2, 3, 4 Poles 415, for protecting the circuit that overload and short circuit may take place. It can be used in lighting and electric motor distribution system. Meanwhile it is applicable to an unfrequent switchover the electric apparatus and lighting circuit under normal condition. Breaking capacity is up to standard of IEC947-7 10KA.

### Technical parameter:

Rated current (A)	Pole number (P)	Rated voltage (V)	Breaking capacity (A)
40, 50, 63, 80, 100	1	130	20000
		230/240	10000
		400/415	4000
	2, 3, 4	230/240	20000
		400/415	10000
		440	6000

## NC100H-3P Miniature Circuit Breaker

### Features and Applications:

NC100H mini circuit breaker, mcb

- Character: high breaker capacity up to 10KA
- 40-100A current available
- Poles: 1P, 2P, 3P, 4P.

NC100H high breaking capacity circuit breaker is used for AC 50Hz or 60Hz, single pole 240V, 2, 3, 4 Poles 415, for protecting the circuit that overload and short circuit may take place. It can be used in lighting and electric motor distribution system. Meanwhile it is applicable to an unfrequent switchover the electric apparatus and lighting circuit under normal condition. Breaking capacity is up to standard of IEC947-7 10KA.

### Technical parameter:

Rated current (A)	Pole number (P)	Rated voltage (V)	Breaking capacity (A)
40, 50, 63, 80, 100	1	130	20000
		230/240	10000
		400/415	4000
	2, 3, 4	230/240	20000
		400/415	10000
		440	6000





www.mebamfg.com

# Miniature Circuit Breaker

## MBGV4 Miniature Circuit Breaker

### Specification needs:

Product Details	Manufacturer: Meba ElectricEnterprises				
	Country of Origin: China				
	Brand: Meba				
	Model: MBGV4				
Manufacturing Standards	IEC 60898 IEC60947				
Tropicalization	Relative Humidity	℃	93% RH at25℃	50% RH at 40℃	
	Room Temperature	℃	-5℃ a 40℃		
Electrical Properties	Rated at 40℃	A	6/10/16/20/25/32/40/50/63		
	Rated operating voltage at 40℃	Vac	240/415		
	Nominal Frequency	Hz	50/60		
	Interrupting Capacity at 230V	kA	6		
	Operating temperature	℃	-5℃ a 40℃		
	Degree of Protection		IP20		
	Number of poles		1/2/3/4		
	Conductor cross section (minimum allowable)	mm²	25		
	Minimum number of power moves		4000		
	Minimum number of mechanical operations		8000		
	Operation curve		B/C/D		
	Current Trip Curve	A	Type B : 3 a 5 In	Type C : 5 a 10 In	Type D: 10 a 14 In
	Characteristic Intervention		attach		
Type of Assembly	FOR RIEL DIN 35 mm				
Features	MAGNETIC COIL: ensures the switching of short-circuit, speaking within the following ranges: 5 to 10 times rated current (Type C), 3 to 5 times rated current ( Type B ), 10 to 14 times rated current ( Type D )				
	BIMETAL: ensures the breaker trip when overloaded.				
	ARC CHAMBER: effectively dissipates the electric arc that is generated by the opening contacts of the trigger mechanism in the presence of an overload or short circuit.				
Present Certificates	CE CB				
	ISO9001-2000 awarded by the competent certification body, Meba is qualified in the manufacturing of the object				
	IEC 60898 standards in the manufacture of the goods				
	Curve compliance issued Shot by an accredited laboratory for effect				
	Life, given by Meba to ensure that the life of the goods offered by at least 15 years.				
Testing For Acceptance	Before receiving the circuit breakers (breakers), customers may perform the tests maybe necessary to ensure compliance with the technical specifications.				
Packing	The packaging is sure that withstand any adverse conditions during transport and handling to the warehouse of customers				
Dial Century, Year, Month and Batch	In one of its sides the breaker is marked with permanent ink, year, month and batch.				
Catalog	Attach catalogs indicating the technical specification				
Shows	Submit sample of the product offered				
Technical Warranty	2 YEARS				
Place of Delivery	FOB & CNF				
Delivery	25 Days				

# Miniature Circuit Breaker



MEBA ELECTRIC  
ENTERPRISES.

## MBH6 Miniature Circuit Breaker

### Applications:

Protection and control of circuit against overload and short circuit, in building installation-such as houses, offices, commercial complex, motor system (D curve) and industrial installation-for switching, control, protection and regulation of electrical circuits. Also in switchgear panels, railway and marine application.

### Specification needs:

Product Details	Manufacturer: Meba ElectricEnterprises				
	Country of Origin: China				
	Brand: Meba				
	Model: MBH6				
Manufacturing Standards	IEC 60898 IEC60947				
Tropicalization	Relative Humidity	℃	93% RH at 25℃		50% RH at 40℃
	Room Temperature	℃	-5℃ a 40℃		
Electrical Properties	Rated at 40℃	A	6/10/16/20/25/32/40/50/63		
	Rated operating voltage at 40℃	Vac	240/415		
	Nominal Frequency	Hz	50/60		
	Interrupting Capacity at 230V	kA	6		
	Operating temperature	℃	-5℃ a 40℃		
	Degree of Protection		IP20		
	Number of poles		1/2/3/4		
	Conductor cross section (minimum allowable)	mm²	25		
	Minimum number of power moves		4000		
	Minimum number of mechanical operations		8000		
	Operation curve		B/C/D		
	Current Trip Curve	A	Type B: 3 a 5 In	Type C: 5 a 10 In	Type D: 10 a 14 In
	Characteristic Intervention		attach		
	Type of Assembly	FOR RIEL DIN 35mm			
Features	MAGNETIC COIL: ensures the switching of short-circuit, speaking within the following ranges: 5 to 10 times rated current (Type C), 3 to 5 times rated current ( Type B ), 10 to 14 times rated current ( Type D )				
	BIMETAL: ensures the breaker trip when overloaded.				
	ARC CHAMBER: effectively dissipates the electric arc that is generated by the opening contacts of the trigger mechanism in the presence of an overload or short circuit.				
Present Certificates	CE CB				
	ISO 9001-2000 awarded by the competent certification body, Meba is qualified in the manufacturing of the object				
	IEC 60898 standards in the manufacture of the goods				
	Curve compliance issued Shot by an accredited laboratory for effect				
Testing For Acceptance	Life, given by Meba to ensure that the life of the goods offered by at least 15 years.				
	Before receiving the circuit breakers (breakers) , customers may perform the tests may be necessary to ensure compliance with the technical specifications.				
Packing	The packaging is sure that withstand any adverse conditions during transport and handling to the warehouse of customers				
Dial Century, Year, Month and Batch	In one of its sides the breaker is marked with permanent ink, year, month and batch.				
Catalog	Attach catalogs indicating the technical specification				
Shows	Submit sample of the product offered				
Technical Warranty	2 YEARS				
Place of Delivery	FOB & CNF				
Delivery	25 Days				



www.mebamfg.com

# Miniature Circuit Breaker

## MBHVS-3D Isolator

### Applications:

- Capable of switch electric circuit with load
- Provide function of isolation
- Contact position indication
- Used as main switch for household and similar installation

### Specification needs:

Product Details	Manufacturer: Meba Electric Enterprises		
	Country of Origin: China		
	Brand: Meba		
	Model: MBHVS Isolator		
Manufacturing Standards	IEC 60947-3		
Tropicalization	Relative Humidity	°C	93% RH at 25°C
	Room Temperature	°C	-5°C a 40°C
Electrical Properties	Rated at 40°C	A	6/16/20/25/32/40/50/63/80/100
	Rated operating voltage at 40°C	Vac	240/415
	Nominal Frequency	Hz	50/60
	Interrupting Capacity	kA	4.5/6
	Operating temperature	°C	-5°C a 40°C
	Degree of Protection		IP20
	Number of poles		1/2/3/4
	Conductor cross section (minimum allowable)	mm <sup>2</sup>	25
	Minimum number of power moves		4000
	Minimum number of mechanical operations		8000
	Operation curve		/
	Current Trip Curve	A	/
	Characteristic Intervention		attach
Type of Assembly	FOR RIEL DIN 35mm		
Present Certificates	CE		
	ISO 9001-2000		
	IEC 60947-3 standards		
	Life, given by us to ensure that the life of the goods offered by at least 5 years.		
Testing For Acceptance	Before receiving the circuit breakers (breakers), customers may perform the tests maybe necessary to ensure compliance with the technical specifications.		
Packing	We are sure the packaging withstand any adverse conditions during transport and handling to the cellars of the Company. Carton or Pallet		
Dial Century, Year, Month and Batch	In one of its sides the breaker is marked with the symbol permanent ink, year, month and batch.		
Catalog	available		
Shows	Submit sample of the product offered		
Technical Warranty	2 YEARS		
Place of Delivery	CIF CNF FOB		
Delivery	25 Days		

# Miniature Circuit Breaker



MEBA ELECTRIC  
ENTERPRISES.

## MBHVS Isolator

### Specification needs:

Product Details	Manufacturer: Meba Electric Enterprises		
	Country of Origin: China		
	Brand: Meba		
	Model: MBHVS Isolator		
Manufacturing Standards	IEC 60947-3		
Tropicalization	Relative Humidity	°C	93% RH at 25°C
	Room Temperature	°C	-5°C a 40°C
Electrical Properties	Rated at 40°C	A	6/16/20/25/32/40/50/63/80/100
	Rated operating voltage at 40°C	Vac	240/415
	Nominal Frequency	Hz	50/60
	Interrupting Capacity	kA	4.5/6
	Operating temperature	°C	-5°C a 40°C
	Degree of Protection		IP20
	Number of poles		1/2/3/4
	Conductor cross section (minimum allowable)	mm <sup>2</sup>	25
	Minimum number of power moves		4000
	Minimum number of mechanical operations		8000
	Operation curve		/
	Current Trip Curve	A	/
	Characteristic Intervention		attach
Type of Assembly	FOR RIEL DIN 35mm		
Present Certificates	CE		
	ISO 9001-2000		
	IEC 60947-3 standards		
	Life, given by us to ensure that the life of the goods offered by at least 5 years.		
Testing For Acceptance	Before receiving the circuit breakers (breakers), customers may perform the tests may be necessary to ensure compliance with the technical specifications.		
Packing	We are sure the packaging withstand any adverse conditions during transport and handling to the cellars of the Company. Carton or Pallet		
Dial Century, Year, Month and Batch	In one of its sides the breaker is marked with the symbol permanent ink, year, month and batch.		
Catalog	available		
Shows	Submit sample of the product offered		
Technical Warranty	2 YEARS		
Place of Delivery	CIF CNF FOB		
Delivery	25 Days		



www.mebamfg.com

# Miniature Circuit Breaker

## MBHVS Isolator

### Applications:

- Capable of switch electric circuit with load
- Provide function of isolation
- Contact position indication
- Used as main switch for household and similar installation

### Overall & Installation Dimensions:

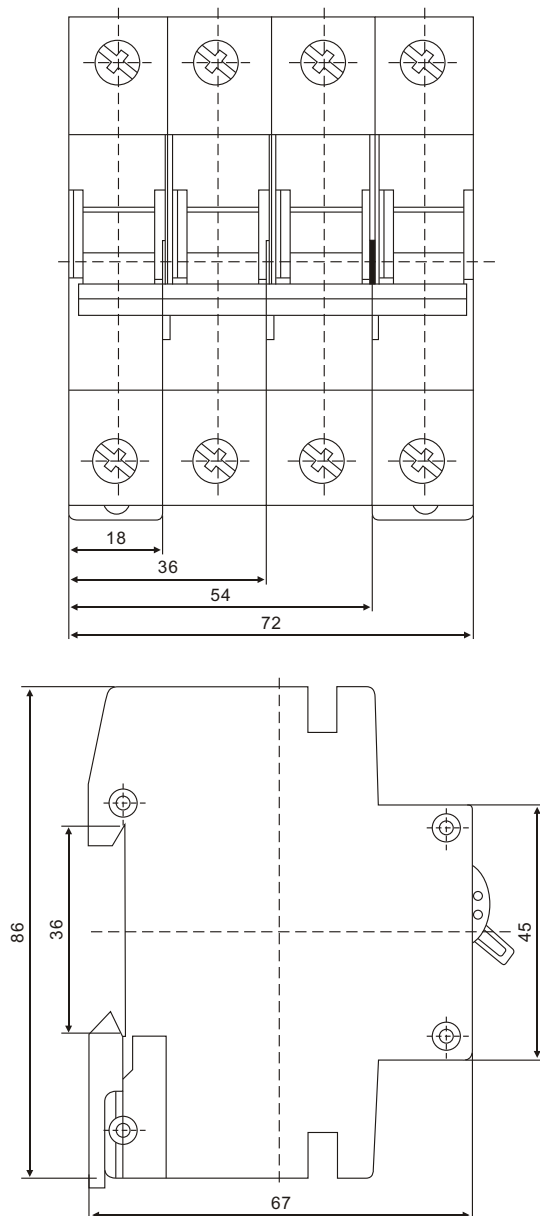

## MBHVS Miniature Circuit Breaker

### Applications:

Protection and control of circuit against overload and short circuit, in building installation-such as houses, offices, commercial complex, motor system(D curve) and industrial installation-for switching, control, protection and regulation of electrical circuits. Also in switchgear panels, railway and marine application.

### Overall & Installation Dimensions:

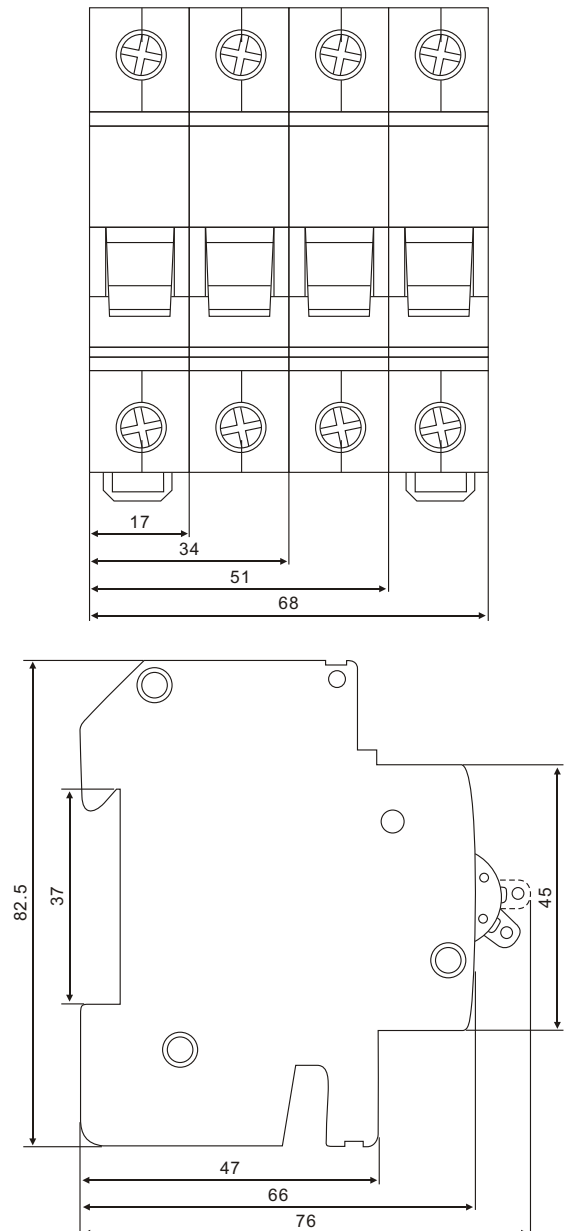

# Miniature Circuit Breaker



MEBA ELECTRIC  
ENTERPRISES.

## MBHVS Miniature Circuit Breaker

### Specification needs:

Product Details	Manufacturer: Meba Electric Enterprises				
	Country of Origin: China				
	Brand: Meba				
	Model: MBHVS				
Manufacturing Standards	IEC 60898 IEC60947				
Tropicalization	Relative Humidity	°C	93% RH at 25°C	50% RH at 40°C	
	Room Temperature	°C	-5°C a 40°C		
Electrical Properties	Rated at 40°C	A	6/10/16/20/25/32/40/50/63		
	Rated operating voltage at 40°C	Vac	240/415		
	Nominal Frequency	Hz	50/60		
	Interrupting Capacity at 230V	kA	6		
	Operating temperature	°C	-5°C a 40°C		
	Degree of Protection		IP20		
	Number of poles		1/2/3/4		
	Conductor cross section (minimum allowable)	mm²	25		
	Minimum number of power moves		4000		
	Minimum number of mechanical operations		8000		
	Operation curve		B/C/D		
	Current Trip Curve	A	Type B : 3 a 5 In	Type C : 5 a 10 In	Type D: 10 a 14 In
	Characteristic Intervention		attach		
Type of Assembly	FOR RIEL DIN 35mm				
Features	MAGNETIC COIL: ensures the switching of short-circuit, speaking within the following ranges: 5 to 10 times rated current (Type C), 3 to 5 times rated current (Type B), 10 to 14 times rated current (Type D)				
	BIMETAL: ensures the breaker trip when overloaded.				
	ARC CHAMBER: effectively dissipates the electric arc that is generated by the opening contacts of the trigger mechanism in the presence of an overload or short circuit.				
Present Certificates	CE				
	ISO 9001-2000 awarded by the competent certification body, Meba is qualified in the manufacturing of the object				
	IEC 60898 standards in the manufacture of the goods				
	Curve compliance issued Shot by an accredited laboratory for effect				
	Life, given by Meba to ensure that the life of the goods offered by at least 15 years.				
Testing For Acceptance	Before receiving the circuit breakers (breakers), customers may perform the tests maybe necessary to ensure compliance with the technical specifications.				
Packing	The packaging is sure that withstand any adverse conditions during transport and handling to the warehouse of customers				
Dial Century, Year, Month and Batch	In one of its sides the breaker is marked with permanent ink, year, month and batch.				
Catalog	Attach catalogs indicating the technical specification				
Shows	Submit sample of the product offered				
Technical Warranty	2 YEARS				
Place of Delivery	FOB & CNF				
Delivery	25 Days				



www.mebamfg.com

# Miniature Circuit Breaker

## MB162-1P/3P Isolator Miniature Circuit Breaker

### Specification needs:

Product Details	Manufacturer: Meba ElectricEnterprises		
	Country of Origin: China		
	Brand: Meba		
	Model: MB162		
Manufacturing Standards	IEC 60947-3		
Tropicalization	Relative Humidity	°C	93% RH at 25°C
	Room Temperature	°C	-5°C a 40°C
Electrical Properties	Rated at 40°C	A	63/80/100/125
	Rated operating voltage at 40°C	Vac	240/415
	Nominal Frequency	Hz	50/60
	Interrupting Capacity	kA	3
	Operating temperature	°C	-5°C a 40°C
	Degree of Protection		IP20
	Number of poles		1/2/3/4
	Conductor cross section (minimum allowable)	mm <sup>2</sup>	25
	Minimum number of power moves		4000
	Minimum number of mechanical operations		8000
	Operation curve		/
	Current Trip Curve	A	/
	Characteristic Intervention		attach
Type of Assembly	FOR RIEL DIN 35mm		
Present Certificates	CE		
	ISO 9001-2000		
	IEC 60947-3 standards		
	Life, given by us to ensure that the life of the goods offered by atleast 5 years.		
Testing For Acceptance	Before receiving the circuit breakers (breakers), customers may perform the tests maybe necessary to ensure compliance with the technical specifications.		
Packing	We are sure the packaging withstand any adverse conditions during transport and handling to the cellars of the Company. Carton or Pallet		
Dial Century, Year, Month and Batch	In one of its sides the breaker is marked with the symbol permanent ink, year, month and batch.		
Catalog	available		
Shows	Submit sample of the product offered		
Technical Warranty	2 YEARS		
Place of Delivery	CIF CNF FOB		
Delivery	25 Days		

# Miniature Circuit Breaker



MEBA ELECTRIC  
ENTERPRISES.

## MB162-1P/3P Isolator Miniature Circuit Breaker

### Applications:

MB162 is majorused as mains switch in distribution box, control on or off for all branch switch. The product is applicable to circuit with rated voltage 230/400VAC, 50Hz for power distribution and motor operation as switching disconnecter in both household & commercial and electric equipments installations. The product, free of maintenance, is suitable for use by non-professionals. The product is switched on when the handle is at upper position.

### Overall and mounting dimensioned chart:

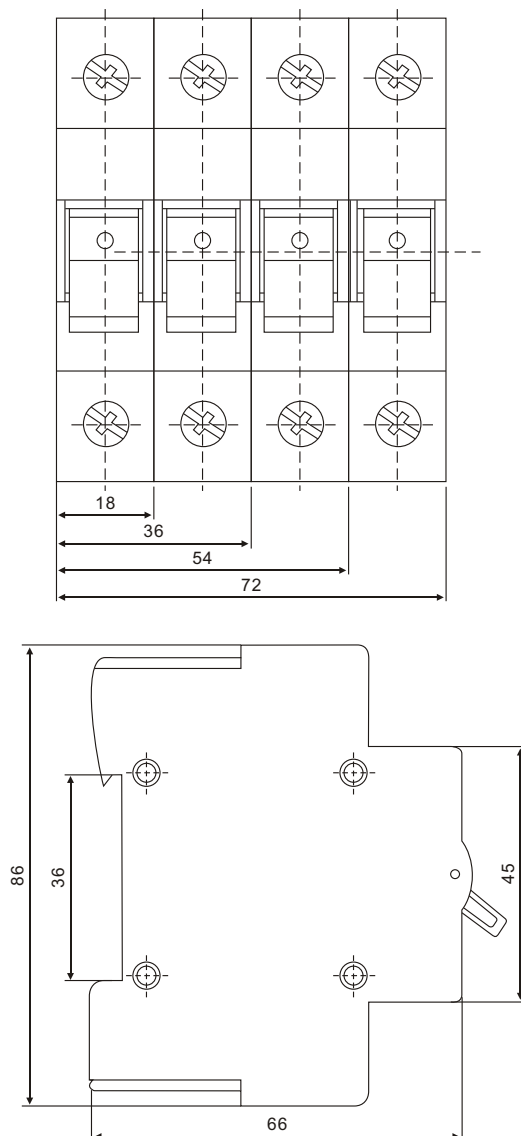

## MBDR047 Delay Relay

### Application:

MBDR047 is one kind of timer relay, used in distribution box with MCB, Isolator, Surge Arrester together. Rated voltage(V): 220-415.

### Overall & Installation Dimensions:

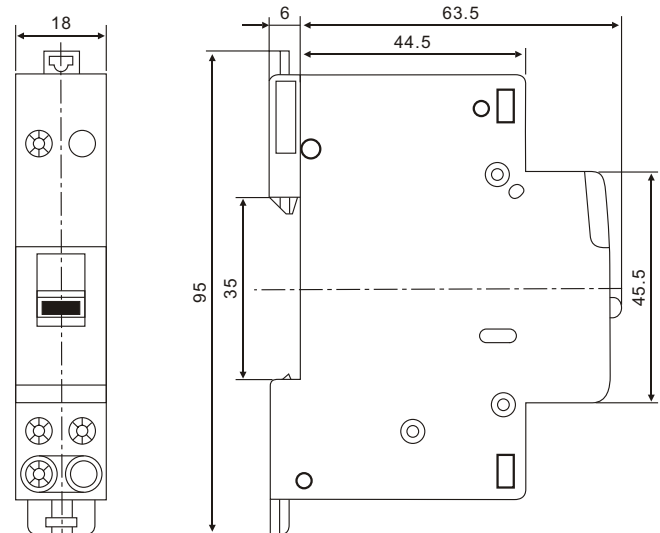





www.mebamfg.com

# Miniature Circuit Breaker

## MBDPE06 Miniature Circuit Breaker

### Specification needs:

Product Details	Manufacturer: Meba ElectricEnterprises		
	Country of Origin: China		
	Brand: Meba		
	Model: MBDPE		
Manufacturing Standards	IEC 60898 IEC60947		
Tropicalization	Relative Humidity	°C	93% RH at25°C
	Room Temperature	°C	10°C a 60°C
Electrical Properties	Rated at 40°C	A	1/2/3/4/6/10/16/20/25/32/40/50/63
	Rated operating voltage at 40°C	Vac	240/415
	Nominal Frequency	Hz	50/60
	Interrupting Capacity at230 V	kA	6
	Operating temperature	°C	-5°C a 40°C
	Degree of Protection		IP20
	Number of poles		1/2/3/4
	Conductor cross section (minimum allowable)	mm <sup>2</sup>	25
	Minimum number of power moves		4000
	Minimum number of mechanical operations		10000
	Operation curve		B/C/D
	Current Trip Curve C	A	5 a 10 In
	Characteristic Intervention		attach
Type of Assembly	FOR RIEL DIN 35 mm		
Operation Indicator Window	The circuit breaker have an operating window color display that shows the state in which it is ( connected or disconnected ).		
Features	MAGNETIC COIL: ensures the switching of short-circuit, speaking within the following ranges: 5 to 10 times rated current ( Type C ), 3 to 5 times rated current ( Type B ), 10 to 14 times rated current ( Type D )		
	BIMETAL: ensures the breaker trip when overloaded.		
	ARC CHAMBER: effectively dissipates the electric arc that is generated by the opening contacts of the trigger mechanism in the presence of an overload or short circuit.		
Present Certificates	CE CB		
	ISO 9001-2000 awarded by the competent certification body, Meba is qualified in the manufacturing of the object		
	IEC 60898 standards in the manufacture of the goods		
	Curve compliance issued Shot by an accredited laboratory for effect		
Testing For Acceptance	Life, given by Meba to ensure that the life of the goods offered by at least 15 years.		
	Before receiving the circuit breakers (breakers), customers may perform the tests maybe necessary to ensure compliance with the technical specifications.		
Packing	The packaging is sure that withstand any adverse conditions during transport and handling to the warehouse of customers		
Dial Century, Year, Month and Batch	In one of its sides the breaker is marked with permanent ink, year, month and batch.		
Catalog	Attach catalogs indicating the technical specification		
Shows	Submit sample of the product offered		
Technical Warranty	2 YEARS		
Place of Delivery	FOB & CNF		
Delivery	25 Days		

# Miniature Circuit Breaker



MEBA ELECTRIC  
ENTERPRISES.

## MBJ6 Miniature Circuit Breaker

### Applications:

Protection and control of circuit against overload and short circuit, in building installation-such as houses, offices, commercial complex, motor system(D curve)and industrial installation-for switching, control, protection and regulation of electrical circuits. Also in switchgear panels, railway and marine application.

### Specification needs:

Product Details	Manufacturer: Meba ElectricEnterprises				
	Country of Origin: China				
	Brand: Meba				
	Model: MBJ6				
Manufacturing Standards	IEC 60898 IEC60947				
Tropicalization	Relative Humidity	℃	93% RH at 25℃		50% RH at 40℃
	Room Temperature	℃	-5℃ a 40℃		
Electrical Properties	Rated at 40℃	A	6/10/16/20/25/32/40/50/63		
	Rated operating voltage at 40℃	Vac	240/415		
	Nominal Frequency	Hz	50/60		
	Interrupting Capacity at 230V	kA	6		
	Operating temperature	℃	-5℃ a 40℃		
	Degree of Protection		IP20		
	Number of poles		1/2/3/4		
	Conductor cross section (minimum allowable)	mm²	25		
	Minimum number of power moves		4000		
	Minimum number of mechanical operations		8000		
	Operation curve		B/C/D		
	Current Trip Curve	A	Type B: 3 a 5 In	Type C: 5 a 10 In	Type D: 10 a 14 In
	Characteristic Intervention		attach		
Type of Assembly	FOR RIEL DIN 35mm				
Features	MAGNETIC COIL: ensures the switching of short-circuit, speaking within the following ranges: 5 to 10 times rated current ( Type C ), 3 to 5 times rated current ( Type B ), 10 to 14 times rated current( Type D )				
	BIMETAL: ensures the breaker trip when overloaded.				
	ARC CHAMBER: effectively dissipates the electric arc that is generated by the opening contacts of the trigger mechanism in the presence of an overload or short circuit.				
Present Certificates	CE CB				
	ISO 9001-2000 awarded by the competent certification body, Meba is qualified in the manufacturing of the object				
	IEC 60898 standards in the manufacture of the goods				
	Curve compliance issued Shot by an accredited laboratory for effect				
Testing For Acceptance	Life, given by Meba to ensure that the life of the goods offered by at least 15 years.				
	Before receiving the circuit breakers (breakers), customers may perform the tests maybe necessary to ensure compliance with the technical specifications.				
Packing	The packaging is sure that withstand any adverse conditions during transport and handling to the warehouse				
	of customers				
Dial Century, Year, Month and Batch	In one of its sides the breaker is marked with permanent ink, year, month and batch.				
Catalog	Attach catalogs indicating the technical specification				
Shows	Submit sample of the product offered				
Technical Warranty	2 YEARS				
Place of Delivery	FOB & CNF				
Delivery	25 Days				



www.mebamfg.com

# Miniature Circuit Breaker

## MBL7 Insulator

### Applications:

- Capable of switch electric circuit with load
- Provide function of isolation.
- Contact position indication.
- Used as main switch for household and simiar installation.

### Specification needs:

Product Details	Manufacturer: Meba ElectricEnterprises		
	Country of Origin: China		
	Brand: Meba		
	Model: MBL7 Insulator		
Manufacturing Standards	IEC 60947-3		
Tropicalization	Relative Humidity	°C	93% RH at25°C
	Room Temperature	°C	-5°C a 40°C
Electrical Properties	Rated at 40°C	A	6/16/20/25/32/40/50/63/80/100
	Rated operating voltage at 40°C	Vac	240/415
	Nominal Frequency	Hz	50/60
	Interrupting Capacity	kA	3/4.5
	Operating temperature	°C	-5°C a 40°C
	Degree of Protection		IP20
	Number of poles		1/2/3/4
	Conductor cross section (minimum allowable)	mm <sup>2</sup>	25
	Minimum number of power moves		4000
	Minimum number of mechanical operations		8000
	Operation curve		/
	Current Trip Curve	A	/
	Characteristic Intervention		attach
Type of Assembly	FOR RIEL DIN 35 mm		
Operation Indicator Window	The circuit breakerhave an operating window color display that shows the state in which it is (connected or disconnected).		
Present Certificates	CE		
	ISO 9001-2000		
	IEC 60947-3 standards		
	Life, given by us to ensure that the life of the goods offered by atleast 5 years.		
Testing For Acceptance	Before receiving the circuit breakers (breakers), customers may perform the tests maybe necessary to ensure compliance with the technical specifications.		
Packing	We are sure the packaging withstand any adverse conditions during transport and handling to the cellars of the Company. Carton or Pallet		
Dial Century, Year, Month and Batch	In one of its sides the breaker is marked with the symbol permanent ink, year, month and batch.		
Catalog	Available		
Shows	Submit sample of the product offered		
Technical Warranty	2 YEARS		
Place of Delivery	CIF CNF FOB		
Delivery	25 Days		

# Miniature Circuit Breaker



MEBA ELECTRIC  
ENTERPRISES.

## MBL7 Indicator

### Din Rail type LED Indicator, Neon Signal Lamp

#### Specification:

The DIN Rail type Modular Signal Lamp is applicable to circuit with rated voltage 230V AC, 50/60Hz for visual indication and signaling.

- Low service duration, minimum power consumption
- Compact design in modular size, easy installation
- Rated voltage: 230V AC, 50/60Hz
- Colour: Red, green, yellow
- Connection terminal: Pillar terminal with clamp
- Connection capacity: Rigid conductor 10mm<sup>2</sup>
- Installation: - On symmetrical DIN rail  
- Panel mounting
- Illumination type:
  - A. Illumination: LED
    - Max power: 0.6W
    - Service duration: 30,000 hours
  - B. Illumination: Neon bulb
    - Max power: 1.2W
    - Service duration: 15,000 hours

#### Overall & Installation Dimensions:

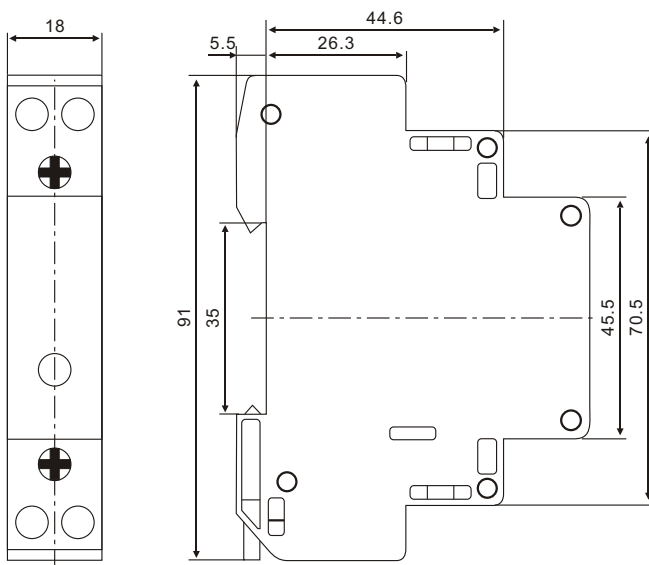

## MBL7 DPN

#### Applications:

MBL7 Series Miniature Circuit Breaker (hereinafter referred to as breaker) is the company's own research and development of new products, the products are reliable and accurate protection features, high breaking capacity, small size, is an ideal replacement product. Circuit breaker is mainly applied to 50Hz/60Hz, rated voltage 230V, rated operating current to 40A similar buildings and places of powerlines and electrical facilities, over-current protection devices, can be used for non-frequent on-off operation. The circuit breaker in line with IEC60898: 1995, GB10963-1999 "category for household and Current protection may place used circuit breakers" and other standards.

#### Shape and size of the installation of technology:

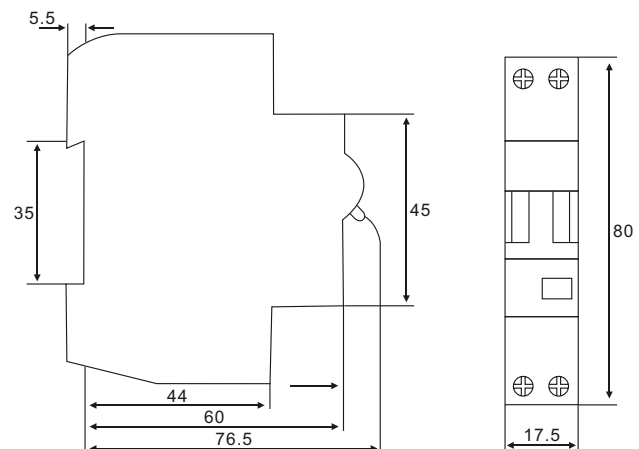

Trip Type		B	C	Trip Time
Thermal Trip	I1	1.13In	1.13In	≥1h
	I2	1.45In	1.45In	<1h
Magnetic Trip	I3	3In	3In	≥0.1s
	I4	5In	10In	<0.1s

# Miniature Circuit Breaker



MEBA ELECTRIC ENTERPRISES.

## MBL7 Indicator

### Din Rail type LED Indicator, Neon Signal Lamp

#### Specification:

The DIN Rail type Modular Signal Lamp is applicable to circuit with rated voltage 230V AC, 50/60Hz for visual indication and signaling.

- Low service duration, minimum power consumption
- Compact design in modular size, easy installation
- Rated voltage: 230V AC, 50/60Hz
- Colour: Red, green, yellow
- Connection terminal: Pillar terminal with clamp
- Connection capacity: Rigid conductor 10mm<sup>2</sup>
- Installation: - On symmetrical DIN rail  
- Panel mounting
- Illumination type:
  - A. Illumination: LED
    - Max power: 0.6W
    - Service duration: 30,000 hours
  - B. Illumination: Neon bulb
    - Max power: 1.2W
    - Service duration: 15,000 hours

#### Overall & Installation Dimensions:

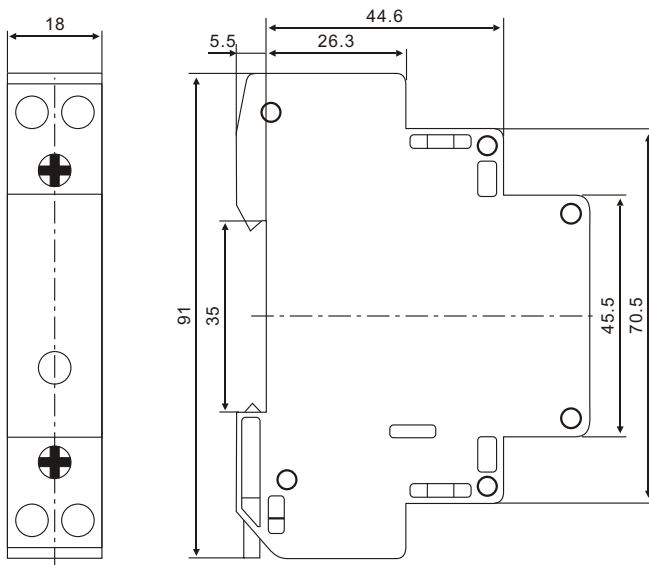

## MBL7 DPN

#### Applications:

MBL7 Series Miniature Circuit Breaker (hereinafter referred to as breaker) is the company's own research and development of new products, the products are reliable and accurate protection features, high breaking capacity, small size, is an ideal replacement product. Circuit breaker is mainly applied to 50Hz/60Hz, rated voltage 230V, rated operating current to 40A similar buildings and places of powerlines and electrical facilities, over-current protection devices, can be used for non-frequent on-off operation. The circuit breaker in line with IEC60898: 1995, GB10963-1999 "category for household and Current protection may place used circuit breakers" and other standards.

#### Shape and size of the installation of technology:

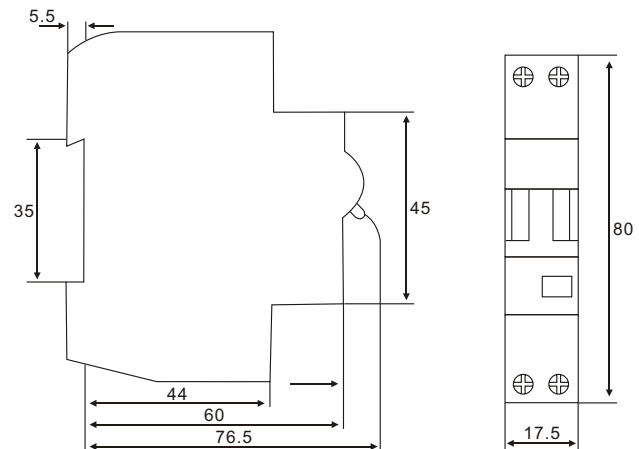

Trip Type		B	C	Trip Time
Thermal Trip	I1	1.13In	1.13In	≥1h
	I2	1.45In	1.45In	<1h
Magnetic Trip	I3	3In	3In	≥0.1s
	I4	5In	10In	<0.1s



# Miniature Circuit Breaker

## MBL7 DPN

### Specification needs:

Product Details	Manufacturer: Meba ElectricEnterprises		
	Country of Origin: China		
	Brand: Meba		
	Model: MBL7		
Manufacturing Standards	IEC 60898 IEC60947		
Tropicalization	Relative Humidity	°C	93% RH at25°C
	Room Temperature	°C	10°C a 60°C
Electrical Properties	Rated at 40°C	A	6/10/16/20/25/32/40
	Rated operating voltage at 40°C	Vac	240/415
	Nominal Frequency	Hz	50/60
	Interrupting Capacity at 230V	kA	6
	Operating temperature	°C	-5°C a 40°C
	Degree of Protection		IP20
	Number of poles		1P+N
	Conductor cross section (minimum allowable)	mm <sup>2</sup>	25
	Minimum number of power moves		4000
	Minimum number of mechanical operations		8000
	Operation curve		B/C
	Current Trip Curve C	A	3 a 10 In
	Characteristic Intervention		attach
Type of Assembly	FOR RIEL DIN 35mm		
Operation Indicator Window	The circuit breaker have an operating window color display that shows the state in which it is (connected or disconnected).		
Features	MAGNETIC COIL: ensures the switching of short-circuit, speaking within the following ranges: 3 to 10 times rated current ( Type C ), 3 to 5 times rated current ( Type B ), 10 to 14 times rated current ( Type D )		
	BIMETAL: ensures the breaker trip when overloaded.		
	ARC CHAMBER: effectively dissipates the electric arc that is generated by the opening contacts of the trigger mechanism in the presence of an overload or short circuit.		
Present Certificates	CE CB		
	ISO 9001-2000 awarded by the competent certification body, Meba is qualified in the manufacturing of the object		
	IEC 60898 standards in the manufacture of the goods		
	Curve compliance issued Shot by an accredited laboratory for effect		
Testing For Acceptance	Life, given by Meba to ensure that the life of the goods offered by at least 15 years.		
	Before receiving the circuit breakers (breakers), customers may perform the tests maybe necessary to ensure compliance with the technical specifications.		
Packing	The packaging is sure that withstand any adverse conditions during transport and handling to the warehouse of customers		
Dial Century, Year, Month and Batch	In one of its sides the breaker is marked with permanent ink, year, month and batch.		
Catalog	Attach catalogs indicating the technical specification		
Shows	Submit sample of the product offered		
Technical Warranty	2 YEARS		
Place of Delivery	FOB & CNF		
Delivery	25 Days		



# Miniature Circuit Breaker

## MBL7 DPN

### Specification needs:

Product Details	Manufacturer: Meba ElectricEnterprises		
	Country of Origin: China		
	Brand: Meba		
	Model: MBL7		
Manufacturing Standards	IEC 60898 IEC60947		
Tropicalization	Relative Humidity	°C	93% RH at25°C
	Room Temperature	°C	10°C a 60°C
Electrical Properties	Rated at 40°C	A	6/10/16/20/25/32/40
	Rated operating voltage at 40°C	Vac	240/415
	Nominal Frequency	Hz	50/60
	Interrupting Capacity at 230V	kA	6
	Operating temperature	°C	-5°C a 40°C
	Degree of Protection		IP20
	Number of poles		1P+N
	Conductor cross section (minimum allowable)	mm <sup>2</sup>	25
	Minimum number of power moves		4000
	Minimum number of mechanical operations		8000
	Operation curve		B/C
	Current Trip Curve C	A	3 a 10 In
	Characteristic Intervention		attach
Type of Assembly	FOR RIEL DIN 35mm		
Operation Indicator Window	The circuit breaker have an operating window color display that shows the state in which it is (connected or disconnected).		
Features	MAGNETIC COIL: ensures the switching of short-circuit, speaking within the following ranges: 3 to 10 times rated current ( Type C ), 3 to 5 times rated current ( Type B ), 10 to 14 times rated current ( Type D )		
	BIMETAL: ensures the breaker trip when overloaded.		
	ARC CHAMBER: effectively dissipates the electric arc that is generated by the opening contacts of the trigger mechanism in the presence of an overload or short circuit.		
Present Certificates	CE CB		
	ISO 9001-2000 awarded by the competent certification body, Meba is qualified in the manufacturing of the object		
	IEC 60898 standards in the manufacture of the goods		
	Curve compliance issued Shot by an accredited laboratory for effect		
Testing For Acceptance	Life, given by Meba to ensure that the life of the goods offered by at least 15 years.		
	Before receiving the circuit breakers (breakers), customers may perform the tests maybe necessary to ensure compliance with the technical specifications.		
Packing	The packaging is sure that withstand any adverse conditions during transport and handling to the warehouse of customers		
Dial Century, Year, Month and Batch	In one of its sides the breaker is marked with permanent ink, year, month and batch.		
Catalog	Attach catalogs indicating the technical specification		
Shows	Submit sample of the product offered		
Technical Warranty	2 YEARS		
Place of Delivery	FOB & CNF		
Delivery	25 Days		

# Miniature Circuit Breaker



MEBA ELECTRIC  
ENTERPRISES.

## MBL7 DPN

### Structural characteristics:

- Small size, limiting the effect of good, high breaking capacity, with 1P+N double break point, the polarization was Insulation to isolate, in sync and connected to the premise of breaking, N always first to connect, after breaking both to ensure the protection of polar arc breaking the ability to effectively protect and control lines and electrical equipment safety.
- Obvious contact with the location of the state of the instructions.  
-Type terminal block used to enhance, to facilitate wiring to ensure that the wire 1mm<sup>2</sup> to 16mm<sup>2</sup> reliable connection.

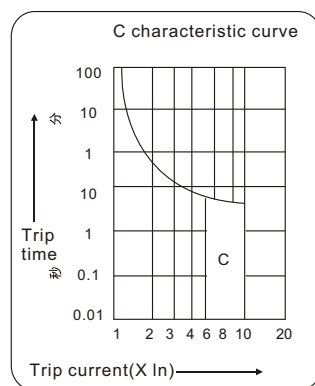
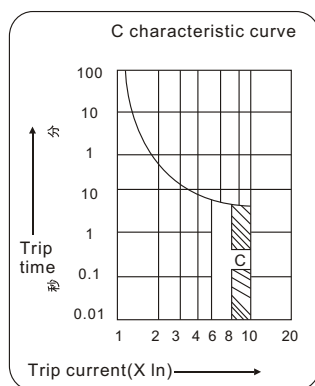



### Normal working conditions and installation conditions:

- The normal working conditions:
  - shall not exceed the limit of air temperature, the lower limit of +40°C not below -5°C, 24h+35°C than average
  - The location of the altitude than 2000mm.
  - The location of the air relative humidity in the highest temperature around 40°C when does not exceed 50%, at lower temperatures can allow higher relative humidity. The wet months mean maximum relative humidity, and no more than 90 percent of the average minimum temperature does not exceed +25°C. And considering the temperature changes in product on the surface of the condensation.
  - Pollution level 2.
- Installation conditions:
  - Installation category two, three type.
  - Breaker using standard guide installation.
  - Circuit breaker should normally be mounted vertically, the handle up for access to current location.
  - Installation should be no significant shock and vibration.

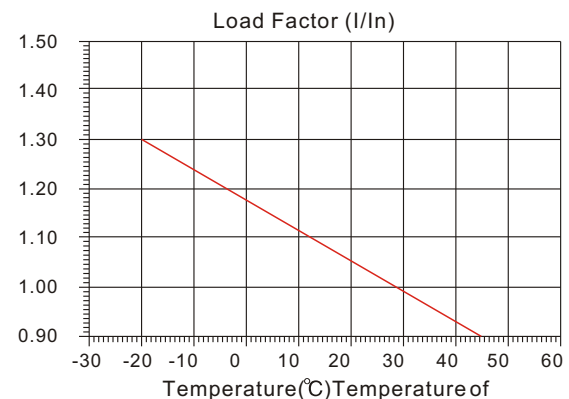
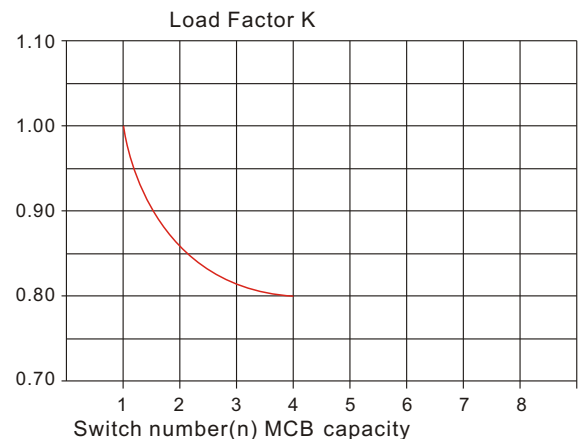
### Load capacity:



- JAB7-40 and DO fuse or short-circuit the performance of NH
- 1.4 high selectivity of 1.4 KA, No functional

1. On electrical circuits from overload and short circuit protection. 2. Especially suitable for civilian use with a bracket of the lighting circuit protection. The center line breaking, more secure.	 	
	Rated Current (A) In	Model
	2	
	4	
	6	
	10	
	16	
	20	
	25	
	32	
	40	





www.mebamfg.com

## Miniature Circuit Breaker

### MBL7 DPN

#### Order Information:

- Orders should be indicated when the product model, release type, the number of such.
- For example: JAB7-40 mini circuit breaker, rated current of 16A, release patterns for the C-type, 100 units, is expressed as JAB7-40-C16.

#### Fuse D01, D02, D03 performance:

JAB7-40 of the rated current		GL fuse rated current(A)								
		10	16	20	25	35	50	63	80	100
Characteristic curve of C	6		<0.5	0.7	1.1	2.1				
	10				0.8	1.5	3.4	5.0		
	13					1.4	3.1	4.6	6.0	
	16					1.4	2.9	4.1	5.5	
	20					1.2	2.4	3.4	4.5	
	25						2.0	2.9	3.8	
	32							2.3	3.0	
	40								2.4	

#### NH-00 fuse option:

JAB7-40 of the rated current		GL fuse rated current(A)										
		16	20	25	35	40	50	63	80	100	125	160
Characteristic curve of C	6	<0.5	0.5	0.8	2.7	4.0						
	10			0.7	1.8	2.3	3.1	4.6	6.0			
	13				1.6	2.1	3.1	4.1	5.5			
	16				1.5	1.9	2.8	3.9	5.0			
	20				1.3	2.0	2.3	3.1	4.2			
	25						2.0	2.7	3.5			
	32							2.1	2.9			
	40								2.4			

### MBL8/MBL9 Miniature Circuit Breaker

#### Overall & Installation Dimensions:

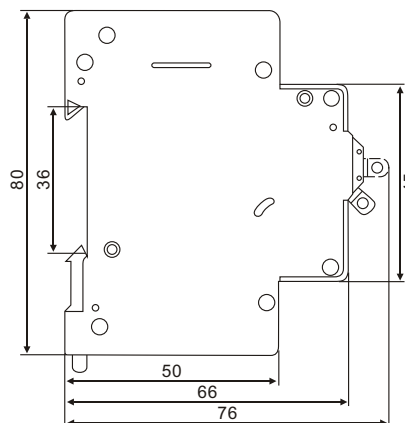
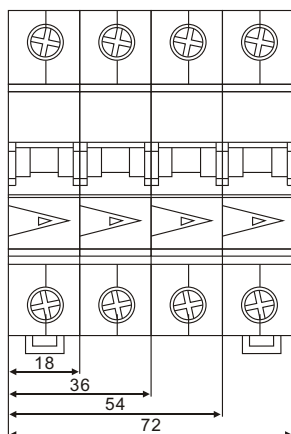

# Miniature Circuit Breaker



**MEBA ELECTRIC  
ENTERPRISES.**

## MBL8/MBL9 Miniature Circuit Breaker

### Specification needs:

Product Details	Manufacturer: Meba Electric Enterprises		
	Country of Origin: China		
	Brand: Meba		
	Model: MBL8/ MBL9		
Manufacturing Standards	IEC 60898 IEC60947		
Tropicalization	Relative Humidity	°C	93% RH at 25°C
	Room Temperature	°C	-5°C a 40°C
Electrical Properties	Rated at 40°C	A	6/10/16/20/25/32/40/50/63
	Rated operating voltage at 40°C	Vac	240/415
	Nominal Frequency	Hz	50/60
	Interrupting Capacity at 230V	kA	6
	Operating temperature	°C	-5°C a 40°C
	Degree of Protection		IP20
	Number of poles		1/2/3/4
	Conductor cross section (minimum allowable)	mm <sup>2</sup>	25
	Minimum number of power moves		6000
	Minimum number of mechanical operations		20000
	Operation curve		B/C/D
	Current Trip Curve C	A	5 a 10 In
	Characteristic Intervention		attach
Type of Assembly	FOR RIEL DIN 35mm		
Operation Indicator Window	The circuit breaker have an operating window color display that shows the state in which it is (connected or disconnected).		
Features	MAGNETIC COIL: ensures the switching of short-circuit, speaking within the following ranges: 5 to 10 times rated current (Type C), 3 to 5 times rated current (Type B), 10 to 14 times rated current (Type D)		
	BIMETAL: ensures the breaker trip when overloaded.		
	ARC CHAMBER: effectively dissipates the electric arc that is generated by the opening contacts of the trigger mechanism in the presence of an overload or short circuit.		
Present Certificates	CE		
	ISO 9001-2000 awarded by the competent certification body, Meba is qualified in the manufacturing of the object		
	IEC 60898 standards in the manufacture of the goods		
	Curve compliance issued Shot by an accredited laboratory for effect		
Testing For Acceptance	Life, given by Meba to ensure that the life of the goods offered by at least 15 years.		
	Before receiving the circuit breakers (breakers), customers may perform the tests maybe necessary to ensure compliance with the technical specifications.		
Packing	The packaging is sure that withstand any adverse conditions during transport and handling to the warehouse of customers		
Dial Century, Year, Month and Batch	In one of its sides the breaker is marked with permanent ink, year, month and batch.		
Catalog	Attach catalogs indicating the technical specification		
Shows	Submit sample of the product offered		
Technical Warranty	2 YEARS		
Place of Delivery	FOB & CNF		
Delivery	25 Days		



www.mebamfg.com

# Miniature Circuit Breaker

## MBLPN/MBLPN2 Miniature Circuit Breaker

### Application:

- Protection and control of circuit against overload and short circuit, in building installation-such as houses, offices, commercial complex, motor system(D curve) and industrial installation-for switching, control, protection and regulation of electrical circuits. Also in switchgear panels, railway and marine application.
- Applicable to terminal and pin/fork type busbar connection
- High short-circuit capacity
- Protection against both overload and short circuit

### Specification needs:

Product Details	Manufacturer Meba ElectricEnterprises				
	Country of Origin: China				
	Brand: Meba				
	Model: MBLPN/MBLPN2				
Manufacturing Standards	IEC 60898 IEC60947				
Tropicalization	Relative Humidity	℃	93% RH at25℃	50% RH at40℃	
	Room Temperature	℃	-5℃ a 40℃		
Electrical Properties	Rated at 40℃	A	6/10/16/20/25/32/40/50/63		
	Rated operating voltage at 40℃	Vac	240/415		
	Nominal Frequency	Hz	50/60		
	Interrupting Capacity at230 V	kA	6		
	Operating temperature	℃	40		
	Degree of Protection		IP20		
	Number of poles		1/2/3/4		
	Conductor cross section (minimum allowable)	mm²	25		
	Minimum number of power moves		4000		
	Minimum number of mechanical operations		8000		
	Operation curve		B/C/D		
	Current Trip Curve	A	Type B: 3 a 5 In	Type C: 5 a 10 In	Type D: 10 a 14 In
	Characteristic Intervention		attach		
Type of Assembly	FOR RIEL DIN 35 mm				
Features	MAGNETIC COIL: ensures the switching of short-circuit, speaking within the following ranges: 5 to 10 times rated current (Type C), 3 to 5 times rated current ( Type B), 10 to 14 times rated current ( Type D )				
	BIMETAL: ensures the breaker trip when overloaded.				
	ARC CHAMBER: effectively dissipates the electric arc that is generated by the opening contacts of the trigger mechanism in the presence of an overload or short circuit.				
Present Certificates	CE CB				
	ISO 9001-2000 awarded by the competent certification body, Meba is qualified in the manufacturing of the object				
	IEC 60898 standards in the manufacture of the goods				
	Curve compliance issued Shot by an accredited laboratory for effect				
	Life, given by Meba to ensure that the life of the goods offered by at least 15 years.				
Testing For Acceptance	Before receiving the circuit breakers (breakers), customers may perform the tests may be necessary to ensure compliance with the technical specifications.				
Packing	The packaging is sure that withstand any adverse conditions during transport and handling to the warehouse of customers.				
Dial Century, Year, Month and Batch	In one of its sides the breaker is marked with permanent ink, year, month and batch.				
Catalog	Attach catalogs indicating the technical specification				
Shows	Submit sample of the product offered				
Technical Warranty	2 YEARS				
Place of Delivery	FOB & CNF				
Delivery	25 Days				

# Miniature Circuit Breaker



MEBA ELECTRIC  
ENTERPRISES.

## MBLSN/MBLSN2 Miniature Circuit Breaker

### Application:

- Protection and control of circuit against overload and short circuit, in building installation-such as houses, offices, commercial complex, motor system(D curve) and industrial installation-for switching, control, protection and regulation of electrical circuits. Also in switchgear panels, railway and marine application.
- Applicable to terminal and pin/fork type busbar connection
- High short-circuit capacity
- Protection against both overload and short circuit

### Specification needs:

Product Details	Manufacturer Meba Electric Enterprises				
	Country of Origin: China				
	Brand: Meba				
	Model: MBLSN/MBLSN2				
Manufacturing Standards	IEC 60898 IEC60947				
Tropicalization	Relative Humidity	℃	93% RH at 25℃		50% RH at 40℃
	Room Temperature	℃	-5℃ a 40℃		
Electrical Properties	Rated at 40℃	A	6/10/16/20/25/32/40/50/63		
	Rated operating voltage at 40℃	Vac	240/415		
	Nominal Frequency	Hz	50/60		
	Interrupting Capacity at 230 V	kA	6		
	Operating temperature	℃	40		
	Degree of Protection		IP20		
	Number of poles		1/2/3/4		
	Conductor cross section (minimum allowable)	mm²	25		
	Minimum number of power moves		6000		
	Minimum number of mechanical operations		20000		
	Operation curve		B/C/D		
	Current Trip Curve	A	Type B: 3 a 5 In	Type C: 5 a 10 In	Type D: 10 a 14 In
Characteristic Intervention		attach			
Type of Assembly	FOR RIEL DIN 35 mm				
Features	MAGNETIC COIL: ensures the switching of short-circuit, speaking within the following ranges: 5 to 10 times rated current (Type C), 3 to 5 times rated current (Type B), 10 to 14 times rated current (Type D)				
	BIMETAL: ensures the breaker trip when overloaded.				
	ARC CHAMBER: effectively dissipates the electric arc that is generated by the opening contacts of the trigger mechanism in the presence of an overload or short circuit.				
Present Certificates	CE CB				
	ISO 9001-2000 awarded by the competent certification body, Meba is qualified in the manufacturing of the object				
	IEC 60898 standards in the manufacture of the goods				
	Curve compliance issued Shot by an accredited laboratory for effect				
Testing For Acceptance	Life, given by Meba to ensure that the life of the goods offered by at least 15 years.				
	Before receiving the circuit breakers (breakers), customers may perform the tests maybe necessary to ensure compliance with the technical specifications.				
Packing	The packaging is sure that withstand any adverse conditions during transport and handling to the warehouse of customers.				
Dial Century, Year, Month and Batch	In one of its sides the breaker is marked with permanent ink, year, month and batch.				
Catalog	Attach catalogs indicating the technical specification				
Shows	Submit sample of the product offered				
Technical Warranty	2 YEARS				
Place of Delivery	FOB & CNF				
Delivery	25 Days				



www.mebamfg.com

# Miniature Circuit Breaker

## MBQH1/MBQH2 Miniature Circuit Breaker

### Specifications:

- Hydraulic-magnetic technology ensures reduced nuisance tripping with temperature variance
- Always hold 100% rated current
- Wide range of time delays & operating currents
- Current limiting capabilities
- Ultra compact 26mm width module
- Din (13), (18) only, Mini-rail or Dual mountable (13), (19) and (26)
- Trip indication with mid trip handle position
- Switch disconnecter provides circuit isolation
- Reset possible immediately after overload

### Technical parameter:

Max. AC Voltage	230/400 VAC
Max. Interrupting Capacity	10kA rms
Min. Current Rating	10A
Max. Current Rating	1=125A 2, 3, 1+N, 3+N=100A
Agency Recognition of Approvals	IEC 60947-2 SANS VC8036 SANS 156

### Applications:

- Branch circuit protection
- Telecom power distribution
- Power conditioning
- Automatic control systems
- Power supplies
- Power conversion systems
- UPS equipment
- Control machines
- Generator sets

QH Range						
Standard Circuit Breaker 10KA Curve 2 (Standard) mini and DIN Mounting, 57 MM Escutcheon						
Type	Poles	Voltage	KA	MCB Width(mm)	STD Pack	Rating(A)
QH-1(26)	1	230VAC	10	26 (1 Module)	12	10 15 20 25 30 35 40 45 50 63 70 80 100 125
QH-2(26)	2	400VAC	10	52 (2 Module)	6	10 15 20 25 30 35 40 45 50 63 70 80 100
QH-3(26)	3	400VAC	10	78 (3 Module)	4	10 15 20 25 30 35 40 45 50 63 70 80 100
QH-N-2(26)	1+N	230VAC	10	52 (2 Module)	6	10 15 20 25 30 35 40 45 50 63 70 80 100
QF-N-4(26)	3+N	400VAC	10	104 (4 Module)	3	10 15 20 25 30 35 40 45 50 63 70 80 100
Standard Circuit Breaker 10KA Curve 1, mini and DIN Mounting, 57 MM Escutcheon						
Type	Poles	Voltage	KA	MCB Width(mm)	STD Pack	Rating(A)
QH-1(26)	1	230VAC	10	26 (1 Module)	12	10 15 20 25 30 35 40 45 50 63 70 80 100 125
QH-3(26)	3	400VAC	10	78 (3 Module)	4	10 15 20 25 30 35 40 45 50 63 70 80 100
Standard Circuit Breaker 10KA Curve 1, mini and DIN Mounting, 57 MM Escutcheon						
Type	Poles	Voltage	KA	MCB Width(mm)	STD Pack	Rating(A)
QH-S-1(26)	1	230VAC	10	26 (1 Module)	12	63 125
QH-S-2(26)	2	400VAC	10	52 (2 Module)	6	63 100
QH-S-3(26)	3	400VAC	10	78 (3 Module)	4	63 100

# Miniature Circuit Breaker



MEBA ELECTRIC  
ENTERPRISES.

## MBQF-D Miniature Circuit Breaker

### Specifications:

- Hydraulic-magnetic technology ensures reduced nuisance tripping with temperature variance
- Always hold 100% rated current
- Wide range of time delays & operating currents
- Current limiting capabilities
- Ultra compact 13, 18, 19, 26mm width module
- Din (13), (18) only, Mini-rail or Dual mountable (13), (19) and (26)
- Trip indication with mid trip handle position
- Switch disconnecter provides circuit isolation
- Reset possible immediately after overload

### Technical parameter:

Max. AC Voltage	230/400 VAC
Max. Interrupting Capacity	5kA rms
Min. Current Rating	0.5A
Max. Current Rating	1=125A
	3=100A
Agency Recognition of Approvals	IEC 60947-2
	SANS VC8036
	SANS 156

### Applications:

- Branch circuit protection
- Telecom power distribution
- Power conditioning
- Automatic control systems
- Power supplies
- Power conversion systems
- UPS equipment
- Control machines
- Generator sets

#### QF Range

#### Special Supply Authority/Industrial Circuit Breaker-5KA

Type	Poles	Voltage	KA	MCB Width(mm)	STD Pack	Rating(A)
QF-1(13)	1	230VAC	5	13 (1 Module)	12	10 15 20 25
QF-3(13)	3	400VAC	5	39 (3 Module)	4	10 15 20 25
QF-1(19)	1	230VAC	5	19.5 (1 Module)	12	10 15 20 25 30 35 40 45 50 63
QF-3(19)	3	400VAC	5	58.5 (3 Module)	4	10 15 20 25 30 35 40 45 50 63
QF-1(26)	1	230VAC	5	26 (2 Module)	12	10 15 20 25 32 40 45 50 63 70 80 100 125
QF-3(26)	3	400VAC	5	78 (3 Module)	4	10 15 20 25 32 40 45 50 63 70 80 100

#### Switch Disconnectors 6KA, mini and DIN Rail Mounting, 45mm Escutcheon

Type	Poles	Voltage	KA	MCB Width(mm)	STD Pack	Rating(A)
QF-1(13)-D	1	230VAC	6	13 (1 Module)	12	10 15 20 25
QF-3(13)-D	3	415VAC	6	39 (3 Module)	4	10 15 20 25
QF-1(18)-D	1	240VAC	6	18 (1 Module)	12	10 15 20 25 30 35 40 45 50 63
QF-3(18)-D	3	415VAC	6	54 (3 Module)	4	10 15 20 25 30 35 40 45 50 63
QF-1(26)-D	1	240VAC	5	26 (2 Module)	12	10 15 20 25 32 40 45 50 63 70 80 100 125
QF-3(26)-D	3	415VAC	5	78 (3 Module)	4	10 15 20 25 32 40 45 50 63 70 80 100



www.mebamfg.com

# Miniature Circuit Breaker

## MB45DC Miniature Circuit Breaker

### Technical paramters:

Frame rated current Imm (A)	Pole	Width/Pole (18mm times)	Rated Voltage (V)	Rated Current In(A)	Rated limit shortcircuit capacity		Instantaneous breaking type
					Breaking current Icu(A)	Time T(ms)	
63	1	1	DC125	1、2、3、4、5、6、10、15、16、20、25、32、40、50、63A	10000	10	C、D
	2	2	DC250				
	3	3	DC440		6000	10	C、D

### Time-current operation:

Tes	Type	Test Current	First Condition	Time limit release or un-release	Expect result	Note
a	C、D	1.13In	Cold	$t \geq 1h$ ( $I_n \leq 63$ )	Un-Release	
b	C、D	1.45In	Containue A Type Test	$t < 1h$ ( $I_n \leq 63$ )	Release	Current in within 5 steadily up
c	C	8In	Cold	$t \geq 0.1s$	Un-release	Closed auxiliary switch processing power
		12In		$t < 0.1s$	Release	
d	D	10In	Cold	$t \geq 0.1s$	Un-release	
		14In		$t < 0.1s$	Release	

### Time-current charateristic curve:

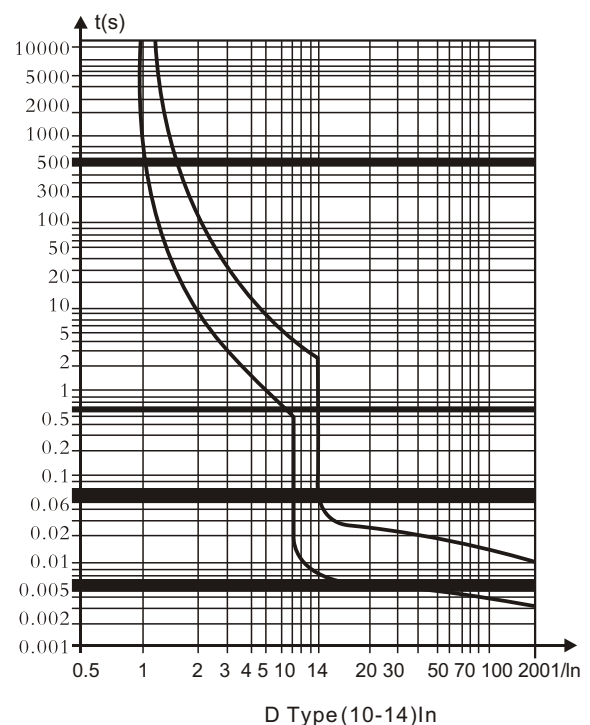
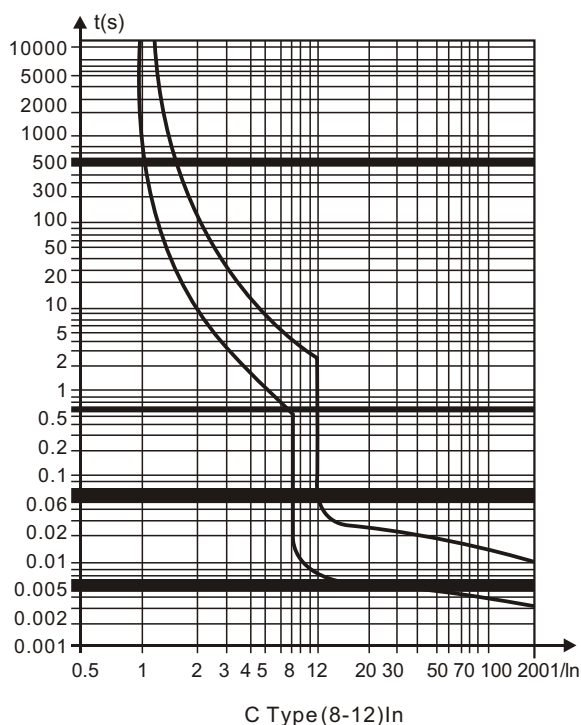

# Miniature Circuit Breaker



MEBA ELECTRIC  
ENTERPRISES.

## MBP41 Miniature Circuit Breaker

### Specification needs:

Product Details	Manufacturer Meba ElectricEnterprises				
	Country of Origin: China				
	Brand: Meba				
	Model: MBP41				
Manufacturing Standards	IEC60947				
Tropicalization	Relative Humidity	℃	93% RH at25℃		
	Room Temperature	℃	10℃ a 60℃		
Electrical Properties	Rated at 40℃	A	63/80/100		
	Rated operating voltage at 40℃	Vac	240/415		
	Nominal Frequency	Hz	50/60		
	Interrupting Capacity at 230 V	kA	10		
	Operating temperature	℃	40		
	Degree of Protection		IP20		
	Number of poles		1, 2, 3, 4		
	Conductor cross section (minimum allowable)	mm²	63A/16	80A/25	100A/35
	Minimum number of power moves		4000		
	Minimum number of mechanical operations		8000		
	Operation curve		C/D		
	Current Trip Curve	A	Type C 5 a 10 In	Type D 10 a 14 In	
	Characteristic Intervention		attach		
Type of Assembly	FOR RIEL DIN 35 mm				
Operation Indicator Window	The circuit breakerhave an operatingwindow color displaythat shows thestate in which it is (connected or disconnected).				
Features	MAGNETIC COIL: ensures theswitching of short-circuit, speaking within the following ranges: 5 to 10 times rated current (Type C), 10 to 14 times rated current ( Type D)				
	BIMETAL: ensures the breaker tripwhen overloaded.				
	ARC CHAMBER: effectively dissipates the electricarc that isgeneratedby the opening contacts of the trigger er mechanism in the presence of an overload or shortcircuit.				
Present Certificates	CE CB				
	ISO 9001-2000awarded by the competentcertification body, Mebais qualified in the manufacturing of the object				
	IEC 60898 standardsin the manufacture of the goods				
	Curve compliance issued Shot by an accredited laboratory for effect				
Testing For Acceptance	Life, given byMeba to ensure that the life of the goods offered by atleast 15 years.				
	Before receiving the circuit breakers (breakers), customers may perform the tests maybe necessary to ensure compliance with the technical specifications.				
Packing	The packaging issue that withstand any adverse conditions during transport and handing to the warehouse of customers.				
Dial Century, Year, Month and Batch	In one of its sides the breaker is marked with permanent ink, year, month and batch.				
Catalog	Attach catalogs indicating the technical specification				
Shows	Submit sample of the product offered				
Technical Warranty	2 YEARS				
Place of Delivery	FOB & CNF				
Delivery	25 Days				





www.mebamfg.com

# Miniature Circuit Breaker

## MBR47 Miniature Circuit Breaker

### Specification needs:

Product Details	Manufacturer Meba Electric Enterprises		
	Country of Origin: China		
	Brand: Meba		
	Model: MBR47		
Manufacturing Standards	IEC 60898 IEC60947		
Tropicalization	Relative Humidity	°C	93% RH at 25°C
	Room Temperature	°C	10°C a 60°C
Electrical Properties	Rated at 40°C	A	6/10/16/20/25/32/40/50/63
	Rated operating voltage at 40°C	Vac	240/415
	Nominal Frequency	Hz	50/60
	Interrupting Capacity at 230 V	kA	6
	Operating temperature	°C	40
	Degree of Protection		IP20
	Number of poles		1/2/3/4
	Conductor cross section (minimum allowable)	mm <sup>2</sup>	25
	Minimum number of power moves		4000
	Minimum number of mechanical operations		10000
	Operation curve		B/C/D
	Current Trip Curve C	A	5 a 10 In
	Characteristic Intervention		attach
Type of Assembly	FOR RIEI DIN 35 mm		
Operation Indicator Window	The circuit breaker have an operating window color display that shows the state in which it is (connected or disconnected).		
Features	MAGNETIC COIL: ensures the switching of short-circuit, speaking within the following ranges: 5 to 10 times rated current (Type C), 3 to 5 times rated current (Type B), 10 to 14 times rated current (Type D)		
	BIMETAL: ensures the breaker trip when overloaded.		
	ARC CHAMBER: effectively dissipates the electric arc that is generated by the opening contacts of the trigger mechanism in the presence of an overload or short circuit.		
Present Certificates	CE CB		
	ISO 9001-2000 awarded by the competent certification body, Meba is qualified in the manufacturing of the object		
	IEC 60898 standards in the manufacture of the goods		
	Curve compliance issued Shot by an accredited laboratory for effect		
Testing For Acceptance	Life, given by Meba to ensure that the life of the goods offered by at least 15 years.		
	Before receiving the circuit breakers (breakers), customers may perform the tests maybe necessary to ensure compliance with the technical specifications.		
Packing	The packaging is sure that withstand any adverse conditions during transport and handling to the warehouse of customers		
Dial Century, Year, Month and Batch	In one of its sides the breaker is marked with permanent ink, year, month and batch.		
Catalog	Attach catalogs indicating the technical specification		
Shows	Submit sample of the product offered		
Technical Warranty	2 YEARS		
Place of Delivery	FOB & CNF		
Delivery	25 Days		



## MBS-125 Isolator

MBS-125 Isolator series are major used as main switch in distribution box, control on or off for all branch switch. The product is applicable to circuit with rated voltage 230/400VAC, 50Hz for power distribution and motor operation as switching disconnecter in both household & commercial and electric equipments installations. The product, free of maintenance, is suitable for use by non-professionals. The product is switched on when the handle is at upper position.

Product Details	Manufacturer: Meba ElectricEnterprises		
	Country of Origin: China		
	Brand: Meba		
	Model: MBS-125 Isolator		
Manufacturing Standards	IEC 60947-3		
Tropicalization	Relative Humidity	℃	93% RH at25℃
	Room Temperature	℃	-5℃ a 40℃
Electrical Properties	Rated at 40℃	A	63/80/100/125
	Rated operating voltage at 40℃	Vac	240/415
	Nominal Frequency	Hz	50/60
	Interrupting Capacity	kA	3
	Operating temperature	℃	-5℃ a 40℃
	Degree of Protection		IP20
	Number of poles	mm²	1/2/3/4
	Conductor cross section (minimum allowable)		25
	Minimum number of power moves		4000
	Minimum number of mechanical operations		8000
	Operation curve		/
	Current Trip Curve	A	/
	Characteristic Intervention		attach
	Type of Assembly	FOR RIEL DIN 35 mm	
Present Certificates	CE		
	ISO 9001-2000		
	IEC 60947-3 standards		
	Life, given byus to ensure that the life of the goods offered by atleast 5 years.		
Testing For Acceptance	Before receiving the circuit breakers (breakers), customers may perform the tests maybe necessary to		
	ensure compliance with the technical specifications.		
Packing	We are sure the packaging withstand any adverse conditions during transport and handling to the cellars		
	of the Company. Carton or Pallet		
Dial Century, Year, Month and Batch	In one of its sides the breaker is marked with the symbol permanent ink, year, month and batch.		
Catalog	Available		
Shows	Submit sample of the product offered		
Technical Warranty	2 YEARS		
Place of Delivery	CIF CNF FOB		
Delivery	25 Days		



# Miniature Circuit Breaker

## MBS941N Miniature Circuit Breaker

### Application:

- Protection and control of circuit against overload and short circuit, In building installation-such as houses, offices, commercial complex, motor system(D curve) and industrial installation-for switching, control, protection and regulation of electrical circuits. Also in switchgear panels, railway and marine application.
- Applicable to terminal and pin/fork type busbar connection
- High short-circuit capacity
- Protection against both overload and short circuit

### Specification needs:

Product Details	Manufacturer Meba ElectricEnterprises					
	Country of Origin: China					
	Brand: Meba					
	Model: MBS941N					
Manufacturing Standards	IEC 60898 IEC60947					
Tropicalization	Relative Humidity	℃	93% RH at25℃	50% RH at40℃		
	Room Temperature	℃	-5℃ a 40℃			
Electrical Properties	Rated at 40℃	A	6/10/16/20/25/32/40/50/63			
	Rated operating voltage at 40℃	Vac	240/415			
	Nominal Frequency	Hz	50/60			
	Interrupting Capacity at 230 V	kA	6			
	Operating temperature	℃	-5℃ a 40℃			
	Degree of Protection		IP20			
	Number of poles		1/2/3/4			
	Conductor cross section (minimum allowable)	mm²	25			
	Minimum number of power moves		4000			
	Minimum number of mechanical operations		8000			
	Operation curve		B/C/D			
	Current Trip Curve	A	Type B : 3 a 5 In	Type C : 5 a 10 In	Type D: 10 a 14 In	
	Characteristic Intervention		attach			
	Type of Assembly	FOR RIEL DIN 35 mm				
	Features	MAGNETIC COIL: ensures the switching of short-circuit, speaking within the following ranges: 5 to 10 times rated current (Type C), 3 to 5 times rated current ( Type B ), 10 to 14 times rated current ( Type D )				
BIMETAL: ensures the breaker trip when overloaded.						
ARC CHAMBER: effectively dissipates the electric arc that is generated by the opening contacts of the trigger mechanism in the presence of an overload or short circuit.						
Present Certificates	CE CB					
	ISO 9001-2000 awarded by the competent certification body, Meba is qualified in the manufacturing of the object					
	IEC 60898 standards in the manufacture of the goods					
	Curve compliance issued Shot by an accredited laboratory for effect					
	Life, given by Meba to ensure that the life of the goods offered by at least 15 years.					
Testing For Acceptance	Before receiving the circuit breakers (breakers), customers may perform the tests may be necessary to ensure compliance with the technical specifications.					
Packing	The packaging is sure that withstand any adverse conditions during transport and handling to the warehouse of customers					
Dial Century, Year, Month and Batch	In one of its sides the breaker is marked with permanent ink, year, month and batch.					
Catalog	Attach catalogs indicating the technical specification					
Shows	Submit sample of the product offered					
Technical Warranty	2 YEARS					
Place of Delivery	FOB & CNF					
Delivery	25 Days					

# Miniature Circuit Breaker



MEBA ELECTRIC  
ENTERPRISES.

## MBV1PC Miniature Circuit Breaker

### Application:

- Protection and control of circuit against overload and short circuit, In building installation-such as houses, offices, commercial complex, motor system(D curve) and industrial installation-for switching, control, protection and regulation of electrical circuits. Also in switchgear panels,railway and marine application.
- Applicable to terminal and pin/fork type busbar connection
- High short-circuit capacity
- Protection against both overload and short circuit

### Specification needs:

Product Details	Manufacturer Meba ElectricEnterprises		
	Country of Origin: China		
	Brand: Meba		
	Model: MBV1PC		
Manufacturing Standards	IEC 60898 IEC60947		
Tropicalization	Relative Humidity	℃	93% RH at 25℃
	Room Temperature	℃	-5℃ a 40℃
Electrical Properties	Rated at 40℃	A	6/10/16/20/25/32/40/50/63
	Rated operating voltage at 40℃	Vac	240/415
	Nominal Frequency	Hz	50/60
	Interrupting Capacity at 230 V	kA	4.5
	Operating temperature	℃	-5℃ a 40℃
	Degree of Protection		IP20
	Number of poles		1/2/3/4
	Conductor cross section (minimum allowable)	mm <sup>2</sup>	25
	Minimum number of power moves		4000
	Minimum number of mechanical operations		10000
	Operation curve		B/C/D
	Current Trip Curve C	A	5 a 10 In
	Characteristic Intervention		attach
Type of Assembly	FOR RIEL DIN 35 mm		
Operation Indicator Window	The circuit breaker have an operating window color display that shows the state in which it is (connected or disconnected).		
Features	MAGNETIC COIL: ensures the switching of short-circuit, speaking within the following ranges: 5 to 10 times rated current (Type C), 3 to 5 times rated current (Type B), 10 to 14 times rated current ( Type D )		
	BIMETAL: ensures the breaker trip when overloaded.		
	ARC CHAMBER: effectively dissipates the electric arc that is generated by the opening contacts of the trigger mechanism in the presence of an overload or short circuit.		
Present Certificates	CE CB		
	ISO 9001-2000 awarded by the competent certification body, Meba is qualified in the manufacturing of the object		
	IEC 60898 standards in the manufacture of the goods		
	Curve compliance issued Shot by an accredited laboratory for effect		
Testing For Acceptance	Life, given by Meba to ensure that the life of the goods offered by at least 15 years.		
	Before receiving the circuit breakers (breakers), customers may perform the tests may be necessary to ensure compliance with the technical specifications.		
Packing	The packaging is sure that withstand any adverse conditions during transport and handling to the warehouse of customers		
Dial Century, Year, Month and Batch	In one of its sides the breaker is marked with permanent ink, year, month and batch.		
Catalog	Attach catalogs indicating the technical specification		
Shows	Submit sample of the product offered		
Technical Warranty	2 YEARS		
Place of Delivery	FOB & CNF		
Delivery	25 Days		



www.mebamfg.com

# Miniature Circuit Breaker

## SD-M6 Miniature Circuit Breaker

### Specification needs:

Product Details	Manufacturer Meba ElectricEnterprises		
	Country of Origin: China		
	Brand: Meba		
	Model: SD-M6		
Manufacturing Standards	IEC 60898 IEC60947		
Tropicalization	Relative Humidity	°C	93% RH at25°C
	Room Temperature	°C	10°C a 60°C
Electrical Properties	Rated at 40°C	A	5/10/15/20/30/40/50/60/75/100
	Rated operating voltage at 40°C	Vac	120/240/415
	Nominal Frequency	Hz	50/60
	Interrupting Capacity at 230 V	kA	6
	Operating temperature	°C	-5°C a 40°C
	Degree of Protection		IP20
	Number of poles		1/2/3/4
	Conductor cross section (minimum allowable)	mm <sup>2</sup>	25
	Minimum number of power moves		4000
	Minimum number of mechanical operations		10000
	Operation curve		B/C/D
	Current Trip Curve	A	5 a 10 In
Features	Characteristic Intervention		attach
	MAGNETIC COIL: ensures the switching of short-circuit, speaking within the following ranges: 5 to 10 times rated current (Type C), 3 to 5 times rated current ( Type B ), 10 to 20 times rated current ( Type D )		
	BIMETAL: ensures the breaker trip when overloaded.		
	ARC CHAMBER: effectively dissipates the electric arc that is generated by the opening contacts of the trigger mechanism in the presence of an overload or short circuit.		
Present Certificates	CE CB		
	ISO9001-2000 awarded by the competent certification body, Meba is qualified in the manufacturing of the object		
	IEC 60898 standards in the manufacture of the goods		
	Curve compliance issued Shot by an accredited laboratory for effect		
Testing For Acceptance	Life, given by Meba to ensure that the life of the goods offered by at least 15 years.		
	Before receiving the circuit breakers (breakers), customers may perform the tests maybe necessary to ensure compliance with the technical specifications.		
Packing	The packaging is sure that withstand any adverse conditions during transport and handling to the warehouse of customers		
Dial Century, Year, Month and Batch	In one of its sides the breaker is marked with permanent ink, year, month and batch.		
Catalog	Attach catalogs indicating the technical specification		
Shows	Submit sample of the product offered		
Technical Warranty	2 YEARS		
Place of Delivery	FOB & CNF		
Delivery	25 Days		

# Miniature Circuit Breaker



MEBA ELECTRIC  
ENTERPRISES.

## SD-SWD Miniature Circuit Breaker

### Specification needs:

Product Details	Manufacturer Meba ElectricEnterprises		
	Country of Origin: China		
	Brand: Meba		
	Model: SD-SWD		
Manufacturing Standards	IEC 60898 IEC60947		
Tropicalization	Relative Humidity	℃	93% RH at 25℃
	Room Temperature	℃	10℃ a 60℃
Electrical Properties	Rated at 40℃	A	5/10/15/20/30/40/50/60/75/100
	Rated operating voltage at 40℃	Vac	120/240/415
	Nominal Frequency	Hz	50/60
	Interrupting Capacity at 230 V	kA	6
	Operating temperature	℃	-5℃ a 40℃
	Degree of Protection		IP20
	Number of poles		1/2/3/4
	Conductor cross section (minimum allowable)	mm <sup>2</sup>	25
	Minimum number of power moves		4000
	Minimum number of mechanical operations		10000
	Operation curve		B/C/D
	Current Trip Curve	A	5 a 10 In
	Characteristic Intervention		attach
Features	MAGNETIC COIL: ensures the switching of short-circuit, speaking within the following ranges: 5 to 10 times rated current (Type C), 3 to 5 times rated current (Type B), 10 to 20 times rated current (Type D)		
	BIMETAL: ensures the breaker trip when overloaded.		
	ARC CHAMBER: effectively dissipates the electric arc that is generated by the opening contacts of the trigger mechanism in the presence of an overload or short circuit.		
Present Certificates	CE CB		
	ISO9001-2000 awarded by the competent certification body, Meba is qualified in the manufacturing of the object		
	IEC 60898 standards in the manufacture of the goods		
	Curve compliance issued Shot by an accredited laboratory for effect		
Testing For Acceptance	Life, given by Meba to ensure that the life of the goods offered by at least 15 years.		
	Before receiving the circuit breakers (breakers), customers may perform the tests maybe necessary to ensure compliance with the technical specifications.		
Packing	The packaging is sure that withstand any adverse conditions during transport and handling to the warehouse of customers		
Dial Century, Year, Month and Batch	In one of its sides the breaker is marked with permanent ink, year, month and batch.		
Catalog	Attach catalogs indicating the technical specification		
Shows	Submit sample of the product offered		
Technical Warranty	2 YEARS		
Place of Delivery	FOB & CNF		
Delivery	25 Days		



www.mebamfg.com

## Miniature Circuit Breaker

### SD-SWD Miniature Circuit Breaker

#### Overall & Installation Dimensions:

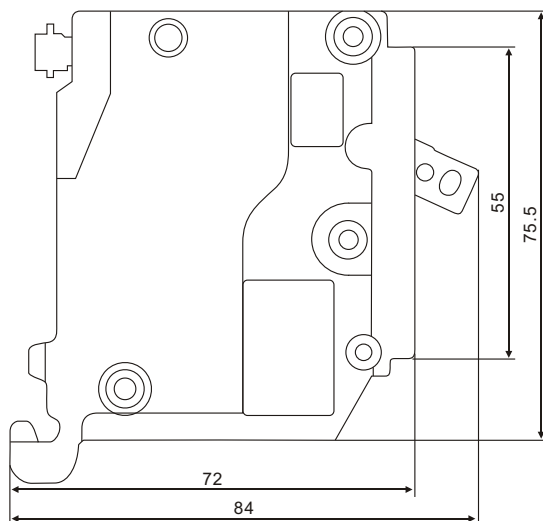

### TQL-1P Miniature Circuit Breaker

#### Applications:

THQ, THC series miniature circuit breaker is characteristic of small size, light weight, novel structure and excellent performance. They are mounted in the illuminating distribution board and used in guesthouses, block of flats, high buildings, squares, airports, railway stations, plants and enterprises etc, in AC circuits 230V (single pole) up to 400V (3 pole) 50/60Hz for protection of overload short circuit and for circuit change-over in lighting system. Breaking capacity is 3KA. The items comply with BS & IEC60947 standard.

#### Technical parameter:

Pole number	Rated current(A)	Rated voltage(V)	Rated making and breaking capacity(KA)		Setting temperature of protective characteristics
			B.S	NEMA	
1P	6, 10, 15, 20, 30, 40, 50, 63	AC12		5	40°C
		AC120/230		5	
		AC230/400	3		
2P	6, 10, 15, 20, 30, 40	AC120/230			40°C
		AC230/400	3	5	
3P	50, 63	AC230/400	3		

# Miniature Circuit Breaker



MEBA ELECTRIC  
ENTERPRISES.

## THQL Miniature Circuit Breaker

### Applications:

THQ, THC series miniature circuit breaker is characteristic of small size, lightweight, novel structure and excellent performance. They are mounted in the illuminating distribution board and used in guesthouses, block of flats, high buildings, squares, airports, railway stations, plants and enterprises etc, in AC circuits 230V(single pole) up 400V(3pole) 50/60Hz for protection of overload short circuit and for circuit change-over in lighting system. Breaking capacity is 3KA. The items comply with BS & IEC60947 standard.

### Technical parameter:

Pole number	Rated current(A)	Rated voltage(V)	Rated making and breaking capacity(KA)		Setting temperature of protective characteristics
			B.S	NEMA	
1P	6, 10, 15, 20, 30, 40, 50, 63	AC12		5	40°C
		AC120/230		5	
		AC230/400	3		
2P	6, 10, 15, 20, 30, 40	AC120/230			40°C
		AC230/400	3	5	
3P	50, 63	AC230/400	3		

## THQP-2P Miniature Circuit Breaker

### Applications:

THQ, THC series miniature circuit breaker is characteristic of small size, lightweight, novel structure and excellent performance. They are mounted in the illuminating distribution board and used in guesthouses, block of flats, high buildings, squares, airports, railway stations, plants and enterprises etc, in AC circuits 230V(single pole) up 400V(3pole) 50/60Hz for protection of overload short circuit and for circuit change-over in lighting system. Breaking capacity is 3KA. The items comply with BS & IEC60947 standard.

### Technical parameter:

Pole number	Rated current(A)	Rated voltage(V)	Rated making and breaking capacity(KA)		Setting temperature of protective characteristics
			B.S	NEMA	
1P	6, 10, 15, 20, 30, 40, 50, 63	AC12		5	40°C
		AC120/230		5	
		AC230/400	3		
2P	6, 10, 15, 20, 30, 40	AC120/230			40°C
		AC230/400	3	5	
3P	50, 63	AC230/400	3		





www.mebamfg.com

## Miniature Circuit Breaker

### RDB1-10A Overload Protector TUV Approval

#### Technical parameter:

Rated current	1.0A ~ 10Amp
Rated Voltage	125/250Vac 50Vdc50-60Hz
Breaking capacity	1,000Amp × 125Vac 20Amp × 205Vac
Insulation compression resistance test	1,500Vac/minutes
Reposition switch more load	10times current
The lowest voltage	less 0.25V
Insulation resistance test	more than 500Vdc × 100MΩ

### RDP-5P-10A Circuit Breaker For Equipment

#### Technical parameter:

Type	RDP30	
Rated Voltage	65VDC, 230/400V	
Rated Current(A)	1, 2, 3, 6, 10, 15, 20, 25, 30	
Breaking Capacity	65VDC 2000A; 230/400VAC 1000A; O-CO-O	
Life	Mechanical Life: 10000 times	Electric Life: 6000 times
Ambient Temperature	-40℃ ~ +85℃	
Insulated resistance	100MΩ (500VDC)	
Operation resistance	2000V 1min	
Overload release capacity	Follow	
Auxiliary contact point	230V(AC) 1A	
Connection ways	Inset, Screw or Seal	
Resist vibration	10 ~ 55Hz 10 ~ 28Hz 1.5mm 25 ~ 55Hz 5g	
Pole	1P, 2P, 3P	
Weight	1P 66g, 2P 132g, 3P 198g	

#### RDP30 Over-Current Protection Property:

Current	Character	23 ± 2℃ release time(s)					
Model	Model	In	1.25In	1.5In	2In	6In	10In
AC	62M	Non-release	10-120	3-60	1.2-20	0.02-3	0.01-0.25
DC	52M	Non-release	2-100	1-30	0.5-10	0.02-1	0.04-0.3

# Miniature Circuit Breaker



MEBA ELECTRIC  
ENTERPRISES.

## RDP30-1P Electromagnetic Hydraulic Pressure Circuit Breaker

### Technical parameter:

Type	RDP30	
Rated Voltage	65VDC, 230/400V	
Rated Current(A)	1, 2, 3, 6, 10, 15, 20, 25, 30	
Breaking Capacity	65VDC 2000A; 230/400VAC 1000A; O-CO-O	
Life	MechanicalLife: 10000 times	ElectricLife: 6000 times
Ambient Temperature	-40℃ ~ +85℃	
Insulated resistance	100MΩ(500VDC)	
Operation resistance	2000V 1min	
Overload release capacity	Follow	
Auxiliary contact point	230V(AC) 1A	
Connection ways	Inset, Screw or Seal	
Resist vibration	10 ~ 55Hz 10 ~ 28Hz 1.5mm 25 ~ 55Hz 5g	
Pole	1P, 2P, 3P	
Weight	1P 66g, 2P 132g, 3P 198g	

### RDP30 Over-Current Protection Property:

Current	Character	23 ± 2℃ release time(s)					
Model	Model	In	1.25In	1.5In	2In	6In	10In
AC	62M	Non-release	10-120	3-60	1.2-20	0.02-3	0.01-0.25
DC	52M	Non-release	2-100	1-30	0.5-10	0.02-1	0.04-0.3

## RDP30-2P-10A Circuit Breaker For Equipment

### Technical parameter:

Type	RDP30	
Rated Voltage	65VDC, 230/400V	
Rated Current(A)	1, 2, 3, 6, 10, 15, 20, 25, 30	
Breaking Capacity	65VDC 2000A; 230/400VAC 1000A; O-CO-O	
Life	MechanicalLife: 10000 times	ElectricLife: 6000 times
Ambient Temperature	-40℃ ~ +85℃	
Insulated resistance	100MΩ(500VDC)	
Operation resistance	2000V 1min	
Overload release capacity	Follow	
Auxiliary contact point	230V(AC) 1A	
Connection ways	Inset, Screw or Seal	
Resist vibration	10 ~ 55Hz 10 ~ 28Hz 1.5mm 25 ~ 55Hz 5g	
Pole	1P, 2P, 3P	
Weight	1P 66g, 2P 132g, 3P 198g	

### RDP30 Over-Current Protection Property:

Current	Character	23 ± 2℃ release time(s)					
Model	Model	In	1.25In	1.5In	2In	6In	10In
AC	62M	Non-release	10-120	3-60	1.2-20	0.02-3	0.01-0.25
DC	52M	Non-release	2-100	1-30	0.5-10	0.02-1	0.04-0.3



www.mebamfg.com

## Miniature Circuit Breaker

### RDP30-2P-10A Circuit Breaker For Motor

#### Technical parameter:

Type	RDP30	
Rated Voltage	65VDC, 230/400V	
Rated Current(A)	1, 2, 3, 6, 10, 15, 20, 25, 30	
Breaking Capacity	65VDC 2000A; 230/400VAC 1000A; O-CO-O	
Life	Mechanical Life: 10000 times	Electric Life: 6000 times
Ambient Temperature	-40°C ~ +85°C	
Insulated resistance	100MΩ(500VDC)	
Operation resistance	2000V 1min	
Overload release capacity	Follow	
Auxiliary contact point	230V(AC) 1A	
Connection ways	Inset, Screw or Seal	
Resist vibration	10 ~ 55Hz 10 ~ 28Hz 1.5mm 25 ~ 55Hz 5g	
Pole	1P, 2P, 3P	
Weight	1P 66g, 2P 132g, 3P 198g	

#### RDP30 Over-Current Protection Property:

Current	Character	23 ± 2°C release time(s)					
Model	Model	In	1.25In	1.5In	2In	6In	10In
AC	62M	Non-release	10-120	3-60	1.2-20	0.02-3	0.01-0.25
DC	52M	Non-release	2-100	1-30	0.5-10	0.02-1	0.04-0.3

### RDP30-3P-10A Over Current Circuit Breaker

#### Technical parameter:

Type	RDP30	
Rated Voltage	65VDC, 230/400V	
Rated Current(A)	1, 2, 3, 6, 10, 15, 20, 25, 30	
Breaking Capacity	65VDC 2000A; 230/400VAC 1000A; O-CO-O	
Life	Mechanical Life: 10000 times	Electric Life: 6000 times
Ambient Temperature	-40°C ~ +85°C	
Insulated resistance	100MΩ(500VDC)	
Operation resistance	2000V 1min	
Overload release capacity	Follow	
Auxiliary contact point	230V(AC) 1A	
Connection ways	Inset, Screw or Seal	
Resist vibration	10 ~ 55Hz 10 ~ 28Hz 1.5mm 25 ~ 55Hz 5g	
Pole	1P, 2P, 3P	
Weight	1P 66g, 2P 132g, 3P 198g	

#### RDP30 Over-Current Protection Property:

Current	Character	23 ± 2°C release time(s)					
Model	Model	In	1.25In	1.5In	2In	6In	10In
AC	62M	Non-release	10-120	3-60	1.2-20	0.02-3	0.01-0.25
DC	52M	Non-release	2-100	1-30	0.5-10	0.02-1	0.04-0.3

# Miniature Circuit Breaker



MEBA ELECTRIC  
ENTERPRISES.

## RDP30-3P-10A UL Approval Circuit Breaker

### Technical parameter:

Type	RDP30	
Rated Voltage	65VDC, 230/400V	
Rated Current(A)	1, 2, 3, 6, 10, 15, 20, 25, 30	
Breaking Capacity	65VDC 2000A; 230/400VAC 1000A; O-CO-O	
Life	MechanicalLife: 10000 times	ElectricLife: 6000 times
Ambient Temperature	-40℃ ~ +85℃	
Insulated resistance	100MΩ(500VDC)	
Operation resistance	2000V 1min	
Overload release capacity	Follow	
Auxiliary contact point	230V(AC) 1A	
Connection ways	Inset, Screw or Seal	
Resist vibration	10 ~ 55Hz 10 ~ 28Hz 1.5mm 25 ~ 55Hz 5g	
Pole	1P, 2P, 3P	
Weight	1P 66g, 2P 132g, 3P 198g	

### RDP30 Over-Current Protection Property:

Current	Character	23 ± 2℃ release time(s)					
Model	Model	In	1.25In	1.5In	2In	6In	10In
AC	62M	Non-release	10-120	3-60	1.2-20	0.02-3	0.01-0.25
DC	52M	Non-release	2-100	1-30	0.5-10	0.02-1	0.04-0.3

## RDP30-4P-10A Circuit Breaker

### Technical parameter:

Type	RDP30	
Rated Voltage	65VDC, 230/400V	
Rated Current(A)	1, 2, 3, 6, 10, 15, 20, 25, 30	
Breaking Capacity	65VDC 2000A; 230/400VAC 1000A; O-CO-O	
Life	MechanicalLife: 10000 times	ElectricLife: 6000 times
Ambient Temperature	-40℃ ~ +85℃	
Insulated resistance	100MΩ(500VDC)	
Operation resistance	2000V 1min	
Overload release capacity	Follow	
Auxiliary contact point	230V(AC) 1A	
Connection ways	Inset, Screw or Seal	
Resist vibration	10 ~ 55Hz 10 ~ 28Hz 1.5mm 25 ~ 55Hz 5g	
Pole	1P, 2P, 3P	
Weight	1P 66g, 2P 132g, 3P 198g	

### RDP30 Over-Current Protection Property:

Current	Character	23 ± 2℃ release time(s)					
Model	Model	In	1.25In	1.5In	2In	6In	10In
AC	62M	Non-release	10-120	3-60	1.2-20	0.02-3	0.01-0.25
DC	52M	Non-release	2-100	1-30	0.5-10	0.02-1	0.04-0.3



www.mebamfg.com

## Miniature Circuit Breaker

### RDP30-4P-10A Circuit Breaker For Generator

#### Technical parameter:

Type	RDP30	
Rated Voltage	65VDC, 230/400V	
Rated Current(A)	1, 2, 3, 6, 10, 15, 20, 25, 30	
Breaking Capacity	65VDC 2000A; 230/400VAC 1000A; O-CO-O	
Life	Mechanical Life: 10000 times	Electric Life: 6000 times
Ambient Temperature	-40°C ~ +85°C	
Insulated resistance	100MΩ(500VDC)	
Operation resistance	2000V 1min	
Overload release capacity	Follow	
Auxiliary contact point	230V(AC) 1A	
Connection ways	Inset, Screw or Seal	
Resist vibration	10 ~ 55Hz 10 ~ 28Hz 1.5mm 25 ~ 55Hz 5g	
Pole	1P, 2P, 3P	
Weight	1P 66g, 2P 132g, 3P 198g	

#### RDP30 Over-Current Protection Property:

Current	Character	23 ± 2°C release time(s)					
Model	Model	In	1.25In	1.5In	2In	6In	10In
AC	62M	Non-release	10-120	3-60	1.2-20	0.02-3	0.01-0.25
DC	52M	Non-release	2-100	1-30	0.5-10	0.02-1	0.04-0.3

### RDP30-5P-30A Thermal Circuit Breaker

#### Technical parameter:

Type	RDP30	
Rated Voltage	65VDC, 230/400V	
Rated Current(A)	1, 2, 3, 6, 10, 15, 20, 25, 30	
Breaking Capacity	65VDC 2000A; 230/400VAC 1000A; O-CO-O	
Life	Mechanical Life: 10000 times	Electric Life: 6000 times
Ambient Temperature	-40°C ~ +85°C	
Insulated resistance	100MΩ(500VDC)	
Operation resistance	2000V 1min	
Overload release capacity	Follow	
Auxiliary contact point	230V(AC) 1A	
Connection ways	Inset, Screw or Seal	
Resist vibration	10 ~ 55Hz 10 ~ 28Hz 1.5mm 25 ~ 55Hz 5g	
Pole	1P, 2P, 3P	
Weight	1P 66g, 2P 132g, 3P 198g	

#### RDP30 Over-Current Protection Property:

Current	Character	23 ± 2°C release time(s)					
Model	Model	In	1.25In	1.5In	2In	6In	10In
AC	62M	Non-release	10-120	3-60	1.2-20	0.02-3	0.01-0.25
DC	52M	Non-release	2-100	1-30	0.5-10	0.02-1	0.04-0.3

# Miniature Circuit Breaker



MEBA ELECTRIC  
ENTERPRISES.

## RDP30-6P-10A Circuit Breaker For Gasolin Generator Set

### Technical parameter:

Type	RDP30	
Rated Voltage	65VDC, 230/400V	
Rated Current(A)	1, 2, 3, 6, 10, 15, 20, 25, 30	
Breaking Capacity	65VDC 2000A; 230/400VAC 1000A; O-CO-O	
Life	MechanicalLife: 10000 times	ElectricLife: 6000 times
Ambient Temperature	-40℃ ~ +85℃	
Insulated resistance	100MΩ(500VDC)	
Operation resistance	2000V 1min	
Overload release capacity	Follow	
Auxiliary contact point	230V(AC) 1A	
Connection ways	Inset, Screw or Seal	
Resist vibration	10 ~ 55Hz 10 ~ 28Hz 1.5mm 25 ~ 55Hz 5g	
Pole	1P, 2P, 3P	
Weight	1P 66g, 2P 132g, 3P 198g	

### RDP30 Over-Current Protection Property:

Current	Character	23 ± 2℃ release time(s)					
Model	Model	In	1.25In	1.5In	2In	6In	10In
AC	62M	Non-release	10-120	3-60	1.2-20	0.02-3	0.01-0.25
DC	52M	Non-release	2-100	1-30	0.5-10	0.02-1	0.04-0.3

## RDP30-6P-10A Thermal Magnetic Circuit Breaker

### Technical parameter:

Type	RDP30	
Rated Voltage	65VDC, 230/400V	
Rated Current(A)	1, 2, 3, 6, 10, 15, 20, 25, 30	
Breaking Capacity	65VDC 2000A; 230/400VAC 1000A; O-CO-O	
Life	MechanicalLife: 10000 times	ElectricLife: 6000 times
Ambient Temperature	-40℃ ~ +85℃	
Insulated resistance	100MΩ(500VDC)	
Operation resistance	2000V 1min	
Overload release capacity	Follow	
Auxiliary contact point	230V(AC) 1A	
Connection ways	Inset, Screw or Seal	
Resist vibration	10 ~ 55Hz 10 ~ 28Hz 1.5mm 25 ~ 55Hz 5g	
Pole	1P, 2P, 3P	
Weight	1P 66g, 2P 132g, 3P 198g	

### RDP30 Over-Current Protection Property:

Current	Character	23 ± 2℃ release time(s)					
Model	Model	In	1.25In	1.5In	2In	6In	10In
AC	62M	Non-release	10-120	3-60	1.2-20	0.02-3	0.01-0.25
DC	52M	Non-release	2-100	1-30	0.5-10	0.02-1	0.04-0.3



www.mebamfg.com

## Miniature Circuit Breaker

### RDP50-1P 415V 400HZ Circuit Breaker

#### Technical parameter:

Type	RDP50
Rated Voltage	65VDC, 230/400V
Rated Current(A)	1, 2, 3, 6, 10, 15, 20, 25, 30, 40, 50
Breaking Capacity	65VDC 2000A; 230/400VAC 1000A; O-CO-O
Life	Mechanical Life: 10000 times; Electric Life: 6000 times
Ambient Temperature	-40℃ ~ +85℃
Insulated resistance	100MΩ(500VDC)
Operation resistance	2000V 1min
Overload release capacity	Follow
Auxiliary contact point	230V(AC) 1A
Connection ways	Screw
Resist vibration	10 ~ 55Hz 10 ~ 28Hz 1.5mm 25 ~ 55Hz 5g
Pole	1P, 2P, 3P
Weight	1P 95g, 2P 190g, 3P 285g

#### RDP50 Over-Current Protection Property:

Current	Character	23 ± 2℃ release time(s)					
Model	Model	Pole	In	1.5In	2In	6In	10In
AC	62M	Single	Non-release	5-60	1.8-20	0.04-0.5	0.01-0.1
		Two	Non-release	7-30	3.6-10	0.18-0.7	
DC	52M	Single	Non-release	3-43	0.8-13	0.02-1	0.04-0.19
		Two	Non-release	5.5-22	2.6-7.7	0.14-0.48	0.01-0.03

### RDP50-2P-23A Motor Protection Circuit Breaker

#### Technical parameter:

Type	RDP50
Rated Voltage	65VDC, 230/400V
Rated Current(A)	1, 2, 3, 6, 10, 15, 20, 25, 30, 40, 50
Breaking Capacity	65VDC 2000A; 230/400VAC 1000A; O-CO-O
Life	Mechanical Life: 10000 times; Electric Life: 6000 times
Ambient Temperature	-40℃ ~ +85℃
Insulated resistance	100MΩ(500VDC)
Operation resistance	2000V 1min
Overload release capacity	Follow
Auxiliary contact point	230V(AC) 1A
Connection ways	Screw
Resist vibration	10 ~ 55Hz 10 ~ 28Hz 1.5mm 25 ~ 55Hz 5g
Pole	1P, 2P, 3P
Weight	1P 95g, 2P 190g, 3P 285g

#### RDP50 Over-Current Protection Property:

Current	Character	23 ± 2℃ release time(s)					
Model	Model	Pole	In	1.5In	2In	6In	10In
AC	62M	Single	Non-release	5-60	1.8-20	0.04-0.5	0.01-0.1
		Two	Non-release	7-30	3.6-10	0.18-0.7	
DC	52M	Single	Non-release	3-43	0.8-13	0.02-1	0.04-0.19
		Two	Non-release	5.5-22	2.6-7.7	0.14-0.48	0.01-0.03



# Miniature Circuit Breaker



MEBA ELECTRIC  
ENTERPRISES.

## RDP50-2P-30A Motor Protector

### Technical parameter:

Type	RDP50
Rated Voltage	65VDC, 230/400V
Rated Current(A)	1, 2, 3, 6, 10, 15, 20, 25, 30, 40, 50
Breaking Capacity	65VDC 2000A; 230/400VAC 1000A; O-CO-O
Life	Mechanical Life: 10000 times; Electric Life: 6000 times
Ambient Temperature	-40°C ~ +85°C
Insulated resistance	100MΩ(500VDC)
Operation resistance	2000V 1min
Overload release capacity	Follow
Auxiliary contact point	230V(AC) 1A
Connection ways	Screw
Resist vibration	10 ~ 55Hz 10 ~ 28Hz 1.5mm 25 ~ 55Hz 5g
Pole	1P, 2P, 3P
Weight	1P 95g, 2P 190g, 3P 285g

### RDP50 Over-Current Protection Property:

Current	Character	23 ± 2°C release time(s)					
Model	Model	Pole	In	1.5In	2In	6In	10In
AC	62M	Single	Non-release	5-60	1.8-20	0.04-0.5	0.01-0.1
		Two	Non-release	7-30	3.6-10	0.18-0.7	
DC	52M	Single	Non-release	3-43	0.8-13	0.02-1	0.04-0.19
		Two	Non-release	5.5-22	2.6-7.7	0.14-0.48	0.01-0.03

## RDP50-3P-23A Circuit Breaker

### Technical parameter:

Type	RDP50
Rated Voltage	65VDC, 230/400V
Rated Current(A)	1, 2, 3, 6, 10, 15, 20, 25, 30, 40, 50
Breaking Capacity	65VDC 2000A; 230/400VAC 1000A; O-CO-O
Life	Mechanical Life: 10000 times; Electric Life: 6000 times
Ambient Temperature	-40°C ~ +85°C
Insulated resistance	100MΩ(500VDC)
Operation resistance	2000V 1min
Overload release capacity	Follow
Auxiliary contact point	230V(AC) 1A
Connection ways	Screw
Resist vibration	10 ~ 55Hz 10 ~ 28Hz 1.5mm 25 ~ 55Hz 5g
Pole	1P, 2P, 3P
Weight	1P 95g, 2P 190g, 3P 285g

### RDP50 Over-Current Protection Property:

Current	Character	23 ± 2°C release time(s)					
Model	Model	Pole	In	1.5In	2In	6In	10In
AC	62M	Single	Non-release	5-60	1.8-20	0.04-0.5	0.01-0.1
		Two	Non-release	7-30	3.6-10	0.18-0.7	
DC	52M	Single	Non-release	3-43	0.8-13	0.02-1	0.04-0.19
		Two	Non-release	5.5-22	2.6-7.7	0.14-0.48	0.01-0.03





www.mebamfg.com

## Miniature Circuit Breaker

### RDP50-4P-23A Miniature Circuit Breaker

#### Technical parameter:

Type	RDP50
Rated Voltage	65VDC, 230/400V
Rated Current(A)	1, 2, 3, 6, 10, 15, 20, 25, 30, 40, 50
Breaking Capacity	65VDC 2000A; 230/400VAC 1000A; O-CO-O
Life	Mechanical Life: 10000 times; Electric Life: 6000 times
Ambient Temperature	-40℃ ~ +85℃
Insulated resistance	100MΩ(500VDC)
Operation resistance	2000V 1min
Overload release capacity	Follow
Auxiliary contact point	230V(AC) 1A
Connection ways	Screw
Resist vibration	10 ~ 55Hz 10 ~ 28Hz 1.5mm 25 ~ 55Hz 5g
Pole	1P, 2P, 3P
Weight	1P 95g, 2P 190g, 3P 285g

#### RDP50 Over-Current Protection Property:

Current	Character	23 ± 2℃ release time(s)					
Model	Model	Pole	In	1.5In	2In	6In	10In
AC	62M	Single	Non-release	5-60	1.8-20	0.04-0.5	0.01-0.1
		Two	Non-release	7-30	3.6-10	0.18-0.7	
DC	52M	Single	Non-release	3-43	0.8-13	0.02-1	0.04-0.19
		Two	Non-release	5.5-22	2.6-7.7	0.14-0.48	0.01-0.03

### RDP50-5P-23A Gasolin Generator Protector

#### Technical parameter:

Type	RDP50
Rated Voltage	65VDC, 230/400V
Rated Current(A)	1, 2, 3, 6, 10, 15, 20, 25, 30, 40, 50
Breaking Capacity	65VDC 2000A; 230/400VAC 1000A; O-CO-O
Life	Mechanical Life: 10000 times; Electric Life: 6000 times
Ambient Temperature	-40℃ ~ +85℃
Insulated resistance	100MΩ(500VDC)
Operation resistance	2000V 1min
Overload release capacity	Follow
Auxiliary contact point	230V(AC) 1A
Connection ways	Screw
Resist vibration	10 ~ 55Hz 10 ~ 28Hz 1.5mm 25 ~ 55Hz 5g
Pole	1P, 2P, 3P
Weight	1P 95g, 2P 190g, 3P 285g

#### RDP50 Over-Current Protection Property:

Current	Character	23 ± 2℃ release time(s)					
Model	Model	Pole	In	1.5In	2In	6In	10In
AC	62M	Single	Non-release	5-60	1.8-20	0.04-0.5	0.01-0.1
		Two	Non-release	7-30	3.6-10	0.18-0.7	
DC	52M	Single	Non-release	3-43	0.8-13	0.02-1	0.04-0.19
		Two	Non-release	5.5-22	2.6-7.7	0.14-0.48	0.01-0.03

# Miniature Circuit Breaker



RDP50-6P-23A



THQC

MEBA ELECTRIC  
ENTERPRISES.

## RDP50-6P-23A Generator Protector

### Technical parameter:

Type	RDP50
Rated Voltage	65VDC, 230/400V
Rated Current(A)	1, 2, 3, 6, 10, 15, 20, 25, 30, 40, 50
Breaking Capacity	65VDC 2000A; 230/400VAC 1000A; O-CO-O
Life	Mechanical Life: 10000times; Electric Life: 6000 times
Ambient Temperature	-40℃ ~ +85℃
Insulated resistance	100MΩ(500VDC)
Operation resistance	2000V 1min
Overload release capacity	Follow
Auxiliary contact point	230V(AC) 1A
Connection ways	Screw
Resist vibration	10 ~ 55Hz 10 ~ 28Hz 1.5mm 25 ~ 55Hz 5g
Pole	1P, 2P, 3P
Weight	1P 95g, 2P 190g, 3P 285g

### RDP50 Over-Current Protection Property:

Current	Character	23 ± 2℃ release time(s)					
Model	Model	Pole	In	1.5In	2In	6In	10In
AC	62M	Single	Non-release	5-60	1.8-20	0.04-0.5	0.01-0.1
		Two	Non-release	7-30	3.6-10	0.18-0.7	
DC	52M	Single	Non-release	3-43	0.8-13	0.02-1	0.04-0.19
		Two	Non-release	5.5-22	2.6-7.7	0.14-0.48	0.01-0.03

## THQC Miniature Circuit Breaker

### Applications:

THQ, THC series miniature circuit breaker is characteristic of small size, lightweight, novel structure and excellent performance. They are mounted in the illuminating distribution board and used in guesthouses, block of flats, high buildings, squares, airports, railway stations, plants and enterprises etc, in AC circuits 230V(single pole) up 400V(3pole) 50/60Hz for protection of overload short circuit and for circuit change-over in lighting system. Breaking capacity is 3KA. The items comply with BS & IEC60947 standard.

### Technical parameter:

Pole number	Rated current(A)	Rated voltage(V)	Rated making and breaking capacity(KA)		Setting temperature of protective characteristics
			B.S	NEMA	
1P	6, 10, 15, 20, 30, 40, 50, 63	AC12		5	40℃
		AC120/230		5	
		AC230/400	3		
2P	6, 10, 15, 20, 30, 40	AC120/230			40℃
		AC230/400	3	5	
3P	50, 63	AC230/400	3		